



101K User Guide

101K User Guide Contents

Introduction

Introduction.....	3
-------------------	---

Getting Started

Package Contents.....	6
Parts & Functions.....	6
USIM Card Installation.....	7
SD Card Installation.....	9
Battery Installation.....	12
Charging Battery.....	14
Water Resistance.....	15
Power On/Off.....	16
Touchscreen Operations.....	16

Basic Operations

Basic Operations.....	20
Handset Phone Number.....	21
Mobile Manners.....	21
Text Entry.....	22
Google Account.....	23
Android Market™.....	24
Security Codes.....	26
USIM PIN.....	26
Activating Screen Lock.....	27
Software Updates.....	28

Handset Interface

Home Screen Basics.....	30
Status Bar.....	30
Notifications Window.....	31

Phone

Calling.....	34
Optional Services.....	35
Address Book.....	38

Messaging & Browser

Messaging.....	40
Sending SoftBank Mail.....	40
Creating/Sending Gmail.....	42
Internet Mail Settings.....	43
Web Browsing.....	43

Camera

Imaging.....	46
--------------	----

Music & Images

Music Files.....	50
Image Files.....	50

Connectivity

Wi-Fi.....	52
Bluetooth®.....	53

Global Services

Calling Outside Japan.....	56
----------------------------	----

Settings

Profile.....	58
Wireless & Networks.....	58
Call.....	60
Sound.....	61
Applications.....	62
Accounts & Sync.....	63
Privacy.....	64
Language & Keyboard.....	64
Date & Time.....	65
About Phone.....	66

Appendix

Specifications.....	70
Materials.....	70
Customer Service.....	71

Safety Precautions

Safety Precautions.....	74
General Notes.....	82
Water & Dust Resistance.....	87

Introduction

Thank you for purchasing SoftBank 101K.

Before You Begin

- SoftBank 101K is referred to as "handset" in this guide.
- Read "Safety Precautions" and this guide thoroughly beforehand for proper usage.
- Accessible services may be limited by contract conditions or service area.
- Unauthorized copying of any part of this guide is prohibited.
- Guide content subject to change without prior notice.
- Contact SoftBank Customer Support, General Information if you find inaccuracies.

Guide Usage Notes

- Most operation descriptions are based on default settings.
- Unless noted otherwise, descriptions are for Home Screen.
- Some operation descriptions may be omitted.
- In this guide and on handset, "abroad" means "outside Japan" with regard to handset/service usage.
- In this guide, microSD/microSDHC Card is referred to as "SD Card."

Screenshots & Key Labels

Screenshots and Key labels are provided for reference only. Actual handset windows, menus, etc. may differ in appearance.

Accessing Guide on Handset

Access this Guide on handset via Guide icon in Home Screen or via Guide indicator on Status Bar. Guide indicator appears on Status Bar by default. Follow these steps to hide Guide indicator:

Access Guide →  → Indicator →  off

Getting Started

- Package Contents..... 6
- Parts & Functions..... 6
- USIM Card Installation..... 7
- SD Card Installation..... 9
- Battery Installation..... 12
- Charging Battery..... 14
- Water Resistance..... 15
- Power On/Off..... 16
- Touchscreen Operations..... 16

Package Contents

Package Contents

- Handset (SoftBank 101K)
- Battery (KYBAA1)
- AC Charger (KYCAA1)
- 2 GB microSD Card (Complimentary Sample)
- クイックスタート (Japanese)
- お問い合わせ (Japanese)
- Warranty (Japanese)

Parts & Functions

Front/Top/Bottom

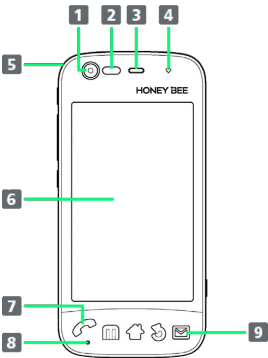

Part	Description
1 Front Camera	Capture your own image
2 Light/ Proximity Sensor	Detects surrounding brightness/prevents Touchscreen misoperation during call
3 Receiver	Other party sounds from here
4 Call/ Charging LED	Lights/flashes to indicate handset status
5 Strap Hole	Attach Strap here
6 Touchscreen Display	Tap, Swipe/Flick, etc.
7 Notification Key Illumination (missed call)	Flashes to indicate a missed call ¹
8 Mic	Speak here
9 Notification Key Illumination (new mail)	Flashes to indicate new mail ¹

1 Only when Display Backlight is lit

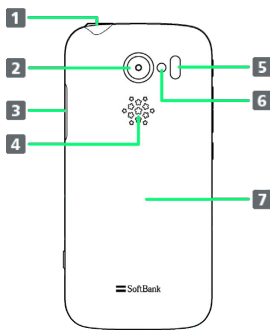

Part	Description
1 3.5 mm Audio Port	Connect headset
2 Camera	Capture images
3 External Device Port	Connect Micro USB Cable (sold separately)
4 Speaker	Ringer and Speakerphone sound from here
5 Infrared Port	Use to transmit data
6 Light	Use as camera flash/flashlight
7 Battery Cover	Access SD/USIM Card or battery

Handset Keys

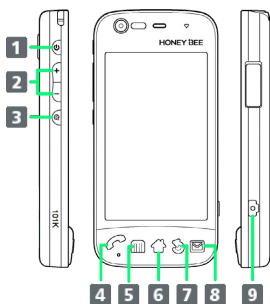

Part	Description
1	Toggle Display Backlight on/off Long Press for power on/off
2	Adjust Volume
3	Open registered application Long Press for Light
4	Open Phone/Open Received Calls if call missed Long Press for Address Book
5	Show Menu options
6	Return to Home Screen Long Press for recent applications
7	Go back/Escape
8	Open S! Mail/Open any new mail Long Press to create S! Mail
9	Long Press to open Camera Press as shutter for photo/video

USIM Card Installation

USIM Card IC chip contains customer and authentication information, including handset number.

Inserting USIM Card

1

Remove Battery Cover



· Use notch to lift Cover.

2

Remove battery

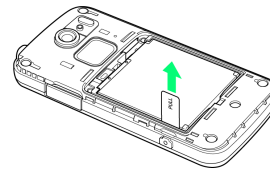

· Pull tab to remove battery.

3

Insert USIM Card

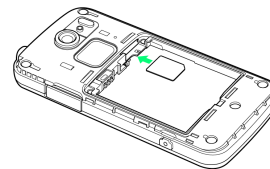

· Insert with IC chip down and notch located as shown.
· Insert in correct place (bottom slot).

4

Insert battery

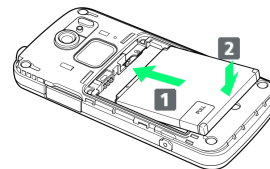

· Slide battery into place as shown.

5

Close Battery Cover

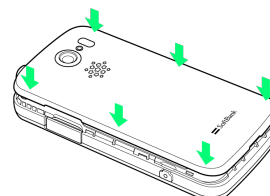

6

Press along edges/middle firmly to secure

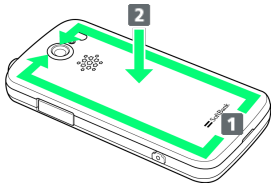

Removing USIM Card

1

Remove Battery Cover



· Use notch to lift Cover.

2

Remove battery

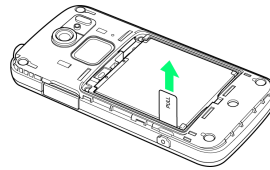

· Pull tab to remove battery.

3

Remove USIM Card

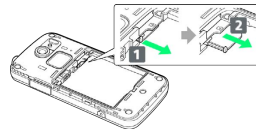

- Pull USIM Card out by tab.
- Push tab back in after removing USIM Card.

4

Insert battery

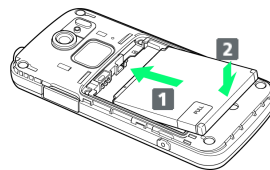

· Slide battery into place as shown.

5

Close Battery Cover

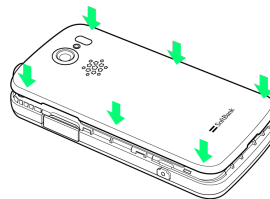

6

Press along edges/middle firmly to secure

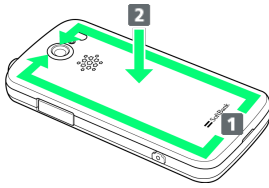

SD Card Installation

Handset accepts microSDHC/microSD Card up to 32 GB. Some SD Cards may not operate properly.

Inserting SD Card

Always power off first.

1

Remove Battery Cover



· Use notch to lift Cover.

2

Remove battery

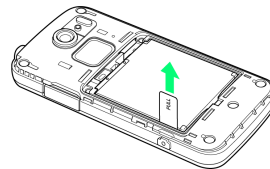

· Pull tab to remove battery.

3

Insert SD Card

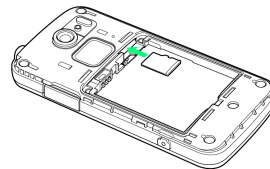

· Insert all the way with terminals down.
· Insert in correct place (top slot).
· Do not insert other objects.

4

Insert battery

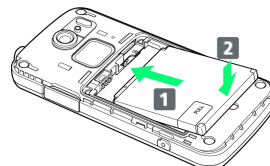

· Slide battery into place as shown.

5

Close Battery Cover

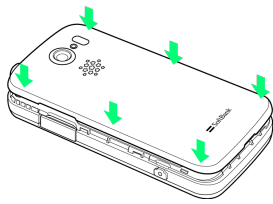
**6**

Press along edges/middle firmly to secure

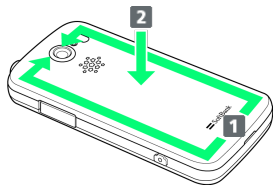

Removing SD Card

Always perform Unmount SD Card, then power off first.

1

Remove Battery Cover



- Use notch to lift Cover.

2

Remove battery

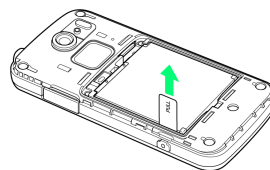

- Pull tab to remove battery.

3

Remove SD Card



- Push in and release SD Card, then pull it out.

4

Insert battery

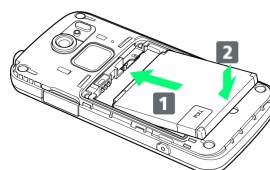

- Slide battery into place as shown.

5

Close Battery Cover

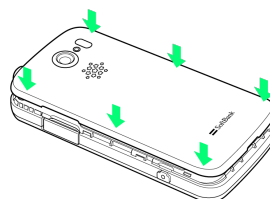

6

Press along edges/middle firmly to secure

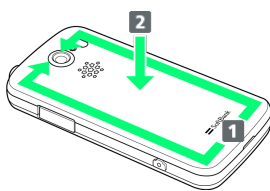

Formatting SD Card

When using a new SD Card for the first time, format it on handset before trying to save files, etc.

- Format Card deletes all SD Card files, even those created on other devices.
- Charge battery or install a charged battery beforehand.

1

In Home Screen,   Settings

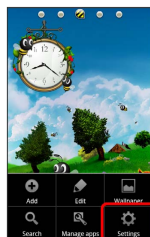

2

Storage

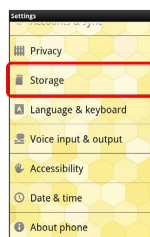

3

Delete microSD

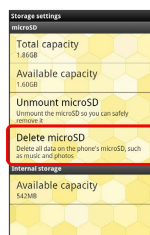

4

Erase microSD



5

Erase everything

 Handset erases all SD Card files.

! Important SD Card Usage Notes

Back Up Your Files

SoftBank Mobile is not liable for any damages resulting from accidental loss/alteration of information. Keep a copy of contacts, etc. in a separate place.

Never power off or remove battery while files are being accessed.

Low Battery Warning

SD Card may not read/write files correctly if battery is low.

Battery Installation

Always power off before removing battery.

Inserting Battery

1

Remove Battery Cover



· Use notch to lift Cover.

2

Insert battery

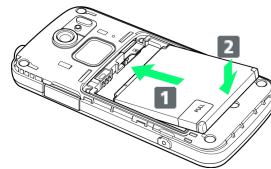

· Slide battery into place as shown.

3

Close Battery Cover

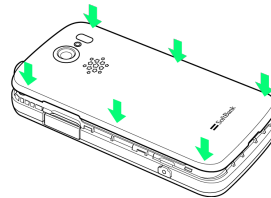

4

Press along edges/middle firmly to secure

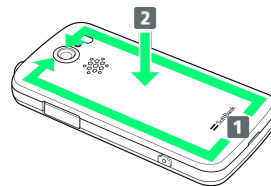

Removing Battery

1

Remove Battery Cover

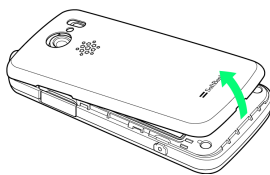

· Use notch to lift Cover.

2

Remove battery

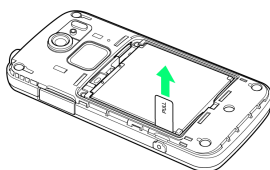

· Pull tab to remove battery.

3

Close Battery Cover

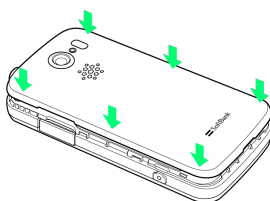

4

Press along edges/middle firmly to secure

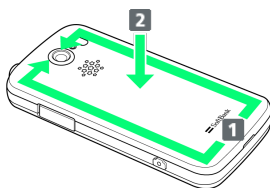

Battery Cautions

Battery Care

Charge battery at least once every six months; uncharged battery may die or affect files/settings.

Bulges

Depending on usage, bulges may appear near end of battery life; this does not affect safety.

Replacing Battery

Replace battery if operating time shortens noticeably.

Cleaning Charging Terminals

Clean device charging terminals with dry cotton swabs.

Lithium-ion Battery

This product requires a lithium-ion battery. To recycle a used lithium-ion battery, take it to any shop displaying the recycling symbol.

Charging Battery

Battery must be inserted in handset to charge it.

Charger

1

Open Port Cover and connect AC Charger

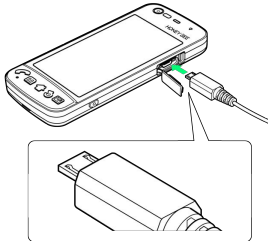

- Grasp Micro USB plug and insert as shown.

2

Plug in Charger

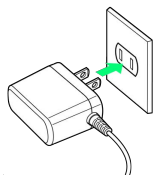

 Lamp lights once charging starts. Lamp remains lit until charging finishes.

3

Disconnect AC Charger after charging

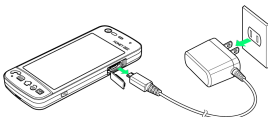

- Unplug from outlet and disconnect handset.

4

Close Port Cover

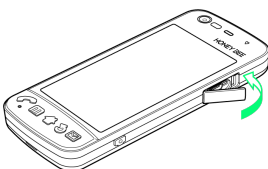

5

Press along Cover to close securely

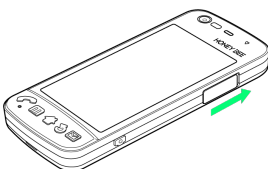

USB Charging

Battery can be charged by Micro USB Cable (sold separately).

- Power on handset and PC first.
- Battery may not charge or charge slowly depending on PC status/environment.

1

Open Port Cover and connect Micro USB Cable

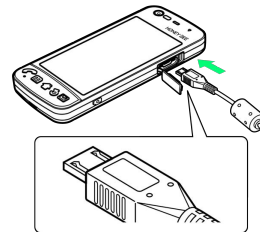

- Grasp Micro USB plug and insert as shown.

2

Connect Micro USB Cable to PC USB port

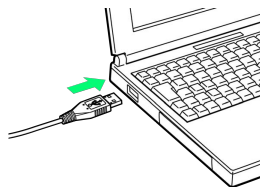

3

Disconnect Micro USB Cable after charging

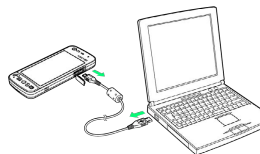

4

Close Port Cover

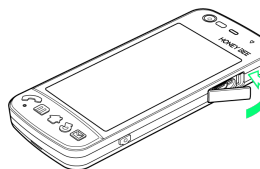

5

Press along Cover to close securely.

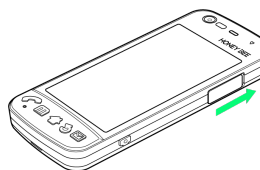

Water Resistance

Handset has a waterproof rating equivalent to IPX5 and IPX7 (with External Device Port Cover and Battery Cover secured) (by Kyocera testing).

Draining Water

Using a wet handset allows water to collect in Mic, Receiver, Speaker, or Audio Port. This may affect call quality, wet your clothing, carrybag, etc., or allow water into handset. Follow steps below to drain water.

1

Wipe handset with a lint-free clean, dry cloth



2

Shake handset as shown until there is no more wetting

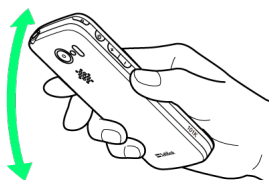

- Confirm it is safe around you to shake handset.
- Hold firmly to prevent handset from flying out of your hand.

3

Press a lint-free clean, dry cloth into gaps (Mic, Receiver, Speaker, etc.) to remove any water



4

After removing as much water as possible, leave handset at room temperature for at least 1 hour



After draining water

Some water may still remain in handset. Do not leave handset beside/in items that you do not want to get wet (clothing, carrybag, etc.).

Power On/Off

Power On

1

 (Long Press)

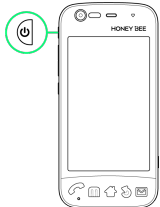

 Home Screen appears.

- Initial setup menu opens before Home Screen appears after powering on for the first time.

Power Off

1

 (Long Press)



2

Power off → OK



 Handset shuts down.

- Handset may power on automatically when connected to a PC via Micro USB Cable (sold separately).

Touchscreen Operations

Touch Display to select menu items, open functions, scroll pages, etc.

Tap

Tap item or key to open or execute corresponding function/operation.



Touch & Hold

Touch item for 1+ seconds to move icons, open menus, etc.

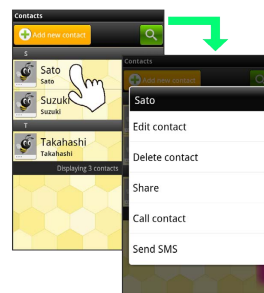

Drag

Drag item (e.g., Touchscreen unlock slider) to move it.



Swipe/Flick

Swipe/Flick to toggle sheets, pages, etc.

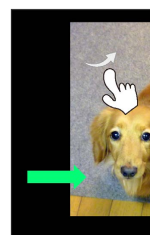

Pinch/Spread

Pinch/Spread to zoom in or out on images, etc.

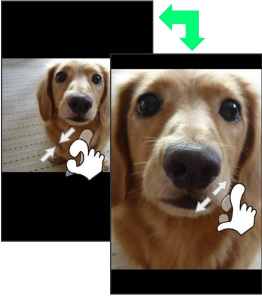

Basic Operations

Basic Operations.....	20
Handset Phone Number.....	21
Mobile Manners.....	21
Text Entry.....	22
Google Account.....	23
Android Market™.....	24
Security Codes.....	26
USIM PIN.....	26
Activating Screen Lock.....	27
Software Updates.....	28

Basic Operations

Home Screen & Launcher

Home Screen top sheet appears at power on. Most handset operations start from Home Screen sheets or Launcher pages.



Handset Navigation

Tap menu items, icons, onscreen key, etc. to open assigned items.

- Press to go back or escape.

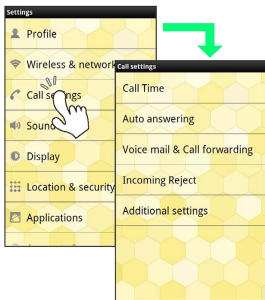

Menu Operations

Press for options. Alternatively, Touch & Hold Display for settings.

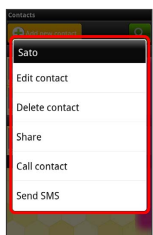
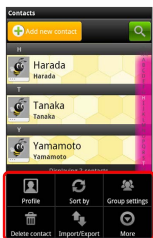

Handset Settings

In Home Screen, Press then Tap **Settings** to customize settings.

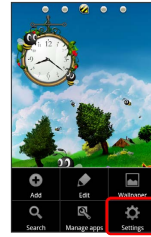

Handset & Display Orientation

In most cases, Display orientation changes with handset orientation.

- Some application content may not change with handset orientation.

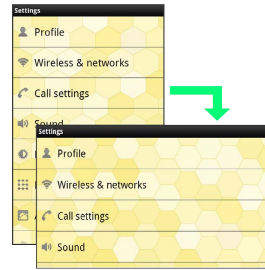

Handset Phone Number

My Phone Number

1

In Home Screen,   Settings



2



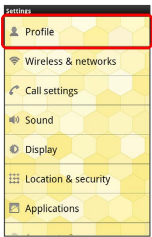

Profile







 Profile window appears.

+ Profile Operations

Sharing Profile

In Profile window,   Share  Select application
 Follow onscreen instructions

Editing Profile

In Profile window,   Edit contact  Edit items
 Done

Mobile Manners

Silent Mode

Cancel most handset sounds to avoid disturbing others around you.

- Camera shutter sounds (photos, video record start/stop) even in Silent mode.

1

 (Long Press)



2

Silent mode

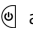

 Silent mode is set.

- When Silent mode is set, Long Press  again to cancel it.

Airplane Mode

Disable all functions that emit radio waves while handset power is on.

1

(Long Press)



2

Airplane mode



Airplane mode is set.

· When Airplane mode is set, Long Press again to cancel it.

Text Entry

Keyboards

Use onscreen keyboards for text entry. In 10-Key Keyboard, multiple characters are assigned to each key. In QWERTY Keyboard, single characters are assigned to each key.

- In 10-Key Keyboard, Tap then 10-key QWERTY . for QWERTY Keyboard.
- In QWERTY Keyboard, Touch & Hold then 10-key QWERTY for 10-Key Keyboard.



QWERTY Keyboard Layout

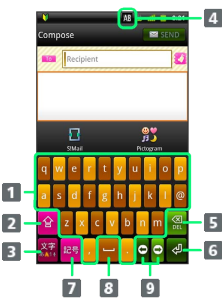

- 1 Text Entry

2 Toggle uppercase/lowercase or symbols

3 Toggle entry modes; Touch & Hold for entry mode list

4 Current character type

5 Delete character before cursor

6 Line feed

7 Emoji*/Symbol/Emoticon List

8 Space

9 Move cursor

· *Applications that support Emoji

Toggling Text Entry Modes

1

Touch & Hold 

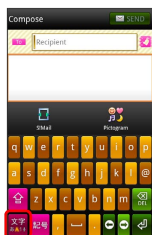

In 10-Key Keyboard, Tap .

2

Input Mode  Tap Input mode

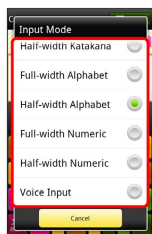

 Input mode changes.

Google Account

Create a Google Account to use Google services. Some services cannot be used and some applications/functions are limited without a Google Account.

Creating a Google Account

1

In Home Screen,   Settings

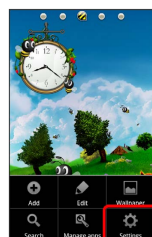

2

Accounts & sync

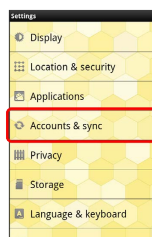

3

Add account

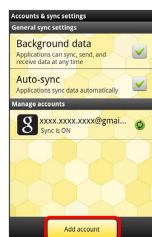

4

Google

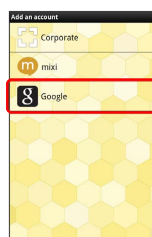

 Add a Google Account appears.

5

Follow onscreen instructions.



Google Account is added.

Signing in to a Google Account

If an application requires a Google Account, Google sign in appears. Sign in to use the application.

1

Next

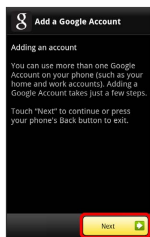

2

Sign in

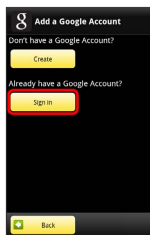

Google Account sign in appears.

3

Follow onscreen instructions.



You are signed in to your Google Account.

Android Market™

Get applications in Android Market. Sign in to your Google Account beforehand.

Installing Free Applications

1

In Home Screen, (Market)



Market opens.

• If confirmation appears, follow onscreen instructions.

2

Tap application Download Accept & download



Application downloads and installs.

Purchasing Applications

1

In Home Screen, (Market)



Market opens.

• If confirmation appears, follow onscreen instructions.

2

Tap paid application Select price Accept & buy

Follow onscreen instructions



Application downloads and installs.

Updating Installed Applications

1





In Home Screen,    (Market)



 Market opens.

- If confirmation appears, follow onscreen instructions.

2

  My Apps  Tap application  Update 
Accept & download

 Application downloads and installs.

- If confirmation appears, follow onscreen instructions.

Purchased Applications

Payments

Pay once. Re-downloads of uninstalled applications are complimentary.





Installations on Other Android Devices

Install same application on other Android devices under same Google Account at no added cost.





Application Operations

Requesting Refunds

Refunds are possible within a limited time. Requesting a refund deletes the application and cancels the invoice. Request one refund per application.

In Market,   My Apps  Tap application 
Refund

Automatic Application Updates

In Market,   My Apps  Tap application 
Allow automatic updating ()

Android Market Caution

Installing Applications

Download and install applications on this handset via Android Market (developed by Google Inc.) at your own risk. SoftBank Mobile is not responsible for user installed application content (quality, reliability, legality, appropriateness, accuracy, etc.) or malfunctions installed applications may cause (due to viruses, etc.).

Purchasing Applications

Purchase applications via Android Market at your own risk. SoftBank Mobile is not responsible for transactions between users and third party publishers.

Security Codes

Code Types

- Some functions/services require these codes for use.
- Do not reveal Security Codes. SoftBank Mobile is not liable for misuse or damages.
 - If you forget Security Codes, contact us for recovery. For more information, see [SoftBank Mobile Website \(http://mb.softbank.jp/en/\)](http://mb.softbank.jp/en/).

Types	Details
PIN (Lock No.)	User settable: Use/change some handset functions/ settings 9999 by default: Use Security Lock functions
Center Access Code	4-digit code in contract: Change services; use Optional Services via landlines; or set call restrictions

USIM PIN

A four-to-eight-digit code to prevent unauthorized use. It is set to 9999 by default.

Enabling USIM Card Lock

1

In Home Screen,   Settings



2

Location & security

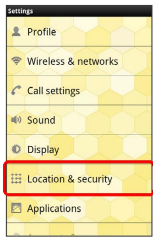

3

Set up USIM card lock  Lock USIM card () 

Enter USIM PIN  OK

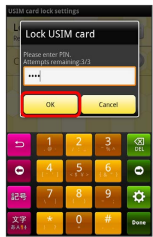

 PIN is enabled.

Changing USIM PIN

1

In Home Screen,   Settings

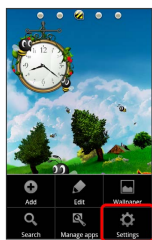





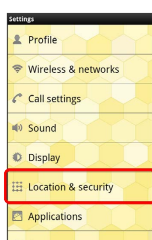

2

Location & security



3

Set up USIM card lock  Change USIM PIN  Enter PIN
 OK  Enter New PIN  OK  Enter New PIN
 again  OK

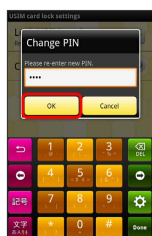

 PIN is changed.

! PIN Cautions

Entering PIN incorrectly three times activates PIN Lock. Enter PUK (Personal Unblocking Key) to unlock. For more about PUK, contact [SoftBank Customer Support](#).

Activating Screen Lock

After set period of inactivity, Screen Lock activates. Press  for Screen Lock window.

Canceling Screen Lock

1

When Screen Lock is active, Press 



 Screen Lock window appears.

· Alternatively, Press .

2

Flick 

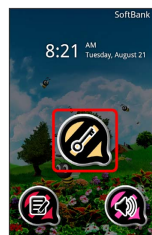

 Screen Lock is canceled.

Software Updates

Look for available updates. Update as required.

Software Updates

1

In Home Screen,   Settings



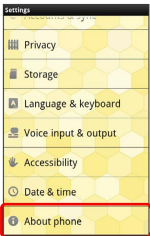

2

About phone



3

Software update  Start updating software  Follow onscreen instructions

 Software updates.

Before Software Update

Handset data may be lost to damage or malfunction, etc. Always back up important files. Back up important information before Software Update. SoftBank Mobile is not liable for loss or associated damages.

Software Update Cautions

Handset cannot be used until Software Update completes; it may take some time to complete.
Confirm signal strength and battery charge beforehand.
Poor signal strength or low battery may disrupt updates leading to lost data or handset malfunction.

Handset Interface

Home Screen Basics.....	30
Status Bar.....	30
Notifications Window.....	31

Home Screen Basics

Home Screen top sheet appears at power on; most operations start here.



Layout



- 1 Status Bar & Notifications Window
- 2 Shortcuts

Toggling Home Screen Sheets

Home Screen consists of 5 sheets. Add shortcuts, widgets or folders to sheets. Swipe or Flick left/right to toggle Home Screen sheets.

- Alternatively, Tap a  to toggle other sheets.
- In any Home Screen sheet, Press  to return to Home Screen top sheet.
- In Home Screen, Press  and Tap **Edit** to add, delete, etc. sheets.

Status Bar

Status Bar appears at the top of Display.



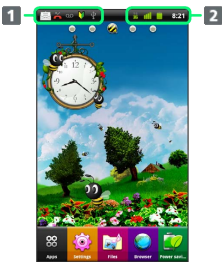









Status Bar



- 1 Notification Indicators
- 2 Status Indicators

Notification Indicators



















These Notification Indicators appear in Notifications Window:

Icon	Description
	Functions Guide (Drag Status Bar down and open from Notifications Window)
	New Gmail
	New PC Mail
	New SMS/SI Mail
	New Voicemail
	USB Connected
	Call in Progress
	Missed Call
	Call On Hold
	Call Forwarded
	Snoozing/Unchecked Alarm
	Emergency Earthquake Alert

- Other Notification Indicators also appear depending on the application.

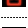
Status Indicators

These Status Indicators appear in Status Bar:

Indicator	Description
	Auto Answering Set
	Data Syncing
	Obtaining Location
	Bluetooth® On
	Bluetooth® Connected
	Silent Mode Active
	3G Data in Use
	GSM Data in Use
	HSPA Data in Use
	Wi-Fi Connected
	Signal Strength
	Roaming
	No Signal
	Airplane Mode
	Charge Battery
	Battery Low
	Battery Charged
	Battery Charging
	Alarm Set

• Other Status Indicators also appear depending on the application.

Notifications Window

Open notifications (missed call, etc.), check handset status or change various settings.

Opening Notifications Window

1

In Home Screen, Tap Status Bar



 Notifications Window opens.

Closing Notifications Window

Touch Display bottom and Drag up to close Notifications Window.

• Alternatively, Press  to close Notifications Window.

Phone

Calling.....	34
Optional Services.....	35
Address Book.....	38

Calling

Learn calling basics, including handling incoming calls, and in-call operations.

Placing Calls

1

  Dialpad



 Onscreen dialpad appears.

2

Use onscreen dialpad to enter number.



· Enter city code for landlines.

3



 Ringback tone sounds. Wait for receiver to accept call.

4

To end the call 



 Call ends.

Answering Calls

1

When call connects Drag  right

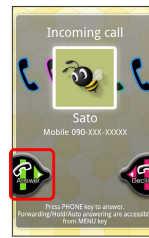

 Talk

2

To end the call 



 Call ends.

Emergency Location Report

Using SoftBank 3G handset for emergency calls (110, 119 or 118) automatically reports handset location to corresponding agency (police, etc.)

- Location Report does not incur registration/transmission fees.
- Location/signal conditions affect positioning accuracy. Always provide location and call purpose.
- Hiding Caller ID (using 184, etc.) cancels Location Report. However, corresponding agency may obtain location information in life threatening situations.
- Location Report is not sent for calls made while outside Japan.

Emergency Location Report Cautions

Emergency Location Report is not sent in Airplane mode.

Optional Services

This handset is compatible with SoftBank Optional Services.

Optional Services

Use these SoftBank Optional Services:

Service	Description
Call Forwarding	Divert all/all unanswered calls to a preset number
Voicemail	Divert all/unanswered calls to Voicemail Center; access messages via handset/touchtone phones
Call Waiting ¹	Answer calls or open another line during a call
Group Calling ¹	Switch between open lines/connect multiple lines
Caller ID	Show or hide your number when placing calls

1 Requires separate subscription

Call Forwarding

1

In Home Screen,   Settings

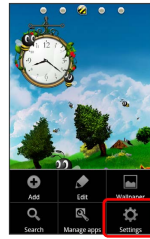

2

Call settings

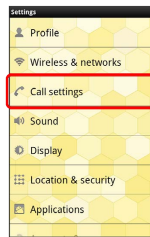

 Call settings appears.

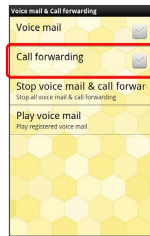

3

Voice mail & Call forwarding  Call forwarding



• Call Forwarding and Voicemail cannot be set at the same time. Tap **Voice mail** to cancel Voicemail when set.

4

Immediately / After certain seconds  Enter number 
Settings

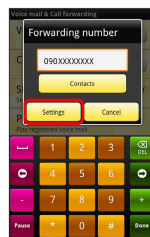

 Call Forwarding is set.

• Tap **After certain seconds** to set the ring time.

Vicemail

1

In Home Screen,   Settings



2

Call settings

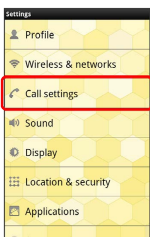

 Call settings appears.

3

Voice mail & Call forwarding  Voice mail

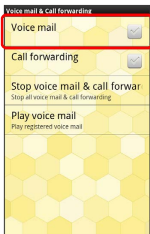



· Voicemail and Call Forwarding cannot be set at the same time. Tap **Call forwarding** to cancel Call Forwarding when set.

4

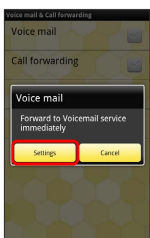
Immediately / After certain seconds  Settings



 Voicemail is set.

- Tap **After certain seconds** to set the ring time.
- When a new message is recorded  appears in Status Bar. Dial 1416 for voice guidance.

Call Waiting

Requires separate subscription.

1

In Home Screen,   Settings

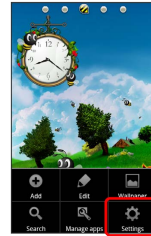

2

Call settings

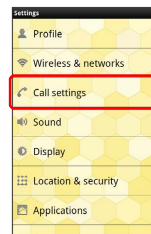

 Call settings appears.

3

Additional settings

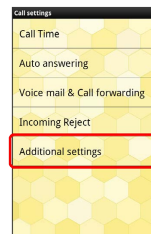

4

Call waiting ()

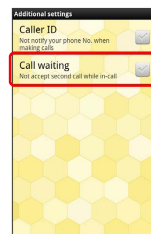

 Call Waiting is set.

- Call Waiting tone sounds. Slide  right to accept the call.

Group Calling

Requires separate subscription.

1

During a call, **Add call**

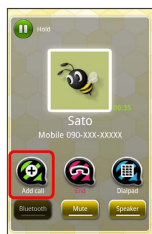

2

Enter another phone number →



3

When receiver accepts call **Merge calls**

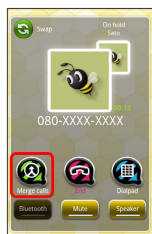

Group Call begins.

Caller ID

1

In Home Screen, → **Settings**

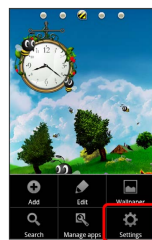

2

Call settings

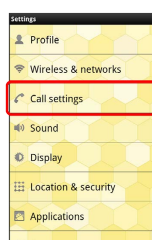

Call settings appears.

3

Additional settings

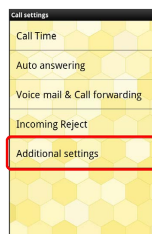

4

Caller ID ()

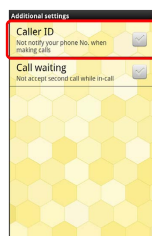

Caller ID is set.

Canceling Call Barring

Handset does not support Call Barring. Use the following procedure to cancel previous Call Barring settings when replacing an old handset.

1

In Home Screen, 



2

Enter "#330 * Center Access Code#"



3



 Call Barring is canceled.

Address Book

Save phone numbers, mail addresses, etc. to Address Book.

Adding New Contacts

1

 (Long Press)





 New Contact window appears.

2

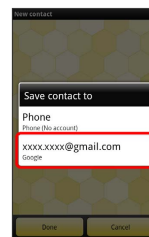
 Tap your Google Account



3

Enter items  

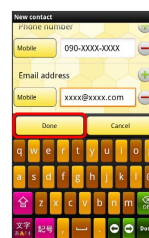

 Contact is saved.

Messaging & Browser

Messaging.....	40
Sending SoftBank Mail.....	40
Creating/Sending Gmail.....	42
Internet Mail Settings.....	43
Web Browsing.....	43

Messaging

S! Mail

Exchange long text messages with S! Mail-compatible SoftBank terminals, other mobile providers' handsets, computers/other email-compatible devices. Attach media files for multimedia messaging.

SMS

Exchange short text messages (up to 140 half pitch characters) using handset phone numbers as addresses.

Gmail

Gmail is Google's webmail service. Handset automatically syncs with Gmail.

Internet Mail

Use Internet Mail (POP3/IMAP4) on handset.

- Set up Internet Mail accounts beforehand.
- Exchanging Internet Mail via handset synchronizes handset and mail server.

Sending SoftBank Mail

Sending S! Mail

1

In Home Screen,    (SoftBank Mail)  S!Mail

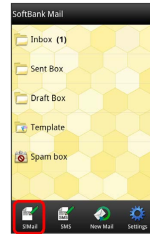

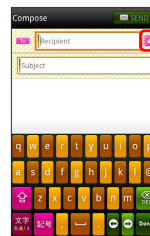

2



3

People / Outgoing History / Incoming History  Select address  OK



- Enter phone numbers directly in Address field.
- After entering addresses, Tap  to change them to Cc or Bcc.
- After entering addresses, Tap  to delete them.

4

Subject  Enter subject

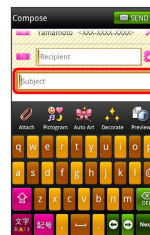

5

Tap Message field → Enter text

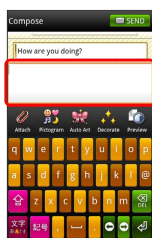

6

SEND

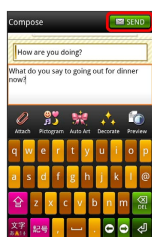

! S! Mail is sent.

- Before sending S! Mail, Press ↶ to go back, or save unsendable message as a draft.

Sending SMS

1

In Home Screen, [App Icon] → [SoftBank Mail] → SMS

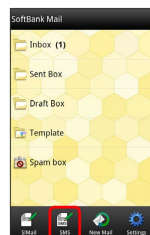

2

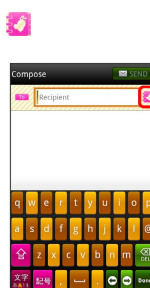

3

People / Outgoing History / Incoming History → Tap destination



- Enter phone numbers directly in Address field.
- After entering addresses, Tap ✕ to delete them.

4

Tap Message field → Enter text

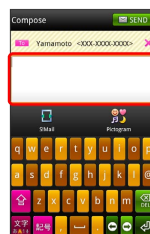

SEND

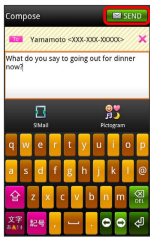

SMS is sent.

- Before sending SMS, Press  to go back, or save unsendable message as a draft.

Creating/Sending Gmail

To use Google Mail, create a Google Account and sign in beforehand.

Creating/Sending Gmail

1

In Home Screen,    (Gmail)

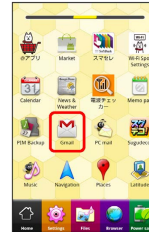

Inbox appears.

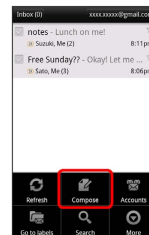

2

 Compose



New message window appears.

3

Enter To, Subject, and message text  

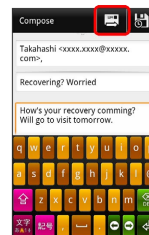

Message is sent.

Gmail Caution

Barring Internet Mail on handset blocks Gmail messages.

Internet Mail Settings

Adding Accounts

1

In Home Screen,    (PC mail)



 Internet Mail list appears.

2

  Accounts

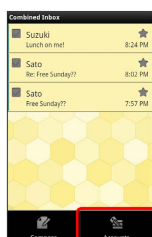

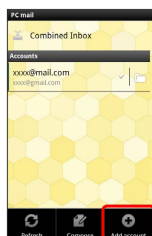

3

  Add account



4

Follow onscreen instructions  Done

 Account is added.

Web Browsing

Using Browser

1

In Home Screen,  (Browser)



 Browser opens.

- Tapping web links within text messages automatically activates Browser.

Adding Bookmarks

1

In Home Screen,  (Browser)



 Browser opens.



2

  Bookmarks



 Bookmarks opens.

3

Add  Confirm name and URL  OK

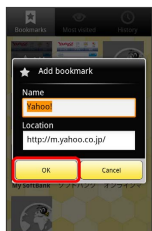

 Current webpage is added to Bookmarks.

Opening New Webpages

Open multiple webpages and toggle between them. Open up to 8 pages at once.

1

In Home Screen,  (Browser)

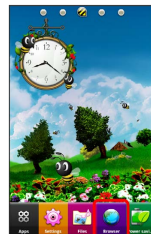



 Browser opens.

2

 New window



 New webpage appears.

- After several windows are opened, in Browser window, Press , Tap **Windows** and then **New window**.
- In Browser, Press  and Tap **Windows** to toggle active webpages.

Using SSL/TLS

Secure Sockets Layer (SSL) and Transport Layer Security (TLS) are encryption protocols that secure Internet transmissions of important/sensitive information such as credit card numbers and corporate secrets, providing protection against online threats (eavesdropping, falsification, impersonation, etc.). Handset is preloaded with digital certificates issued by certificate authorities.

SSL/TLS Caution

When a security notice appears upon opening an Internet page, subscribers must decide for themselves whether or not to open the page. Opening secure pages constitutes agreement to the terms of SSL/TLS usage. SoftBank Mobile, VeriSign Japan and Cybertrust cannot be held liable for any damages associated with the use of SSL/TLS.

Camera

Imaging.....46

Imaging

Capturing Photos

Insert SD Card before taking photos. (Photos are saved to SD Card.)

1

In Home Screen, [App Store] [Right Arrow] [Camera] (Camera)



[Flag Icon] Camera Viewfinder appears.

2

Frame subject in Viewfinder [Right Arrow] [Shutter Button]



[Flag Icon] Shutter clicks and photo is saved automatically to SD Card.

Recording Videos

Insert SD Card before shooting videos. (Videos are saved to SD Card.)

1

In Home Screen, [App Store] [Right Arrow] [Video camera] (Video camera)

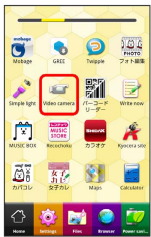

[Flag Icon] Video Viewfinder appears.

2

Frame subject in Viewfinder [Right Arrow] [Record Button]



[Flag Icon] Record-start Shutter sounds and video is saved automatically to SD Card.

3

Tap [Record Button] to end Camera



[Flag Icon] Recording ends and video is saved.

Imaging Notes

Photo File Format

Photos are saved as JPEG files.

Video File Format

Videos are saved as MPEG-4 files.

Camera Cautions

Keep Lens Clean

Fingerprints/smudging may hinder handset imaging. Clean Lens with a soft cloth beforehand.

Avoid Direct Sunlight Exposure

Do not expose Lens to direct sunlight for extended periods; may discolor Filter, altering images.

Music & Images

Music Files.....	50
Image Files.....	50

Music Files

Playing Music Files

1

In Home Screen,    (Music)



 Music Library appears.

2

Tap a file to play it

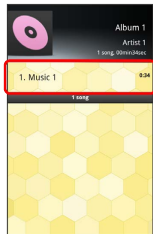



 Song plays.

Image Files

Viewing Images

View still images and videos saved to SD Card.

1

In Home Screen,  (Files)



 Album index appears.

2

Images

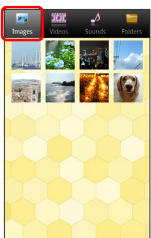

3

Tap image to view it

 Image appears.

Connectivity

Wi-Fi.....52

Bluetooth®..... 53

Wi-Fi

Use household Wi-Fi networks, etc. to connect to the Internet.

Connecting to Wi-Fi Networks

Select from available networks to establish a connection.

1

In Home Screen,   **Settings**

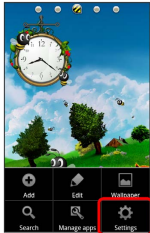

2

Wireless & networks  **Wi-Fi settings**

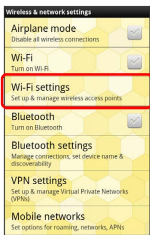



 Wi-Fi settings appears.

3

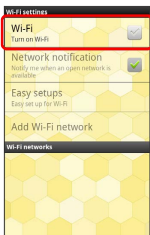
Wi-Fi ()



4

Select Wi-Fi network  Enter Security Key  **Connect**

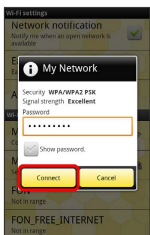

 Wi-Fi network connects.

· Unsecured networks do not require Security Key entry.

+ Wi-Fi Operations

Deleting Networks





In Wi-Fi settings, Tap active access point  **Forget**

Check Access Point Details





In Wi-Fi settings, Tap current access point

 Connection Status, Security, Signal strength, Link speed, IP address appear.





Set Wi-Fi Sleep Policy

In Wi-Fi settings,   **Advanced**  **Wi-Fi sleep policy**  Tap items

Set Auto Scan Intervals

In Wi-Fi settings,   **Advanced**  **Auto scan intervals**  Tap items

Connect Static IP

In Wi-Fi settings,   **Advanced**  **Use static IP**  Tap item  Enter information

Deleting Access Points

In Wi-Fi settings, Touch & Hold access point  **Forget network**

Bluetooth®

Connect handset to other Bluetooth® devices for wireless connectivity.

Activating Bluetooth®

- Handset may not pair with all Bluetooth® devices.
- Some paired devices may not operate correctly.
- Noise may occur when using wireless/handsfree devices.

1

In Home Screen,   Settings



2

Wireless & networks

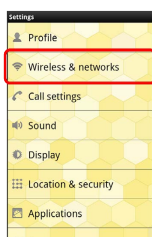

3

Bluetooth ()

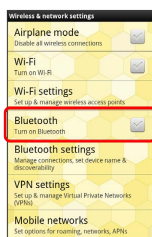

 Bluetooth® is on.

- Tap **Bluetooth** to toggle Bluetooth® on/off.

Global Services

Calling Outside Japan..... 56

Calling Outside Japan

International Calling

1



Onscreen dialpad appears.

2

Touch & Hold 0 +



+ appears.

3

Omit first 0 from phone numbers when placing international calls



Do not omit first 0 from phone numbers when dialing Italy (39).

4



Ringback tone sounds. Wait for receiver to accept call to talk.

Global Roaming

Place calls the same way you would within Japan.

- Do not enter country code or omit first 0 from phone numbers.

1

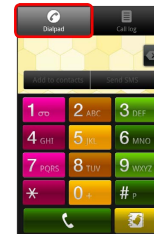

Onscreen dialpad appears.

2

Use onscreen dialpad to enter phone number

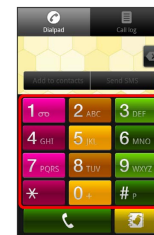

3

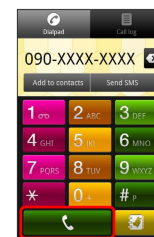

Ringback tone sounds. Wait for receiver to accept call to talk.

Settings

- Profile..... 58
- Wireless & Networks.....58
- Call..... 60
- Sound.....61
- Applications.....62
- Accounts & Sync.....63
- Privacy..... 64
- Language & Keyboard.....64
- Date & Time.....65
- About Phone.....66

Profile

Profile

+ Profile

Confirm Profile

In Home Screen,  → Settings → Profile

 Profile appears.

· Press  to share or edit profile.



Wireless & Networks

Wireless & Networks Settings

+ Airplane Mode

Canceling All Handset Transmissions without Powering Off



In Home Screen,  → Settings → Wireless & networks → Airplane mode

· Tap Airplane mode to toggle setting On ()/Off ().

+ Wi-Fi

Enabling/Disabling Wi-Fi Connectivity



In Home Screen,  → Settings → Wireless & networks → Wi-Fi

· Tap Wi-Fi to toggle Wi-Fi On ()/Off ().
· Alternatively, Tap Wi-Fi in Wi-Fi settings .

+ Wi-Fi Settings

Enabling/Disabling Wi-Fi Access Point Notifications

In Home Screen,  → Settings → Wireless & networks → Wi-Fi settings → Network notification

· Wi-Fi must be active to use this function.
· Tap Network notification to toggle setting On ()/Off ().

Setting Wi-Fi with AOSS

In Home Screen,  → Settings → Wireless & networks → Wi-Fi settings → Easy setups → AOSS settings → Follow onscreen instructions

· Wi-Fi must be enabled to use this setting.

Setting Wi-Fi with WPS

In Home Screen,  → Settings → Wireless & networks → Wi-Fi settings → Easy setups → WPS settings → WPS button (Push button) / Pass code (PIN) → Follow onscreen instructions

· Wi-Fi must be enabled to use this setting.

Adding Networks

In Home Screen,  → Settings → Wireless & networks → Wi-Fi settings → Add Wi-Fi network → Enter network settings → Save

- Wi-Fi must be enabled to use this setting.
- Some security protocols may require additional information entry.

+ Bluetooth

Enabling/Disabling Bluetooth® Connectivity

In Home Screen,  → Settings → Wireless & networks → Bluetooth

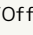
- Tap Bluetooth to toggle setting On ()/Off ().
- Alternatively, Tap Bluetooth in Bluetooth settings .

+ Bluetooth Settings

Changing Name Appearing on Paired Devices

In Home Screen,  → Settings → Wireless & networks → Bluetooth settings → Device name → Enter name → OK

Changing Device Visibility

In Home Screen,  → Settings → Wireless & networks → Bluetooth settings → Discoverable

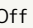
- Tap Discoverable to toggle setting On ()/Off ().

Searching for Pairable Devices

In Home Screen,  → Settings → Wireless & networks → Bluetooth settings → Scan for devices

+ VPN Settings

Adding a VPN

In Home Screen,  → Settings → Wireless & networks → VPN settings → Add VPN → Tap items → Set items →  → Save

- Tap VPN to toggle connection On/Off. Touch & Hold VPN to edit/delete it.

+ Mobile Networks

Enabling/Disabling 3G Packet Communications

In Home Screen,  → Settings → Wireless & networks → Mobile networks → Data enabled

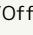

- Tap Data enabled to toggle setting On ()/Off ().

Enabling/Disabling Data roaming

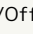

In Home Screen,  → Settings → Wireless & networks → Mobile networks → Data roaming

- Tap Data roaming to toggle setting On ()/Off ().
- If confirmation appears, follow onscreen instructions.

Adding Access Points

In Home Screen,  → Settings → Wireless & networks → Mobile networks → Access Point Names →  → New APN → Tap items → Set items →  → Save

Deleting Added Access Points & Restoring Defaults

In Home Screen,  → Settings → Wireless & networks → Mobile networks → Access Point Names →  → Reset to default

Setting Connection Method

In Home Screen,  → Settings → Wireless & networks → Mobile networks → Network modes → Tap items

Selecting Operator

In Home Screen,  → Settings → Wireless & networks → Mobile networks → Network operators → Select automatically /Select from search results

- Tapping Select automatically automatically sets optimum network.
- To refresh search, Tap Search networks or Select automatically .

Call



Call Settings

+ Call Time

Confirm Call Time

In Home Screen,  → Settings → Call settings → Call Time



Reset Call Time

In Home Screen,  → Settings → Call settings → Call Time →  → Reset → OK

+ Auto Answering

Enable/Disable Auto Answering

In Home Screen,  → Settings → Call settings → Auto answering → Auto answering settings

· Tap Auto answering settings to toggle setting On ()/Off ().

Set Time until Auto Answering Responds

In Home Screen,  → Settings → Call settings → Auto answering → Answer time → Set answering time → Settings

Confirm Recorded Messages



In Home Screen,  → Settings → Call settings → Auto answering → Recorded messages

· Play back, delete, protect/cancel protection for messages.

+ Voice Mail & Call Forwarding

Enable/Disable Auto Answering

In Home Screen,  → Settings → Call settings → Voice mail & Call forwarding → Voice mail → Immediately / After certain seconds → Settings

· Tap Voice mail to toggle setting On ()/Off ().
· Tap After certain seconds to set the ring time.

Enable/Disable Call Forwarding

In Home Screen,  → Settings → Call settings → Voice mail & Call forwarding → Call forwarding → Immediately / After certain seconds → Enter phone number → Settings

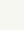
· Tap Call forwarding to toggle setting On ()/Off ().
· Tap After certain seconds to set the ring time.

Stop Both Voicemail and Call Forwarding

In Home Screen,  → Settings → Call settings → Voice mail & Call forwarding → Stop voice mail & call forwarding → OK

Play Back Recorded Messages

In Home Screen,  → Settings → Call settings → Voice mail & Call forwarding → Play voice mail → OK

· Voicemail Center is dialed.

+ Incoming Reject

Enable/Disable Incoming Reject

In Home Screen,  → Settings → Call settings → Incoming Reject → Enter PIN (Lock No.) → OK →

Follow onscreen instructions

Confirm List of Incoming Reject Phone Numbers



In Home Screen,  → Settings → Call settings → Incoming Reject → Enter PIN (Lock No.) → OK → Specified number → Reject list

· Add or delete numbers to or from list.

+ Additional Settings



Enable/Disable Caller ID Information when Dialing

In Home Screen,  → Settings → Call settings → Additional settings → Caller ID

· Tap Caller ID to toggle setting On ()/Off ().

Enable/Disable Incoming Call Notification during Call

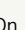
In Home Screen,  → Settings → Call settings → Additional settings → Call waiting

· Tap Call waiting to toggle setting On ()/Off ().

Sound

Sound Settings

+ Silent Mode

Adjust Silent Mode Settings

In Home Screen,  → Settings → Sound → Silent mode

- Tap **Silent mode** to toggle Silent setting On ()/Off ().

+ Vibrate

Toggle Vibration On/Off for Selectable Items

In Home Screen,  → Settings → Sound → Vibrate → Tap items

+ Volume

Adjust Volume Levels for Handset Sounds

In Home Screen,  → Settings → Sound → Volume → Adjust volume → OK

- Tap **Use incoming call volume for notifications** to use incoming transmission volume for notifications.

+ Phone Ringtone

Set Tones for Incoming Transmissions

In Home Screen,  → Settings → Sound → Phone ringtone → Tap items to set → Follow onscreen instructions

+ Vibration Pattern

Set Vibration for Incoming Call

In Home Screen,  → Settings → Sound → Vibration pattern → Tap items to set → OK

+ Incoming LED

Set LED for Incoming Call

In Home Screen,  → Settings → Sound → Incoming LED → Tap items to set → OK

+ Notification Sound

Select Notification Tones

In Home Screen,  → Settings → Sound →

Notification ringtone → Tap items → Follow onscreen instructions

+ Notification LED

Enable/Disable Notification LED Flashing

In Home Screen,  → Settings → Sound → Notification LED

- Tap **Notification LED** to use incoming transmission volume for notifications.

+ Audible Touch Tones

Enable/Disable Dialpad Tones

In Home Screen,  → Settings → Sound → Audible touch tones

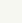
- Tap **Audible touch tones** to toggle setting On ()/Off ().
- Cancel this setting to improve battery life.

+ Audible Selection

Enable/Disable Confirmation Tones

In Home Screen,  → Settings → Sound → Audible selection

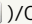
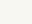
- Tap **Audible selection** to toggle setting On ()/Off ().
- Cancel this setting to improve battery life.

+ Screen Lock Sounds

Enable/Disable Screen Lock Tone

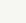
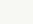

In Home Screen,  → Settings → Sound → Screen lock sounds

- Tap **Screen lock sounds** to toggle this setting On ()/Off ().
- Cancel this setting to improve battery life.

+ Haptic Feedback

Enable/Disable Touch Vibration

In Home Screen,  → Settings → Sound → Haptic feedback

- Tap **Haptic feedback** to toggle setting On ()/Off ().



Applications

Application Settings

+ Unknown Sources

Enable Non Market Applications

In Home Screen,  → Settings → Applications → Unknown sources

- Tap **Unknown sources** to toggle this setting On ()/Off ().
- If confirmation appears, follow onscreen instructions.

+ Manage Applications

Confirm Name, Version, Size, etc. of Installed Applications

In Home Screen,  → Settings → Applications → Manage applications → Tap application

- Force close, or uninstall applications.

+ Running Services

Show Active Applications

In Home Screen,  → Settings → Applications → Running services

- Tap application then **Stop** to stop it.

+ Storage Use

Confirm Amount of Storage Use

In Home Screen,  → Settings → Applications → Storage use

+ Battery Use

Confirm Amounts of Battery Use and Battery Time



In Home Screen,  → Settings → Applications → Battery use → Tap items

- Adjust battery use for listed functions. Tap function name for adjustment window.

+ Development

Enable/Disable USB Debug

In Home Screen,  → Settings → Application → Development → USB debugging

- Tap **USB debugging** to toggle On ()/Off ().
- If confirmation appears, follow onscreen instructions.

Enable/Disable Sleep while Charging

In Home Screen,  → Settings → Applications → Development → Stay awake

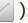
- Tap **Stay awake** to toggle setting On ()/Off ().

Enable/Disable Location Information

In Home Screen,  → Settings → Application → Development → Allow mock locations

- Tap **Allow mock locations** to toggle setting On ()/Off ().



Accounts & Sync

Accounts & Sync Settings

+ Background Data

Enable/Disable Background Transmissions



In Home Screen,  → Settings → Accounts & sync → Background data

- Tap **Background data** to toggle setting On ()/Off ().
- If confirmation appears, follow onscreen instruction.
- Cancel this setting to improve battery life.

+ Auto-Sync

Enable/Disable Application Auto Sync

In Home Screen,  → Settings → Accounts & sync → Auto-sync

- Tap **Auto-sync** to toggle setting On ()/Off ().
- **Background data** must be On () to enable this setting.

+ Add Account

Add Accounts

In Home Screen,  → Settings → Accounts & sync → Add account → Tap items to set → Follow onscreen instructions

 Added account appears.

- To delete added account, Tap account then **Remove account**. Next, follow onscreen instructions.

Privacy

Privacy Settings

+ Factory Data Reset

Restore Handset to Factory Defaults

In Home Screen,  → Settings → Privacy → Factory data reset → Reset phone → Erase everything

- This operation deletes all handset data.
- Deleted handset data cannot be recovered.

Language & Keyboard

Language & Keyboard Settings

+ Select Language

Set User Interface Language

In Home Screen,  → Settings → Language & keyboard → Select language → Tap setting

+ Android Keyboard

Enable/Disable Touch Vibration

In Home Screen,  → Settings → Language & keyboard → Android keyboard → Vibrate on keypress

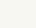
- Tap Vibrate on keypress to toggle setting On ()/Off ().

Enable/Disable Key Touch Tones

In Home Screen,  → Settings → Language & keyboard → Android keyboard → Sound on keypress

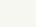
- Tap Sound on keypress to toggle setting On ()/Off ().

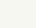

Enable/Disable Key Enlargement when Tapped

In Home Screen,  → Settings → Language & keyboard → Android keyboard → Popup on keypress

- Tap Popup on keypress to toggle setting On ()/Off ().



Enable/Disable Tapping to Correct Entered Text

In Home Screen,  → Settings → Language & keyboard → Android keyboard → Touch to correct words

- Tap Touch to correct words to toggle setting On ()/Off ().

Enable/Disable Auto Initial Caps

In Home Screen,  → Settings → Language & keyboard → Android keyboard → Auto-capitalization

- Tap Auto-capitalization to toggle this setting On ()/Off ().

Enable/Disable Settings Key on Keyboard

In Home Screen,  → Settings → Language & keyboard → Android keyboard → Show settings key → Tap setting

Enable/Disable Voice Input

In Home Screen,  → Settings → Language & keyboard → Android keyboard → Voice input → Tap items

- If confirmation appears, follow onscreen instructions.

Set to Change Language by Dragging on Spacebar

In Home Screen,  → Settings → Language & keyboard → Android keyboard → Input languages → Tap language

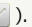
- Tap language to toggle set ()/cancel ().

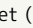
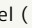

Set to Correct Commonly Typed Mistakes

In Home Screen,  → Settings → Language & keyboard → Android keyboard → Quick fixes → Tap language

- Tap Quick fixes to toggle set ()/cancel ().

Enable/Disable Predictive Entry

In Home Screen,  → Settings → Language & keyboard → Android keyboard → Show suggestions

- Tap Show suggestions to toggle setting On ()/Off ().

Date & Time

Date & Time Settings

Automatic

Correct Date and Time Automatically

In Home Screen,  → Settings → Date & time → Automatic

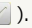
- Tap Automatic to toggle setting On ()/Off ().

Set Date

Setting Date Manually

In Home Screen,  → Settings → Date & time → Set date → Enter date → Set

Select Time Zone

Setting Date Manually

In Home Screen,  → Settings → Date & time → Select time zone → Tap area

Set Time

Setting Time Manually

In Home Screen,  → Settings → Date & time → Set time → Enter time → Set

Use 24-hour Format

Enabling/Disabling 24-hour Format

In Home Screen,  → Settings → Date & time → Use 24-hour format

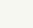
- Tap Use 24-hour format to toggle setting On ()/Off ().

Select Date Format

Changing Date Format

In Home Screen,  → Settings → Date & time → Select date format → Tap items

About Phone

About Phone

Software Update



Check for Android Software Updates

In Home Screen,  → Settings → About phone → Software update → Start updating software →

- Follow onscreen instructions
- Unavailable when data for a major update is downloaded.

Enable/Disable Automatic Download and Update when Update Available

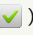
In Home Screen,  → Settings → About phone → Software update → Auto download settings →

- Tap Auto download settings to toggle setting On ()/Off ().
- If confirmation appears, follow onscreen instructions.
- Unavailable when data for a major update is downloaded.

Set Time for Automatic Update when Update Available (Software Update)

In Home Screen,  → Settings → About phone → Software update → Auto update time settings → Enter time → Set → Confirm onscreen cautions → OK

- Available when Auto download settings is set or when software update data is downloaded.
- Unavailable when data for a major update is downloaded.

Confirm Availability of New Android Version Manually

In Home Screen,  → Settings → About phone → Software update → Start major update → Follow onscreen instructions

- Use major update tool for Android handsets to update via PC.
- Unavailable when data for a software update is downloaded.

Set Time for Automatic Download when New Android Version Available (Major Update)

In Home Screen,  → Settings → About phone → Software update → Auto update time settings → Enter time → Set → Confirm onscreen cautions → OK

- Available when major update data is downloaded.
- Unavailable when data for a software update is downloaded.

Enable/Disable Notification when New Software/Android Version is Available

In Home Screen,  → Settings → About phone → Software update → Update notification →

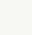
- Tap Update notification to toggle setting On ()/Off ().

Electromagnetic Sensor Adjustment

Adjust Electromagnetic Sensor Sensitivity

In Home Screen,  → Settings → About phone → Electromagnetic sensor adjustment → START →

Follow onscreen instructions

Status

Confirm Handset Status

In Home Screen,  → Settings → About phone → Status

Battery Use

Confirm Battery Status/Battery Time

In Home Screen,  → Settings → About phone → Battery use → Tap items

- Adjustable items appear. Tap items to adjust.

Legal Information

Confirm Handset Copyrights & Licenses

In Home Screen,  → Settings → About phone → Legal information → Tap items

Model Number

Confirm Handset Model Number

In Home Screen,  → Settings → About phone

- Handset model number appears.

+ Android Version

Confirm Android Operating System Version

In Home Screen,  → Settings → About phone

· Android version info appears.

+ Baseband Version

Confirm Baseband Version

In Home Screen,  → Settings → About phone

· Baseband info appears.

+ Kernel Version

Confirm Kernel Version

In Home Screen,  → Settings → About phone

· Kernel version info appears.

+ Build Number

Confirm Build Number

In Home Screen,  → Settings → About phone

· Build Number appears.

+ Labeling Of Compliance

Confirm Compliance Information

In Home Screen,  → Settings → About phone →
Labeling of Compliance

Appendix

Specifications.....	70
Materials.....	70
Customer Service.....	71

Specifications

Model

Item	Description
Weight	Handset alone: 107 g Battery installed: 133 g
Continuous Talk Time ¹	3G: 340 minutes GSM: 290 minutes
Continuous Standby Time ²	3G: 450 hours GSM: 350 hours
Charging Time (handset power off)	AC Charger: 220 minutes
Dimensions (W x H x D)	56×117×13.4 mm (excl. projections)
Maximum Output	3G: 0.25 W GSM: 2.0 W

- 1 Average for a new and fully charged battery and normal signal reception at a single location.
- 2 Average for a new and fully charged battery and normal signal reception at a single location without being in call or operation. Value when data transmission/emergency earthquake notification is disabled. Time varies with conditions of usage (charge, temperature, etc.) and function settings.

Battery (KYBAA1)

Item	Description
Voltage	3.7 V
Type	Lithium-ion
Capacity	1240 mAh
Dimensions (W x H x D)	45.1×49.5×5.1 mm (excl. projections)

AC Charger (KYCAA1)

Item	Description
Input	AC 100 V-240 V 0.2 A 50/60 Hz
Output	DC 5.0 V 800 mA
Charging temperature range	5°C–35°C ¹
Dimensions (W x H x D)	AC Charger unit: 50.6 x 38 x 23.8 mm
Cable length	Approx. 1.5 m

- 1 Depending on use, handset may become warm and cause charging to stop.

Materials

101K

Parts	Material/Finishing
Outer Case (Display side)	PA resin (contains glass fiber)/acrylic UV hardened coating (clear)
Outer Case (Battery Cover)	PC resin/acrylic UV hardened coating (clear)
Display	Glass
External Device Port Cover	PC resin + elastomeric resin/acrylic UV hardened coating (clear)
Power Key/ Volume Key/ Menu Key/ Home Key/ Back Key	PC resin/acrylic UV hardened coating (clear)
Camera Lens/ Light/Infrared Port Cover	Acrylic resin
Camera Lens (Front Camera)	Acrylic resin + PC resin
Screws	SUS410 stainless steel (PS surface treatment)/SWCH16A (iron/chrome plating)

Battery (KYBAA1)

Parts	Material/Finishing
Outer Case	PC resin + PA resin
Sealing	PET
Terminals	Nickel palladium plating

AC Charger (KYCAA1)

Parts	Material/Finishing
Unit (Outer Case)	PC resin
Cable	TPE resin
Plug	Nickel plating

Customer Service

For SoftBank handset or service information, call General Information. For repairs, call Customer Assistance.

SoftBank Customer Support



General Information

From a SoftBank handset, dial toll free at 157
Call toll free from landlines at 0800-919-0157



Customer Assistance

From a SoftBank handset, dial toll free at 113
Call toll free from landlines at 0800-919-0113
If you cannot reach a toll free number, use the number (charges apply) below for your service area:
Hokkaido Area, Tohoku Area, Hokuriku Area, Kanto-Koshinetsu Area : 022-380-4380
Tokai Area : 052-388-2002
Kansai Area : 06-7669-0180
Chugoku, Shikoku Area, Kyushu, Okinawa Area : 092-687-0010

Smartphone Technical Support Center

From a SoftBank handset, dial toll free at 151
From a landline/IP phone, dial toll free at 0800-1700-151

SoftBank Mobile Global Call Center

From outside Japan, dial +81-3-5351-3491 (toll free from SoftBank handsets)
If handset is lost/stolen, call this number immediately (international charges apply)

Safety Precautions

Safety Precautions.....	74
General Notes.....	82
Water & Dust Resistance.....	87

Safety Precautions



For proper handset use, carefully read Safety Precautions beforehand. Keep this guide for future reference.

Observe these safety precautions to prevent injury or damage to property.

SoftBank accepts no liability for any loss or damages incurred by you or a third party as a result of missed calls, etc., due to malfunction, erroneous operation or failure of this product.

Labels







Risks of injury or damage from improper use are categorized by levels. Understand these labels before reading this guide.

Mark	Descriptions
 DANGER	Great risk of death or serious injury ¹ from improper use
 WARNING	Risk of death or serious injury ¹ from improper use
 CAUTION	Risk of injury ² or damage to property ³ from improper use

- 1 Serious injury includes: Loss of eyesight, physical injury, high temperature burns, low temperature burns, electric shock, fractures, poisoning and other conditions having side effects or requiring hospitalization or longterm treatment.
- 2 Injury includes: Physical burns (high-temperature and low-temperature), electric shock, and other conditions not requiring hospitalization or long-term treatment.
- 3 Damage to property includes: Incidental damage to structures and household property and/or to pets and livestock.

Symbols

Make sure you understand the following symbols and precautions before reading this guide.

Mark	Descriptions
 Prohibited	Action prohibited
 Do Not Disassemble	Disassembly prohibited
 Avoid Liquids Or Moisture	Exposure to liquids prohibited
 Do Not Use Wet Hands	Handling with wet hands prohibited
 Compulsory	Action compulsory
 Disconnect Power Source	Unplug power cord

Handset, Battery, USIM Card, AC Charger, Micro USB Cable (Sold Separately) & SD Card (Sample)

DANGER



Compulsory

Use SoftBank specified devices (battery, AC Charger or Micro USB Cable (sold separately)) only.

Use of non-specified devices may cause battery to leak, overheat, rupture or ignite; or may cause Charger/Micro USB Cable to overheat, ignite or malfunction.



Do Not Disassemble

Do not disassemble/modify/solder handset.

May cause fire, injury, electric shock or malfunction. Also, battery may leak, overheat, rupture or ignite.

Modifying handset is a violation of the Radio Law and subject to penalty.



Prohibited

Do not charge, use or leave handset in places subject to high temperatures (near an open flame or heating equipment, in direct sunlight or inside a car on a hot day).

May cause deformation or malfunction; or may cause battery to leak, overheat, ignite or rupture. Also, the outer housing may become hot resulting in burns.



Prohibited

Do not use excessive force to attach battery, AC Charger or Micro USB Cable to handset.

Battery or AC Charger may be the wrong way around. Battery may leak, overheat, rupture or ignite.

⚠ WARNING



Prohibited

Do not place handset, battery, AC Charger or Micro USB Cable in a microwave oven or pressure cooker, or on an induction cooktop.

May cause battery to leak, overheat, rupture or ignite; or may cause handset, AC Charger or Micro USB Cable to overheat, emit smoke, ignite or malfunction.



Compulsory

Turn off handset when entering gas stations or other places where flammable gases (propane gas, gasoline, etc.) or fine particulates generate. Be sure to turn off handset beforehand. Do not charge battery in such places.

Gases may ignite.

Using handset near petrochemicals or other flammables may cause fire or explosion.



Prohibited

Do not drop/throw handset or expose it to excessive shock.

May cause battery to leak, overheat, rupture or ignite; or may cause fire, electric shock or malfunction.



Compulsory

If you notice an unusual sound, odor, smoke, etc. while using, charging or storing handset, immediately:

1. Unplug AC Charger from outlet.
2. Turn handset power off.
3. Remove battery from handset, being careful of burn or injury.

Continued use may cause fire or electric shock.



Prohibited

Do not charge when handset is wetted.

May cause electric shock or short circuit leading to malfunction or fire. Malfunction due to charging while wetted is not covered under warranty.



Avoid Liquids Or Moisture

Your handset is waterproof. However, discontinue use if water or other liquid enters handset (External Device Port Cover, Battery Cover, etc.).

Using handset as is may cause overheating, fire, or malfunction.



Prohibited

Keep liquids (water, pet urine, etc.) and conductive materials (e.g. pencil lead, metal fragments, metal necklaces, hairpins, etc.) away from 3.5 mm Audio Port or External Device Port.

May cause short circuit, resulting in fire or malfunction.

⚠ CAUTION



Prohibited

Do not place handset on an uneven or unstable surface.

Handset may fall, leading to injuries or handset malfunction. Be particularly careful while charging or when vibrator is activated.



Prohibited

Do not touch handset, battery, AC Charger, or Micro USB Cable for extended period when powered externally.

May cause low-temperature burns.



Prohibited

Do not leave in presence of corrosive chemicals or gases.

May cause malfunction, resulting in loss of internal data.



Avoid Liquids Or Moisture

Do not use in high humidity.

Humidity when worn on body may cause malfunction. Malfunction determined to be due to water entering handset or humidity is not covered under warranty.



Compulsory

Keep handset out of reach of infants.

Failing to do so may result in small parts being accidentally swallowed or may cause injury.



Compulsory

When a child uses handset, parent supervision is advised. Provide child with proper instructions.

Failing to do so may cause injury, etc.

Battery

DANGER

Read battery label to confirm battery type; use/dispose of battery accordingly.

Symbol on Label	Battery Type
Li-ion00	Lithium-ion



Prohibited

Do not short-circuit the (+) and (-) terminals.

May cause battery to rupture, ignite, or overheat.



Prohibited

Do not insert battery in handset with (+) and (-) reversed.

May cause battery to rupture, ignite, or overheat. If there is trouble inserting battery, do not force battery and check connection points.



Prohibited

Do not dispose of battery in fire.

May cause battery to leak, rupture or ignite.



Prohibited

Do not damage (nail, hammer, stomp, etc.) battery or subject it to strong impacts/shocks.

May cause battery to leak, overheat, rupture or ignite.



Prohibited

Keep metal objects (pins, etc.) away from battery terminals. Do not carry or store conductive materials (e.g. pencil lead, metal fragments, metal necklaces, hairpins, etc.) together with battery.

May cause battery to leak, overheat, rupture or ignite.



Compulsory

If battery fluid gets into eyes, immediately rinse with clean water and consult a doctor. Do not rub eyes.

Failing to do so may result in loss of eyesight.



Do Not Use Wet Hands

Never handle with wet hands.

WARNING



Avoid Liquids Or Moisture

Battery is not waterproof.

Do not wet battery (water, sea water, pet urine, etc.). Do not charge a wetted battery. Wetting may cause battery to overheat, rupture, or ignite.



Compulsory

If battery fluid gets on your skin or clothing, immediately stop handset use and rinse with clean water.

Battery fluid may harm your skin.



Compulsory

If battery is not fully charged even after specified charging time, stop charging.

Battery may leak, overheat, rupture or ignite.



Compulsory

If you notice an unusual odor, overheating, discoloration, deformation, etc. while using, charging or storing battery, remove it from handset and keep it away from fire. Be careful not to burn or injure yourself.

Continued use may cause battery to leak, overheat, rupture or ignite.



Compulsory

Keep battery away from pets.

Bites may cause battery to leak, overheat, rupture or ignite, or cause device malfunction or fire.

CAUTION

Prohibited

Do not dispose of battery as municipal waste.

Bring used battery to a SoftBank Shop or recycling center after insulating the terminals with tape. Be sure to observe local regulations on battery disposal.



Prohibited

Do not remove sticker wrapped around battery.

May cause malfunction.



Prohibited

Do not forcibly insert/remove battery.

May damage battery or Battery Cover, and cause injury.

Handset**! DANGER**

Compulsory

Check your surroundings to confirm that it is safe to make/receive calls, send/receive messages, take pictures or record videos, play games, or access the Internet.

Failing to do so may cause you to trip over or cause a traffic accident.



Compulsory

Be careful with volume of a headset.

Difficulty hearing around you may result in an accident.

! WARNING

Prohibited

Difficulty hearing around you may result in an accident.

Not following items 1 to 4 below and "[Water & Dust Resistance](#)" may cause handset to ignite, overheat, or malfunction, or may cause scratches or electric shock.

1 Do not use submersed (including key operation).

2 Do not immerse in liquid other than room temperature fresh water or tap water.

3 Do not subject to water flow stronger than rating ([IPX5](#), [IPX7](#)) or leave in water for an extended period.

4 Do not place on sand (beach, etc.)



Prohibited

Do not use while operating a vehicle (car, motorcycle, bicycle, etc.)

May cause a traffic accident. Use of a mobile phone while driving is prohibited by law, and is subject to penalty. Stop vehicle in a safe location (where parking is allowed) before using handset.



Compulsory

Keep handset power off near high precision electronic devices or devices using weak signals.

Handset may cause these devices to malfunction.

Devices that may be affected:

Hearing aids, implanted cardiac pacemakers, implanted defibrillators and other electronic medical equipment; fire alarms, automatic doors and other automatic control devices.



Compulsory

Display uses reinforced glass. If glass breaks due to shock (being dropped) or extreme force, do not touch with hands, feet, etc.

May cause injury. If glass breaks, discontinue use and visit a SoftBank Shop or contact [SoftBank Customer Support](#).



Compulsory

Keep handset power off aboard aircraft.

When in-flight use is permitted, observe airline instructions.



Compulsory

If you have a weak heart, be careful with incoming call vibrator and ringtone volume settings.

These may affect your heart.



Compulsory

If thunder is heard while outside, immediately turn handset power off and seek shelter.

Failing to do so may attract lightning and cause electric shock.



Prohibited

Do not point Infrared Port at eyes.

May impair vision.



Prohibited

Do not turn on or shine Light near someone's eyes. Do not look directly at Light when it is on. Also do not point Light at someone else and turn it on.

May cause harm such as loss of eyesight. Especially, do not photograph infants up close. May also temporarily affect eyesight or startle, leading to injury or other accident.



Prohibited

If handset becomes damaged or contents exposed, do not touch broken or exposed parts.

May cause electric shock or injury. Discontinue use and visit a SoftBank Shop or contact [SoftBank Customer Support](#).



Prohibited

Do not gaze at a bright or flashing screen in a dark location.

Only rarely, screen brightness or flashing can cause symptoms in individuals such as convulsions or loss of consciousness. See a doctor beforehand if you have such history.



Prohibited

Do not expose Camera Lens to direct sunlight for extended period.

Since Lens collects light, may cause handset to ignite or a fire.



Compulsory

Use handset normally with External Device Port Cover and Battery Cover secured.

If unsecured, may allow dust, water, etc. to enter and cause electric shock or malfunction due to short-circuiting.

⚠ CAUTION



Do Not
Disassemble

Never use a modified handset.

Using a modified handset is a violation of the Radio Law. Handset is certified as compliant with technical regulations as specific radio equipment based on the Radio Law, indicated by a  mark on handset.

Such certification is nullified if handset interior is modified. Using handset with certification nullified is a violation of the Radio Law and should never be used in such state.



Compulsory

Be careful of objects attaching to Receiver or Speaker.

Receiver and Speaker are magnetic. Pieces of metal (tacks, pins, cutter blades, staples, etc.) can be magnetized and cause unexpected injury. Check Receiver and Speaker before use.



Prohibited

Do not use handset in a vehicle if it affects in-vehicle electronic devices.

Use of handset in some types of vehicles may, in some rare cases, affect in-vehicle electronic devices and interfere with safe driving.



Compulsory

If skin abnormality occurs with use of handset, immediately discontinue use and consult a doctor.

Handset contains metals, etc. Depending on your physical condition, you may experience itchiness, rash, etc.

For more information, see [Materials](#).



Prohibited

Keep magnetic cards, etc. away from handset.

Failing to do so may cause magnetic data on a cash card, credit card, telephone card or floppy disk to be lost.



Prohibited

Do not swing handset by Strap, etc.

Handset may strike you or persons around you, or Strap may break and cause injury, malfunction, or damage.



Compulsory

Handset may become hot during prolonged use.

Skin contact for extended period may cause low-temperature burns.



Compulsory

Be careful with volume of a headset.

Prolonged use may impair hearing, and sudden loudness may hurt ears.



Compulsory

Use handset in temperatures between 5°C–35°C and humidity within 35%–90% (limited use in temperatures between 36°C–40°C).

Malfunction determined to be due to use in extremes beyond these ranges is not covered under warranty.



Compulsory

Remove protective Display sheet before use.

Using handset with sheet attached may cause injury. Be careful of injuring fingers when removing.

USIM Card & SD Card (Sample)

CAUTION



Prohibited

Do not bend USIM Card or place a heavy object on it.

May cause malfunction.



Prohibited

Do not carelessly touch or short-circuit IC (metal) portion of USIM Card.

May cause loss of data or malfunction.



Prohibited

Do not scratch IC (metal) portion of USIM Card.

May cause malfunction.

Avoid Liquids
Or Moisture

Do not wet USIM Card.

May cause malfunction.



Prohibited

Insert SD Card in specified direction all the way without suddenly releasing your finger.



Prohibited

Always power off handset before inserting or removing SD Card.

May cause malfunction and loss of internal data.



Prohibited

Do not use excessive force when removing SD Card.

May cause malfunction and loss of internal data.



Prohibited

Use only specified SD Card.

May cause malfunction and loss of internal data.

AC Charger, Micro USB Cable (Sold Separately)

WARNING



Prohibited

Do not cover or wrap with clothing or bedding during charging.

Heat may build up resulting in fire or malfunction.



Prohibited

Use the specified power supply and voltage.

Failing to do so may cause fire or malfunction.

AC Charger: 100 to 240 V AC (for household AC outlets only)

Also, do not use commercially available voltage converters, as when travelling. May cause fire, electric shock or malfunction.

Disconnect
Power Source

Hold plug and unplug AC Charger from outlet before extended periods of handset disuse.

Failing to do so may cause electric shock, fire or malfunction.



Compulsory

Plug in firmly to base of outlet.

If not plugged in firmly, may cause AC Charger/Micro USB Cable to ignite or overheat, a fire, or electric shock.

Avoid Liquids
Or Moisture

AC Charger and Micro USB Cable are not waterproof.

Use where not exposed to liquids (water, pet urine, etc.).

May cause AC Charger/Micro USB Cable to overheat, ignite, a fire, electric shock, or short circuit. If wetted, immediately unplug from outlet.

Disconnect
Power Source

If liquid (water, pet urine, etc.) gets into AC Charger, immediately hold plug and unplug AC Charger from outlet.

Failing to do so may cause electric shock, smoke emission or fire.



Compulsory

If dust accumulates on AC Charger plug, hold plug and unplug AC Charger from outlet and wipe with a dry cloth.

Failing to do so may cause fire.



Compulsory

Plug in AC Charger firmly all the way, being careful that conductive objects (pencil lead, metal, metal necklaces or hairpins, etc.) do not come in contact with plug or terminals.

May cause electric shock, short circuit, fire, etc.



Do Not Use Wet Hands

Do not plug/unplug AC Charger/Micro USB Cable with wet hands.

May cause electric shock or malfunction.



Prohibited

If thunder is audible, do not touch AC Charger/Micro USB Cable.

May cause electric shock.



Avoid Liquids Or Moisture

Never use in high humidity (bath room, etc.).

May cause electric shock or malfunction.



Avoid Liquids Or Moisture

Do not charge a wetted battery.

May cause electric shock or malfunction.



Prohibited

Do not use in way that exceeds the rating for outlets or wiring.

Exceeding rating such as with a power bar may cause charger to ignite, overheat, or a fire.



Prohibited

Do not damage, shorten by cutting, twist, pull, or place heavy objects on cable or use while bundled. Do not use if damaged.

May cause AC Charger/Micro USB Cable to ignite, a fire, electric shock, or short circuit.



Compulsory

To connect AC Charger/Micro USB Cable to handset, always hold by plug and insert straight. Hold by plug to disconnect.

Pulling by cable may damage cable and cause AC Charger/Micro USB Cable to ignite, a fire, or electric shock.

CAUTION



Disconnect Power Source

Firmly hold plug and unplug AC Charger from outlet before cleaning.

Failing to do so may cause electric shock.



Compulsory

Do not unplug AC Charger by pulling the cable. Firmly hold plug and unplug AC Charger.

Pulling the cable may damage the cable resulting in electric shock or fire.



Prohibited

When AC Charger is connected to an outlet, do not pull on cord or otherwise subject AC Charger to strong shock.

May cause injury or malfunction.

Handset Use & Electronic Medical Equipment

The following information conforms to "The Guidelines on Use of Mobile Phones and Other Devices to Prevent Electromagnetic Wave Interference with Electronic Medical Equipment" (Electromagnetic Compatibility Conference Japan, March 1997), as well as refers to "The Investigative Research Report on the Influence of Electromagnetic Waves on Medical Equipment" (Association of Radio Industries and Businesses, March 2001).

WARNING



Compulsory

Keep handset a minimum of 22 centimeters from implanted cardiac pacemaker or implanted defibrillator.

Radio waves may interfere with the operation of implanted cardiac pacemakers or implanted defibrillators.



Compulsory

When using electronic medical equipment (other than implanted cardiac pacemakers/defibrillators) outside of medical institutions, consult device manufacturer about the influence of radio waves.

Radio waves may interfere with the operation of electronic medical equipment.



Compulsory

Handset radio waves may affect electronic medical equipment. Observe these guidelines in medical institutions:

- Do not bring handset into an operating room, ICU (Intensive Care Unit) or CCU (Coronary Care Unit).
- Turn off handset in hospital wards.
- Turn off handset even in lobbies or areas where use is permitted if there is electronic medical equipment nearby.
- Observe the instructions of individual medical institutions and do not use or bring handset into prohibited areas.



Compulsory

Keep handset power off in crowded places such as rush hour trains; a person with an implanted cardiac pacemaker or implanted defibrillator may be nearby.

Radio waves may interfere with the operation of implanted cardiac pacemakers or implanted defibrillators.

General Notes

Observe the following for optimal performance. Please use handset after reading carefully.

Usage Basics

- Content saved on handset (Address Book, mail, music, photos, videos, etc.) may be altered or erased due to accident, malfunction/repair, or other handling. Keep a copy of important content. SoftBank Mobile is not liable for any damages or lost profit resulting from alteration or loss of content.
- Do not use in places with much dust or vibration.
- Use of handset near a landline phone, TV, or radio may affect the image and sound quality of the equipment.
- Depending on conditions of use (in call, using Internet or mail, charging, etc.), handset and USIM Card may become warm. This is not a defect or malfunction.
- Be sure to charge battery before using handset for the first time or if handset has not been used for a long time. (During charging, battery may become warm. This is not a defect or malfunction.)
- Depending on usage, bulges may appear on battery near end of battery life. This is normal for lithium-ion batteries and does not affect safety.
- Sticker on handset bearing the manufacture number (in Battery Compartment) is certification that your SoftBank handset is licensed under the Radio Law and Telecommunications Business Law. Do not remove.
- Mail saved on handset, downloaded content (whether paid for or free), etc. cannot be transferred to an exchange SoftBank handset (replacing old handset, submitting handset for repairs, etc.).
- When using handset in public places, take care not to annoy other people around you.
- Wearing polarized sunglasses may cause Display to appear dark or distorted at certain angles.
- Hold handset so receiver is centered in ear during a call. Your earlobe can block the receiver and may make the other party difficult to hear.
- Trying to use keys during content playback may cause content to stop or other abnormal operation.
- Keeping Viewfinder open or shooting videos, operating Browser, etc. repeatedly for a continuous and extended period causes handset to become warm. Skin contact for extended period when handset is warm may cause low-temperature burns.
- Surrounding brightness is detected by Brightness Sensor. Avoid covering Sensor.
- SD Card may feel warm when removed from handset after prolonged use. This is not a defect or malfunction.
- Do not use or store SD Card in place where static electricity or electrical noise occurs easily.
- Back up content on an SD Card to a PC or other media (FD, MO, CD-RW, etc.). SoftBank Mobile is not liable for any damages resulting from loss of content due to SD Card breakage or other failure.
- If you choose to set one, do not forget PIN (Lock No.)/password for canceling Screen Lock. If you do forget it, take handset to a SoftBank Shop to reset it. This will erase all handset information and settings.

* PIN (Lock No.) is "9999" by default.

- A variety of applications can be installed to handset from "Android Market™" provided by Google Inc. SoftBank makes no guarantee whatsoever with regard to the nature (quality, reliability, legality, suitability for a purpose, validity of information, accuracy, etc.) of these applications that you yourself have installed, or with regard to any problems (viruses, etc.) resulting from them.

- Handset does not support Call Barring.

You must [cancel Call Barring](#) if handset is replacing an old handset on which Call Barring was set. Entering PIN incorrectly three times locks Call Barring. If locked, contact [SoftBank Customer Support](#).

Precautions

- Excess weight on handset may damage Display or internal parts, resulting in malfunction. Do not sit with handset in pocket or place at bottom of bag with other heavy objects. Even without exterior damage, it will not be covered under warranty.
- Do not use the following items in extreme temperatures or high humidity (use in temperatures between 5°C–35°C and humidity within 35%–85%).
 - AC Charger
 - Micro USB Cable (sold separately)
- Do not use the following items in extreme temperatures or high humidity. Use in temperatures between 5°C–35°C and humidity within 35%–90% (limited use in temperatures between 36°C–40°C).
 - 101K unit
 - battery
- Clean External Device Port and 3.5 mm Audio Port with a cotton swab occasionally. If dirty, may cause poor connection. Do not apply force and deform or scratch terminals.
- To clean handset, wipe it with dry, soft cloth. Do not use benzene, thinner, alcohol, soap, or other solvents. Doing so may discolor or remove exterior features or print.
- Before removing battery, power off handset and wait for Display to dim. Not doing so may cause saved content to be altered or erased.
- Do not pull on "PULL" tab and remove sticker from battery.
- Usable battery time decreases in extreme temperature conditions (left in car with closed windows on a hot day, etc.). Battery life also shortens. Using handset at room temperature is recommended.
- Before extended period of disuse, remove battery and store in battery case away from high temperature and humidity (battery case supplied with spare battery (sold separately)). Note that not energizing handset for extended period may cause content in handset to be erased.
- Battery is near end of its life when charging no longer restores handset functionality or bulges appear. Purchase a specified battery. Life depends on conditions of usage.
- Do not dispose of old battery with other waste. For environmental and recycling reasons, please take old battery to a SoftBank Shop or recycling center.



Li-ion00

- Handset Display pixels may be missing or remain lit. This is not a defect or malfunction.
- Do not subject Display to strong shock such pressing forcefully or hitting it. May cause scratches or breakage.
- Display uses high-transparency glass, and can appear dirty due to smudging, dust, etc. To clean, wipe with a dry, soft cloth.
- Do not rub or scratch Display or Camera Lens with a hard object.
- When placing handset in a pocket or bag, ensure that metal or other hard materials do not contact Display. Be careful with handset strap having metal or other hard parts, which may cause scratches or breakage.
- Water forms inside handset (called condensation) if moved from a cold to hot place (outdoors to indoors) or used in high humidity. May cause malfunction.

- Do not leave near air conditioning vent. Condensation from sudden temperature changes may corrosion of handset interior and malfunction.
- A strong magnet nearby may cause malfunction.
- Be careful not to drop handset and scratch surface finish. Remaining water, etc. may cause surface finish to peel.
- Display may be difficult to view in bright conditions (outdoors, under fluorescent lighting, etc.). This is not a defect or malfunction.
- USIM Card remains the property of SoftBank Mobile. If lost or damaged, it is replaced at cost. If it seems to be malfunctioning or if lost/stolen, visit a SoftBank Shop or contact [SoftBank Customer Support](#). Take old USIM Card (after subscription cancelation, etc.) to a SoftBank Shop.
- Do not use excessive force to insert/remove USIM Card.
- Malfunction due to inserting USIM Card in another IC Card reader/writer, etc. is at your own risk.
- Keep IC (metal) portion clean for use.
- Do not adhere labels, etc. on USIM Card.
- Do not disassemble or modify USIM Card. May cause content to be erased or malfunction.
- Insert SD Card properly. Cannot be used if not inserted properly.
- Do not touch, wet, or dirty SD Card terminal surface.
- Do not bend SD Card.
- Before disposing of old SD Card, physically destroy SD Card after erasing saved content to prevent content leakage.
- Unplug AC Charger if it will not be used.
- Do not wrap AC Charger with its cable. may cause electric shock, fire, or the Charger to ignite.

Camera

- Do not leave Camera Lens under direct sunlight. May burn or fade colors of elements.
- Shooting photos or storing handset in a warm place for extended period may affect image quality.
- Camera is high-precision, including pixels which always appear bright or dark. Blue, red, white, etc. dots will appear when shooting in extremely dark conditions.
- When shooting indoors under fluorescent lighting, flickering (extremely faint and not visible) may appear as stripes in image. This is not a defect or malfunction.
- Camera may make sound during operation, such as when being activated. This is not a defect or malfunction.
- Keeping Viewfinder open or shooting videos, operating Browser, etc. repeatedly for a continuous and extended period causes handset to become warm. Skin contact for extended period when handset is warm may cause low-temperature burns
- Observe proper etiquette when using Camera.
- Creating a public nuisance with Camera may be punishable by law.
- Practice taking and previewing pictures, videos, and audio before using Camera on important occasions like wedding ceremonies.
- Photo files (below, content) may be altered or erased due to repairs or other handling. SoftBank Mobile is not liable for any damages or lost profit resulting from content alteration/erasure or its restoration.
- Do not use Camera in locations where shooting photos or videos is prohibited.

Quake Alert (Application)

- Quake Alert Setting is enabled by default.
- An alert tone sounds when an alert is received, even in Silent mode.
- Alerts are not received during calls/transmissions or in poor signal conditions.
- Depending on usage/situation, handset may receive alerts for other areas or no alerts.
- Standby Time may decrease when Quake Alert Setting is enabled.
- SoftBank Mobile cannot be held liable for any damages associated with this service, including accidents resulting from received information, reception timing or reception failure.

Bluetooth®

· Frequencies

Handset Bluetooth® function uses 2.402 GHz – 2.480 GHz frequencies in the 2.4 GHz band.

2.4FH1: Uses 2.4 GHz band, FH-SS modulation, with a maximum interference range of 10 m.

 : Utilizes 2.402 GHz – 2.480 GHz band without mobile device bandwidth differentiation.



· Bluetooth® Cautions

· Handset Bluetooth® function is certified as compliant with domestic and FCC regulations. Use is restricted in some countries/regions. Confirm local laws before use abroad.

· The 2.4 GHz band used by handset Bluetooth® function is shared by other devices. Handset Bluetooth® function tries to minimize effects of other devices using the same bandwidth, but connection speed and distance may be reduced or function may be disconnected.

· Connection speed and distance vary depending on distance between connected devices, obstacles, and Bluetooth® devices.

· Before Using Bluetooth®

Bluetooth® operating frequency band is used by industrial, scientific, consumer and medical equipment including microwave ovens, other similar radio stations, premises radio stations for identifying mobile units used in manufacturing lines (radio stations requiring a license), specified low power radio stations (radio stations requiring no license) and amateur radio stations (hereafter, "other radio stations").

1. Before handset use, be sure "other radio stations" are not in use nearby.

2. If handset radio waves interfere with "other radio stations", promptly move or power off.

3. For further information, visit a SoftBank Shop or contact [SoftBank Customer Support](#).

· All handset operations when connected with a Bluetooth®-compatible device are not verified and therefore not guaranteed.

· Handset supports the Bluetooth®-standard security function for secure radio communication. However, be careful when using Bluetooth®, as security may be insufficient depending on conditions of usage or settings.

· SoftBank accepts no liability for data/information leaks during communication using Bluetooth®.

Wi-Fi (Wireless LAN)

· Frequencies

Handset Wi-Fi function uses 2.402 GHz – 2.480 GHz frequencies in the 2.4 GHz band.

Uses 2.4 GHz band, DS-SS/OFDM modulation, with a maximum interference range of 40 m.

 : Utilizes 2.402 GHz – 2.480 GHz band with mobile device bandwidth differentiation.



· Wi-Fi Cautions

· Handset wireless LAN function is certified as compliant with domestic and FCC/CE regulations. Use is restricted in some countries/regions including France. Confirm local laws before use abroad.

· The 2.4 GHz band used by handset Wi-Fi function is shared by other devices. Handset Wi-Fi function tries to minimize effects of other devices using the same bandwidth, but connection speed and distance may be reduced or function may be disconnected.

· Connection speed and distance vary depending on distance between connected devices, obstacles, and Wi-Fi devices.

· Before Using Wi-Fi

Wi-Fi operating frequency band is used by industrial, scientific, consumer and medical equipment including microwave ovens, other similar radio stations, premises radio stations for identifying mobile units used in manufacturing lines (radio stations requiring a license), specified low power radio stations (radio stations requiring no license) and amateur radio stations (hereafter, "other radio stations").

1. Before handset use, be sure "other radio stations" are not in use nearby.

2. If handset radio waves interfere with "other radio stations", promptly move or power off.

3. For further information, visit a SoftBank Shop or contact [SoftBank Customer Support](#).

· All handset operations when connected with a Wi-Fi-compatible device are not verified and therefore not guaranteed.

· Handset supports the Wi-Fi-standard security function for secure radio communication. However, be careful when using Wi-Fi, as security may be insufficient depending on conditions of usage or settings.

· SoftBank accepts no liability for data/information leaks during communication using Wi-Fi.

Electromagnetic Safety

For body-worn operation, this phone has been tested and meets RF exposure guidelines when used with accessories containing no metal, that position handset a minimum of 15 mm from the body. Use of other accessories may not ensure compliance with RF exposure guidelines.

CE Declaration of Conformity

CE 0560①

In some countries/regions, such as France, there are restrictions on the use of Wi-Fi. If you intend to use Wi-Fi on the handset abroad, check the local laws and regulations beforehand.

KYOCERA Corporation hereby declares that SoftBank 101K is in compliance with the essential requirements and other relevant provisions of Directive 1999/5/EC.

A copy of the original declaration of conformity for each model can be found at the following Internet address:

<http://www.kyocera.co.jp/prdct/telecom/consumer/>

RF Energy & Specific Absorption Rate (SAR)

SoftBank 101K meets MIC* technical regulation for exposure to radio waves.

The technical regulation established permitted levels of radio frequency energy, based on standards developed by independent scientific organizations through periodic and thorough evaluation of scientific studies.

The regulation employs a unit of measurement known as Specific Absorption Rate, or SAR. SAR limit is 2 watts/kilogram (W/kg)** averaged over ten grams of tissue.

SAR limit includes a substantial safety margin designed to assure safety of all persons, regardless of age/health. The value of SAR limit equals international guidelines recommended by ICNIRP***.

The highest SAR value for this mobile phone is 0.856 W/kg when tested for use at the ear.

While there may be differences between SAR levels of various phones at various positions, all meet MIC technical regulation. Although SAR is determined at highest certified power level, actual SAR of the phone during operation can be well below maximum value.

For more information about SAR, see the following websites:

- Ministry of Internal Affairs and Communications (MIC)
<http://www.tele.soumu.go.jp/e/sys/ele/body/index.htm>
- Association of Radio Industries and Businesses (ARIB)
<http://www.arib-emf.org/> (Japanese)

*Ministry of Internal Affairs and Communications

**The technical regulation is provided in Article 14-2 of the Ministry Ordinance Regulating Radio Equipment.

***International Commission on Non-Ionizing Radiation Protection

SoftBank Body SAR Policy

For body-worn operation, this mobile phone has been tested and meets RF energy exposure guidelines when used with an accessory containing no metal and positioning the handset a minimum 15 mm from the body. Use of other accessories may not ensure compliance with RF energy exposure guidelines.

For more information, see SOFTBANK MOBILE Corp. Website:

<http://www.softbankmobile.co.jp/ja/info/public/emf/emf02.html> (Japanese)

FCC RF Exposure Information

Your handset is a radio transmitter and receiver. It is designed and manufactured not to exceed the emission limits for exposure to radio frequency (RF) energy set by the Federal Communications Commission of the U.S. Government.

The guidelines are based on standards that were developed by independent scientific organization through periodic and thorough evaluation of scientific studies. The standards include a substantial safety margin designed to assure the safety of all persons, regardless of age/health.

The exposure standard for wireless handsets employs a unit of measurement known as the Specific Absorption Rate, or SAR. The SAR limit set by the FCC is 1.6 W/kg. The tests are performed in positions and locations (e.g. at the ear and worn on the body) as required by the FCC for each model.

The highest SAR value for this model handset as reported to the FCC when tested for use at the ear is 0.774 W/kg, and when worn on the body in a holder or carry case, is 0.296 W/kg.

Body-worn Operation: This device was tested for typical body-worn operations with the back of the handset kept 1.5 cm from the body. To maintain compliance with FCC RF exposure requirements, use accessories that maintain a 1.5 cm separation distance between the user's body and the back of the handset. The use of beltclips, holsters and similar accessories should not contain metallic components in its assembly.

The use of accessories that do not satisfy these requirements may not comply with FCC RF exposure requirements, and should be avoided. The FCC has granted an Equipment Authorization for this model handset with all reported SAR levels evaluated as in compliance with the FCC RF emission guidelines. SAR information on this model handset is on file with the FCC and can be found under the Display Grant section of <http://www.fcc.gov/oet/ea/> after searching on FCC ID V65OASY1.

Additional information on Specific Absorption Rates (SAR) can be found on the Cellular Telecommunications & Internet Association (CTIA) website at <http://www.phonefacts.net>.

European RF Exposure Information

Your mobile device is a radio transmitter and receiver. It is designed not to exceed the limits for exposure to radio waves recommended by international guidelines. These guidelines were developed by the independent scientific organization ICNIRP and include safety margins designed to assure the protection of all persons, regardless of age and health. The guidelines use a unit of measurement known as the Specific Absorption Rate, or SAR. The SAR limit for mobile devices is 2 W/kg and the highest SAR value for this device when tested at the ear was 0.871 W/kg*. As mobile devices offer a range of functions, they can be used in other positions, such as on the body as described in this User Guide. In this case, the highest tested SAR value is 0.760 W/kg. As SAR is measured utilizing the devices highest transmitting power the actual SAR of this device while operating is typically below that indicated above. This is due to automatic changes to the power level of the device to ensure it only uses the minimum level required to reach the network. The World Health Organization has stated that present scientific information does not indicate the need for any special precautions for the use of mobile devices. They note that if you want to reduce your exposure then you can do so by limiting the length of calls or using a hands-free device to keep the mobile phone away from the head and body.

* The tests are carried out in accordance with international guidelines for testing.

** Please see [Electromagnetic Safety](#) for important notes regarding body worn operation.

Water & Dust Resistance

Handset has waterproof ratings equivalent to IPX5 and IPX7 (External Device Port Cover and Battery Cover secure) (SoftBank testing). However failure to observe precautions given here may allow water, sand, foreign particles, etc. to enter handset and may cause handset to overheat, ignite, or cause electric shock, scratches, or malfunction. For safe handset use, first read precautions here.

IPX5 equivalent

Handset continues to function as a phone after being sprayed from all directions with 12.5 liters of water per minute from a 6.3 mm diameter nozzle for at least 3 minutes, from a distance of approximately 3 meters.

IPX7 equivalent

Handset continues to function as a phone without water intrusion after being slowly immersed in still tap water of room temperature to a depth of 1 meter, and left there for approximately 30 minutes before being removed again.

Meaning, . . .

handset can be used in rain (less than 20 mm per hour), bath room, kitchen, at poolside, etc.

Before Use

- Secure External Device Port Cover and Battery Cover to prevent water intrusion. Confirm that all closures are secure.

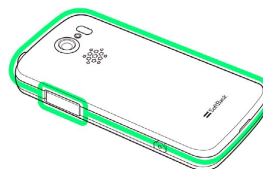

- Particles (hair, sand, etc.) lodged between joining surfaces may allow water intrusion.
- DO NOT open/close External Device Port Cover or Battery Cover if hands/handset is wet.
- Do not place handset directly on beach sand, etc. Exposing Mic/Receiver/Speaker, etc. to sand may reduce volume.
- Do not use submersed (including key operation).
- Do not expose to or immerse in liquid other than room temperature fresh water or tap water (soap/detergent/bath salt water, hot spring water, hot water, muddy water, sea water, pool water, alcohol, etc.).

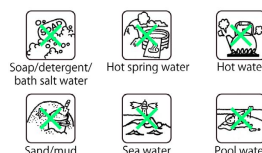

In Various Environments

- Rain
 - Do not use in heavy rain (20 mm or more per hour).
 - * Water remaining on Display may cause Touchscreen to malfunction.
 - DO NOT open/close External Device Port Cover or Battery Cover while exposed to rain or if hands are wet.
- Bath room
 - Do not immerse or drop in bathtub. Do not use submersed.
 - * Water remaining on Display may cause Touchscreen to malfunction.
 - Do not immerse in soap/detergent/bath salt water or hot spring water.
 - Do not expose directly to warm shower.
 - Do not expose to hot water.
 - Avoid prolonged use in bath room.
 - Use handset in temperatures between 5 °C–35 °C and humidity within 35%–90% (limited use in temperatures between 36 °C–40 °C).
- Kitchen
 - Do not expose to or immerse in liquid other than fresh water or tap water (water with soap/detergent or spices, or beverage).
 - Do not expose to or immerse in hot water or in chilled water.
 - Do not leave handset in extremely hot/cold locations, (e.g., near ovens/stoves or in refrigerators).
 - Do not subject handset to strong water pressure (more than 6 liters per minute).
- Poolside
 - Do not immerse or drop in pool water. Do not use submersed.
 - Pool water is chlorinated. If wetted with pool water, promptly wash off with room temperature tap water. Do not use a brush.
 - * Somewhat low water pressure (6 or less liters per minute)

Shared Precautions

- Close External Device Port Cover and secure Battery Cover with its rubber seal placed correctly. Lodged particles (lint, hair, sand, etc.) may allow water intrusion.
- Do not insert pointed object between External Device Port Cover/Battery Cover and handset. May scratch seal and allow water to enter.
- Do not open or close External Device Port Cover/Battery Cover while wearing gloves. Lodged particles (lint, hair, sand, etc.) from glove may allow water intrusion.
- Check handset and hands for moisture, sand, grime, etc. before opening or closing External Device Port Cover/Battery Cover. May enter handset or become lodged in closures, resulting in malfunction or water intrusion. Wipe hands with lint-free clean, dry cloth if necessary.
- Do not leave handset wetted. Water may enter from gaps. May also reduce volume. If wetted, [shake handset](#), and promptly remove as much water as possible with a lint-free clean, dry cloth. In cold regions, handset may freeze and cause malfunction.
- Handset is waterproof for only for fresh water/tap water. Not waterproof for hot water, salt water, soap water, chemicals, sweat, etc. If exposed to other types of moisture or sand/mud/etc., promptly wash off with room temperature tap water. Wash using hands (do not use brush) and hold External Device Port Cover and Battery Cover secured.
 - * Somewhat low water pressure (6 or less liters per minute)
- Do not expose to strong water pressure (e.g., tap/shower water that hurts) above rating (IPX5, IPX7) or immerse for extended period.
- Do not wash in a washing machine, ultra-sonic washing machine, etc.
- Do not subject to strong shock while submersed (e.g., drop into basin, toilet, washing machine with water).
- Handset accessories (AC Charger, etc.) are not waterproof.
- Do not insert pointed objects in holes of Mic, Receiver, or Speaker.
- External Device Port Cover and seal on back of Battery Cover are vital to waterproofing. Observe the following.
 - Do not remove or scratch.
 - Do not allow particles to adhere. Lodged particles (lint, hair, sand, etc.) may allow water intrusion. Always remove.
 - Remaining liquid other than fresh water or tap water (hot water, salt water, detergent water, chemicals, sweat, etc.) may degrade waterproofing.
 - Be careful sealing is not pinched when securing closures. Forcing closures with sealing pinched scratches sealing and may degrade waterproofing.
 - Replace waterproofing components every two years for waterproofing, regardless of appearance. Replacement can be provided at cost while handset is retained. Visit a SoftBank shop or contact [SoftBank Customer Support](#).
- Do not drop or otherwise subject handset to strong shock. May degrade waterproofing.
- Handset will not float.
- Do not immerse in hot water, use in a sauna, or subject to hot air from a hair dryer, etc.
- Use handset in temperatures between 5°C–35°C and humidity within 35%–90% (limited use in temperatures between 36°C–40°C). Use in extremes beyond these ranges may degrade waterproofing.

- Sudden temperature change results in condensation. Let handset reach room temperature before moving from cold to hot places (e.g., shower/bath) to prevent condensation. Handset has no anti-condensation features.
- * If condensation forms inside Display, leave at room temperature until condensation dries.
- Handset fulfills performance requirements for assumed usage. However, handset is not guaranteed for any and all conditions of actual usage. Malfunction determined to be due to mishandling is not covered under warranty.

If Exposed to Water

Using a wet handset allows water to collect in Mic, Receiver, Speaker, or Audio Port. This may affect call quality, wet your clothing, carrybag, etc., or allow water into handset. Follow steps below to drain water.

1

Wipe handset with a lint-free clean, dry cloth



2

Shake handset as shown until there is no more wetting

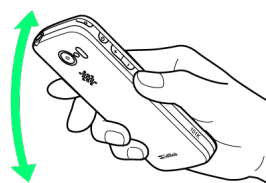

3

Press a lint-free clean, dry cloth into gaps (Mic, Receiver, Speaker, etc.) to remove any water

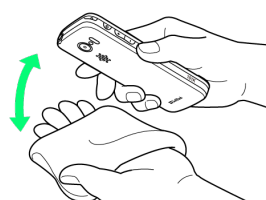

4

After removing as much water as possible, leave handset at room temperature for at least 1 hour

- Some water may still remain in handset. Do not leave handset beside/in items that you do not want to get wet (clothing, carrybag, etc.).

When Charging

Accessories (included or sold separately) are not waterproof. Check the following before and after charging.

- Check that handset is not wetted. If wetted, drain water and wipe with a lint-free clean, dry cloth before opening External Device Port Cover.
- If charging after handset is wetted, drain water and wipe with a lint-free clean, dry cloth before opening External Device Port Cover.
- Never charge while handset is wet. Charging while wet may result in malfunction, overheating, etc.
- Do not touch AC Charger/Micro USB Cable (sold separately) with wet hands. May cause electric shock.
- Use AC Charger/Micro USB Cable (sold separately) where not exposed to water. May cause fire or electric shock.
- Do not use AC Charger/Micro USB Cable (sold separately) near water sources (bath room/shower, sinks/basins, etc.). May cause fire or electric shock.

101K User Guide Index

A

About Phone.....	66
Accounts & Sync.....	63
Activating Screen Lock.....	27
Address Book.....	38
Android Market™.....	24
Applications.....	62

B

Basic Operations.....	20
Battery Installation.....	12
Bluetooth®.....	53

C

Call.....	60
Calling.....	34
Calling Outside Japan.....	56
Charging Battery.....	14
Creating/Sending Gmail.....	42
Customer Service.....	71

D

Date & Time.....	65
------------------	----

G

General Notes.....	82
Google Account.....	23

H

Handset Phone Number.....	21
Home Screen Basics.....	30

I

Image Files.....	50
Imaging.....	46
Internet Mail Settings.....	43
Introduction.....	3

L

Language & Keyboard.....	64
--------------------------	----

M

Materials.....	70
Messaging.....	40
Mobile Manners.....	21
Music Files.....	50

N

Notifications Window.....	31
---------------------------	----

O

Optional Services.....	35
------------------------	----

P

Package Contents.....	6
Parts & Functions.....	6
Power On/Off.....	16
Privacy.....	64
Profile.....	58

S

Safety Precautions.....	74
SD Card Installation.....	9
Security Codes.....	26
Sending SoftBank Mail.....	40
Software Updates.....	28
Sound.....	61
Specifications.....	70
Status Bar.....	30

T

Text Entry.....	22
Touchscreen Operations.....	16

U

USIM Card Installation.....	7
USIM PIN.....	26

W

Water & Dust Resistance.....	87
Water Resistance.....	15
Web Browsing.....	43
Wi-Fi.....	52
Wireless & Networks.....	58

SoftBank 101K User Guide

February 2012, First Edition
SOFTBANK MOBILE Corp.

Visit SoftBank Shop for assistance

Model : SoftBank 101K
Manufacturer : KYOCERA Corporation