

motorola razr 50s
User Guide

motorola razr 50s User Guide Contents

Introduction	
About the User Guide.....	3
Getting Started	
Parts & Functions.....	6
eSIM.....	7
USIM Card.....	11
Charging Battery.....	12
Power On/Off.....	13
Making Initial Settings.....	13
Setting a Google Account.....	16
Unlocking Screen.....	20
Basic Operations	
Basic Operation.....	24
Using Touchscreen.....	24
Silent Mode.....	25
Airplane Mode.....	26
Text Entry.....	27
Updating Software.....	28
Handset Interface	
Handset Screens.....	32
Status Bar.....	33
Using Notifications Window.....	34
Using Quick Settings.....	34
External Display.....	36
Phone	
Placing/Answering Calls.....	38
Optional Services.....	41
Phone Number.....	46
Using Contacts.....	46
Messaging	
Sending Messages (+Message).....	50
Using Gmail.....	51
Internet	
Using Chrome.....	54
Camera	
Capturing Still Images/Videos.....	58
Viewing Still Images/Videos (Photos).....	60
Application Basics	
Applications.....	62
Adding Applications.....	63
Wi-Fi/Bluetooth	
Connecting by Wi-Fi.....	68
Using Bluetooth® Function.....	69

Handset Settings

Handset Settings.....	72
Data Usage Settings.....	73
Display Settings.....	74
Home & lock screen Settings.....	74
Sound & vibration Settings.....	76
Battery Settings.....	77
Security & privacy Settings.....	77
System Settings.....	80
Other Settings.....	80

Global Services

Global Roaming.....	88
Making Calls while Abroad.....	89

Warranty/Specifications/Customer Service

Warranty & After-Sales Service.....	94
Specifications.....	94
Customer Service.....	95

Safety Precautions

Safety Precautions.....	98
Material List.....	106
Important Product Information.....	107
Bluetooth®/Wi-Fi (WLAN).....	109
Cautions on Water Resistance.....	110
Intellectual Property Rights.....	112
RF Exposure Information of This Product.....	114

About the User Guide

Most operation descriptions are based on default settings. Unless noted otherwise, descriptions are for Home Screen. Some operation descriptions may be simplified.

Before Using This Product

Read "Quick Start" and "[Safety Precautions](#)" on the User Guide thoroughly for proper usage.

Accessible services may be limited by subscription contract conditions.

Data Communication

- Handset is designed to be always connected to the Internet. Some functionality, such as data syncing, initiate transmission automatically.
- Large-volume data communication (application downloads, video viewing, etc.) incur expensive transmission fees. Subscription to a flat-rate data plan is strongly recommended.
- Depending on applications and services used, transmission fees may be incurred even while connected by Wi-Fi®.

Screenshots & Key Labels

Screenshots in the User Guide may differ in appearance with actual Display. Key labels in the User Guide are simplified for description purposes and differ with actual Display.

Other Notations

In the User Guide, the product is referred to as "handset." "A402MO" here refers to this mobile phone "motorola edge 50s pro."

Getting Started

Parts & Functions.....	6
eSIM.....	7
USIM Card.....	11
Charging Battery.....	12
Power On/Off.....	13
Making Initial Settings.....	13
Setting a Google Account.....	16
Unlocking Screen.....	20

Parts & Functions

Handset (Front)

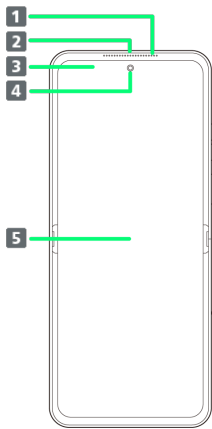

Part	Description
1 Earpiece/ Speaker	Hear the other party's voice. Listen to music, video, and other audio when playing back media.
2 Proximity Sensor	Detects closeness to ear during a call, and to turn Display on or off.
3 Environmental Light Sensor	Use to adjust brightness of Display automatically.
4 Front Camera	Use to shoot photos or videos of yourself.
5 Display	Handset uses a touchscreen-type Display. Operate with your fingers on Display.

! Display Cautions

A screen protector is adhered to Display. Removing this screen protector or adhering an other-brand protective film, etc. will void the warranty.

Handset (Back/Side)

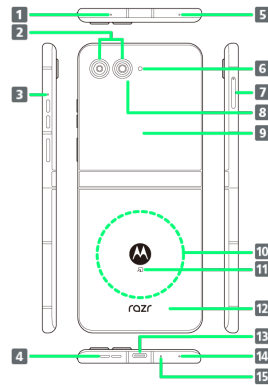

Item	Description
1 Vent Hole (for adjusting air pressure)	Use to adjust air pressure.
2 Rear Camera	Capture still images and videos.
3 Mic	Use when capturing videos or calling using speakerphone.
4 Speaker	Listen to music, video sound, etc.
5 Mic	Use when capturing videos or calling using speakerphone.
6 LED Flash	Use as a light when taking photos, etc.
7 SIM Card Tray	Install/remove USIM Card.
8 Proximity/ Environmental Light Sensor	Detects closeness to ear during a call, to turn Display on or off, and automatically adjust Display backlight.
9 External Display	Handset uses a touchscreen-type External Display. Operate with your fingers on Display.
10 Wireless Charging Position	Position wireless charger.
11 NFC FeliCa Touchpoint	Hold up to a reader/writer to use NFC/Osaifu-Keitai®.
12 Back Cover	Back Cover on handset is not removable.
13 USB Type- C™ Port	Connect USB Type-C cable, etc.
14 Vent Hole (for adjusting air pressure)	Use to adjust air pressure.
15 Mic/ Recorder Mic	Speak here. Use as a mic when capturing videos.

Handset Keys

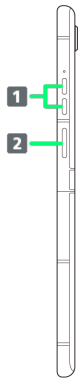

Part	Description
1 Volume Key (Up/Down)	Adjust Volume.
2 Power Key/ Fingerprint Sensor	Turn Display on/off. Press and Hold to power on or open Google™ Assistant. Unlock screen with fingerprint authentication.

eSIM

eSIM is an integrated SIM already built into handset. An eSIM-capable handset allows you to use a phonenumber simply with a contract subscription and configuring handset, without the needed replacement of USIM cards.

Handling eSIM

For eSIM handling, see the following website.

<https://www.softbank.jp/mobile/support/product/sim/esim/> (Japanese)

Downloading eSIM

1

Flick Home Screen up → (Settings) → Network & internet

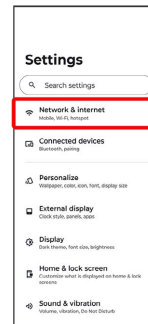

2

SIMs & mobile network

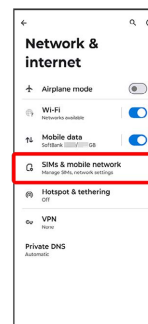

3

Download new SIM

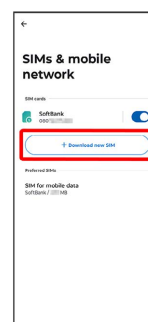

4

Set up an eSIM

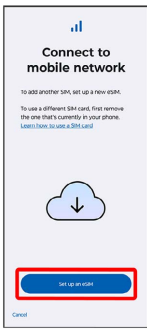

5

Scan the QR code



- Handset may not display the above step, and instead go to the next step, depending on your conditions of usage.

6

Set up



7

Enter a verification code → Continue

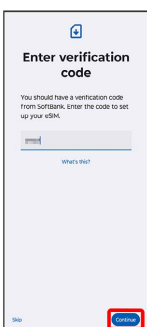

8

Close

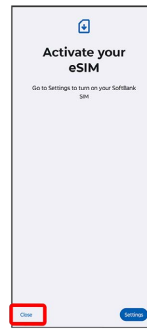

🚩 eSIM download is completed.

- Tap **Settings** to enable eSIM. Continue by following onscreen instructions.

Enabling/Disabling eSIM

1

Flick Home Screen up → (Settings) → Network & internet

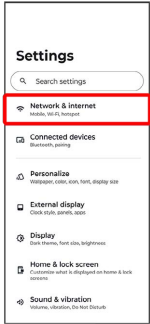

2

SIMs & mobile network

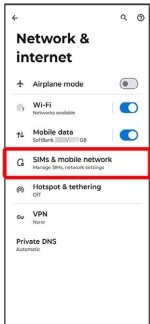

3

Select eSIM

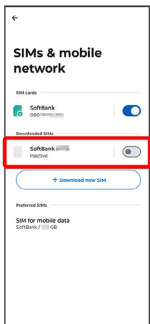

4

Use SIM

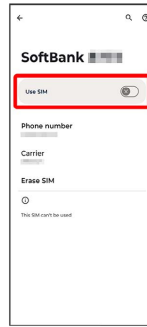

5

Turn on

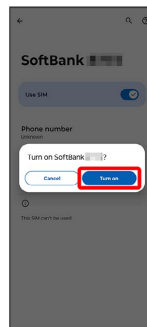

 eSIM changes between enabled and disabled.

· If no USIM Card is installed, go to step 4 .

Erasing eSIM

1

Flick Home Screen up → (Settings) → Network & internet

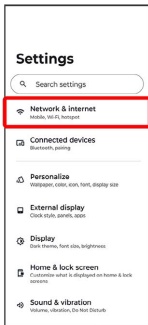

2

SIMs & mobile network

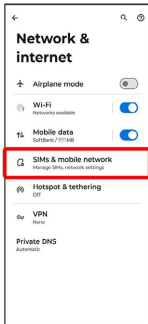

· If no USIM Card is installed, go to step 4 .

3

Select eSIM

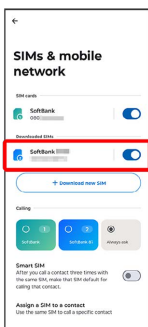

4

Erase SIM

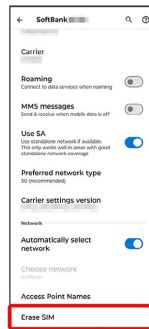

5

Erase

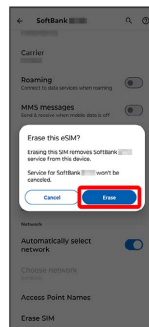

 eSIM is erased.

 After Erasing eSIM

To use an eSIM again after having erased it, the QR code for downloading an eSIM must be reissued.

Erasing an eSIM does not cancel your subscription contract.

USIM Card

USIM Card is an IC card containing phone number and other customer information.

Handling USIM Card

For USIM Card handling, see following items.



1 IC chip

For USIM Card handling, see following SoftBank Mobile Website.

<https://www.softbank.jp/mobile/support/protect/usim/> (Japanese)

- Always keep the IC chip clean.
- Wipe clean with a dry, soft cloth.
- Avoid applying labels. May damage USIM Card.

USIM Card Cautions

Observe the following when using USIM Card.

- Customer is responsible for any damage caused by inserting USIM Card in an other-brand IC card reader, etc. The company is not responsible in such case.
- USIM Card is the property of the company.
- USIM is replaceable (at cost) in case of loss/damage.
- Return USIM Card to the company when cancelling subscription.
- Returned USIM Cards are recycled for environmental purposes.
- Note that USIM Card specifications and performance may change without notice.
- It is recommended that you keep a separate copy of information that is stored on USIM Card. The company is not responsible for damages from stored information that is lost.
- Always follow emergency procedures to suspend service if your USIM Card or handset (USIM Card inserted) is lost/stolen. For details, contact [Customer Service](#).
- Always power off handset before inserting/removing USIM Card.
- Some services, functions, etc. may have restrictions when an other-carrier USIM card is used. SoftBank Corp. does not guarantee operation whatsoever.

Inserting USIM Card

Always power off beforehand.

1

Insert SIM Removal Pin (complimentary sample) in hole in SIM Card Tray

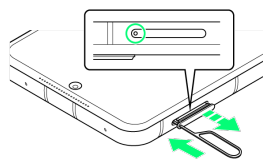

2

Pull out SIM Card Tray



3

Set USIM Card in SIM Card Tray

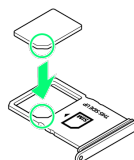

- Place gently, noting orientation of USIM Card (notch/IC (gold) chip facing down).
- Make sure USIM Card is in SIM Card Tray securely.

4

Insert SIM Card Tray in SIM Card Tray Slot straight

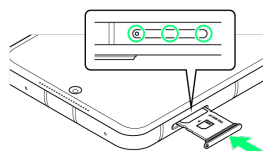

USIM Card is inserted.

- Press firmly where circled , and make sure there is no gap between handset and SIM Card Tray.

Removing USIM Card

Always power off beforehand.

1

Insert SIM Removal Pin (complimentary sample) in hole in SIM Card Tray

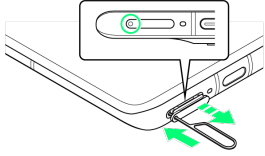

2

Pull out SIM Card Tray

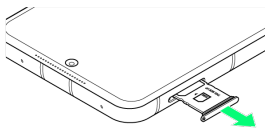

3

Remove USIM Card from SIM Card Tray

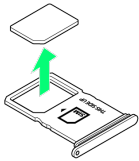

4

Insert SIM Card Tray in SIM Card Tray Slot straight

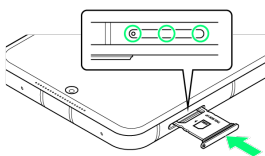

🚩 USIM Card is removed.

- Press firmly where circled ○, and make sure there is no gap between handset and SIM Card Tray.

Charging Battery

⚠️ Charging Cautions

Never connect USB Type-C plug while handset or peripheral equipment is wet.

Charging with AC Charger

AC Charger is an optional accessory. Be sure to use an AC Charger specified by SoftBank. For information on AC Charger and other peripheral devices, see SoftBank Website. Charging with AC Charger (USB Type-C™ rapid charging AC Charger with USB PD-PPS capability [ZSDBAV] (SB-AC22-TCPD)) is described as an example.

1

Insert USB Type-C plug of AC Charger into USB Type-C Port

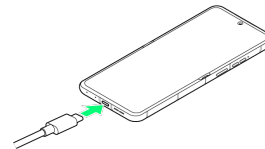

2

Unfold power plug of AC Charger and plug into household AC

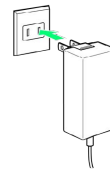

🚩 Charging starts.

3

When charging is complete, unplug AC Charger and remove USB Type-C plug of AC Charger from handset

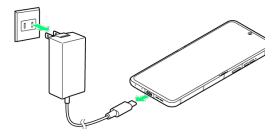

🚩 Charging ends.

Power On/Off

Powering On

1

Power Key (Press and Hold)

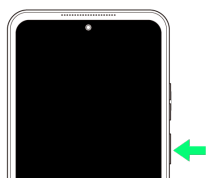

Lock Screen appears.

- For details on unlocking screen, see "[Unlocking Screen.](#)"
- Startup screen appears the first time handset is powered on. For details on initial settings, see "[Making Initial Settings.](#)"

Powering Off

1

Press Power Key and Volume Up Key



2

Power off

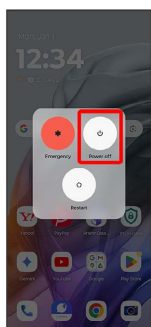

Handset powers off.

Making Initial Settings

When powering on the first time, an initial settings wizard appears for optionally making Wi-Fi, Google account, and other settings. Follow onscreen instructions to set items. To use USIM Card, insert USIM Card before powering on handset.

! eSIM Cautions

When using eSIM, do the following before powering on.

- Remove USIM Card from handset.
- Make sure that handset can connect to the Wi-Fi network.
- Have the QR code ready for eSIM registration.

Making Initial Settings

1

日本語 (日本) → English → United States → Start

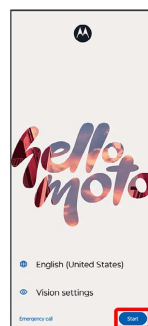

2

Follow onscreen instructions to transfer settings or data

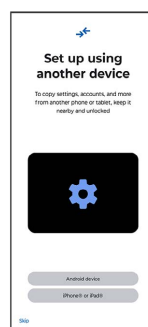

- Tap **Android device** / **iPhone® or iPad®** to copy settings or accounts from another handset, etc., and follow onscreen instructions.
- If not copying settings or accounts from another handset, etc., Tap **Skip**.

3

Follow onscreen instructions to set Wi-Fi



- To skip Wi-Fi settings while using USIM Card, Select **Use mobile network for setup** / **Set up offline** Continue by following onscreen instructions.

4

Make settings for privacy and security → **Accept & continue**

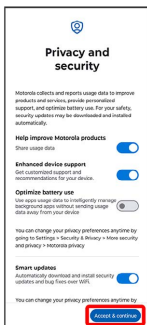

5

Follow onscreen instructions to set a Google account

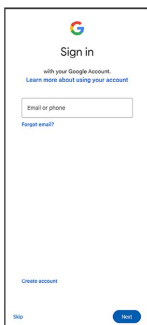

- For details on Google accounts, see "[Setting a Google Account.](#)"
- If not making Google account settings, Tap **Skip** → **Skip**

6

Select items to set → **I agree**

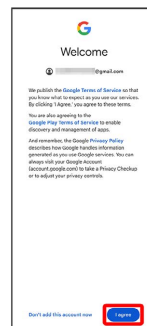

7

Follow onscreen instructions to set screen lock / unlocking using fingerprint

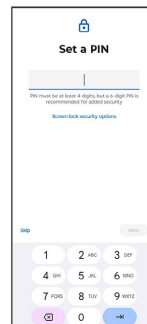

- If not making settings, Tap **Skip** → **Skip**

8

Follow onscreen instructions to transfer data

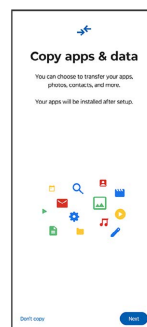

- If not copying data from another handset, etc., Tap **Don't copy**
- To copy data from another handset on which a Google account is set, Tap **Next**, then follow onscreen instructions.

9

Follow onscreen instructions to set Google Assistant, etc.

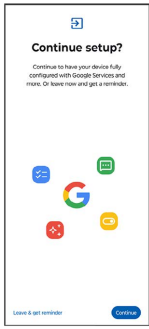

To complete setup later, Tap **Leave & get reminder**.

10

OK

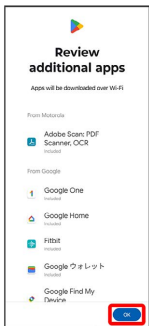

11

Follow onscreen instructions to stay in touch with Motorola

Next

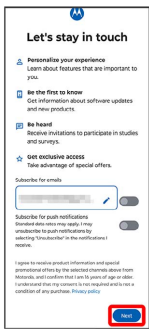

12

Next

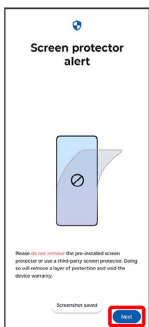

13

Next



14

Follow onscreen instructions to set Glance **Next**

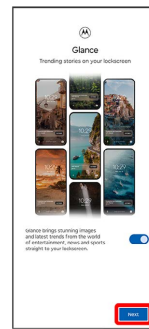

If confirmation appears, follow onscreen instructions. See "[Changing Glance Settings](#)" for details on Glance.

15

Set the style of navigation bar **Next**



Select the theme → Next

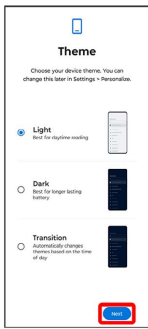

Settings are complete.

- If confirmation appears, follow onscreen instructions.

Setting a Google Account

Use a Google account and get more convenience with Google services. A Google account is required to use some services or fully use some applications.

! Google Account Cautions

Be careful not to forget your Google account mail address or password.

Creating a Google Account

1

Flick Home Screen up

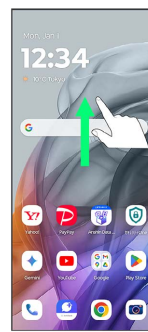

2

(Settings)

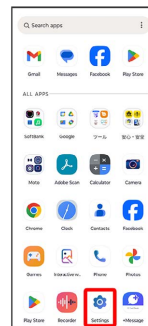

3

Passwords & accounts

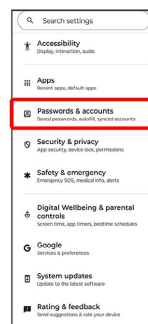

4

Add account

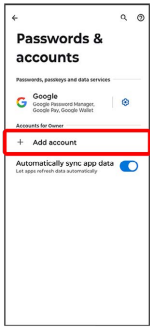

5

Google

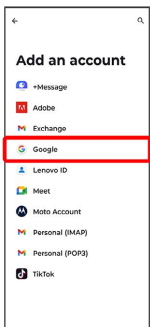

Window for logging in to a Google account opens.

6

Create account



7

For my personal use

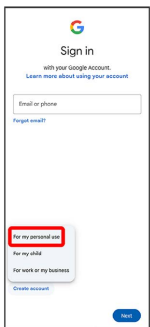

8

Enter first name → Enter last name → Next

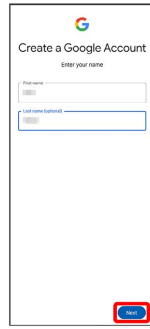

9

Enter date of birth and gender → Next



10

Select mail address → Next



To create a Gmail™ address, Create your own Gmail address → Enter username (mail address) → Next .

11

Enter password → Next

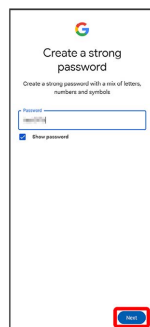

Yes, I'm in



- If not adding a phone number, Tap **Skip**.
- To set how your phone number will be used if adding one, Tap **More options**. Continue by following onscreen instructions.

Next



Check the privacy policy and terms of usage, **I agree**

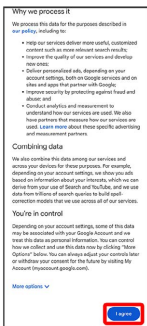

Set Google service → **Accept**

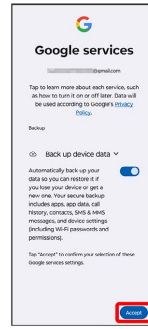

 Account is created.

Logging In with a Google Account

1

Flick Home Screen up

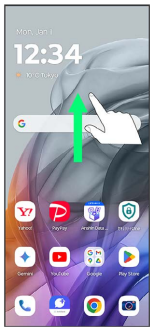

2

(Settings)

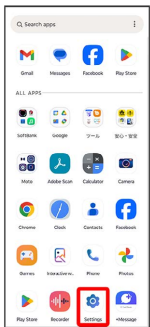

3

Passwords & accounts

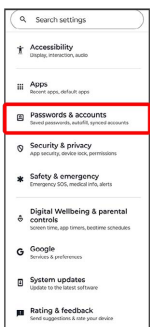

4

Add account

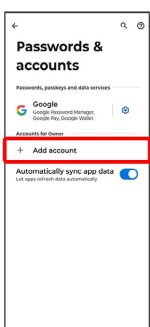

5

Google

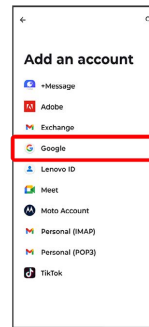

Window for logging in to a Google account opens.

6

Enter mail address → Next

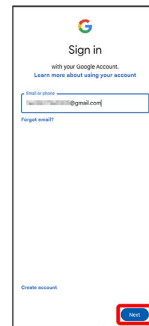

7

Enter password → Next



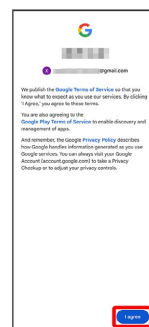

8

I agree

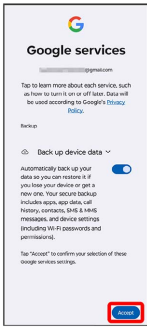

Set Google service → **Accept**



 You are logged in to your Google account.

Unlocking Screen

Screen Lock

Display goes out after a set period of inactivity to save battery power (screen locked).

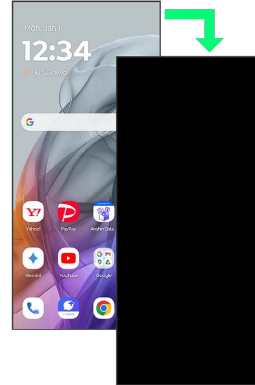

• Press Power Key while Display is on to lock screen manually.



When Screen Locks during Music Playback

Music playback continues. While Display is off (screen is locked), Press Power Key to use operation panel in Lock Screen (operation may differ with application).

Unlocking Screen

1

When screen is locked, Power Key

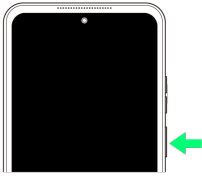

Lock Screen appears.

2

Flick lock screen up



Screen is unlocked.

· The method for unlocking the screen can be changed.

Basic Operations

Basic Operation.....	24
Using Touchscreen.....	24
Silent Mode.....	25
Airplane Mode.....	26
Text Entry.....	27
Updating Software.....	28

Basic Operation

Selecting Options and Navigating Screens

Tap items, icons, onscreen keys, etc. to open assigned items.

- Tap  to go back to previous screen.

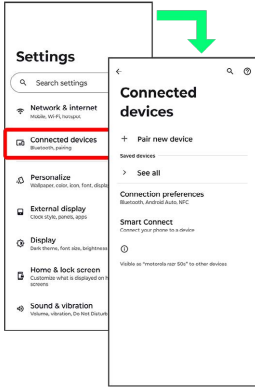

Menu Operations

1

Tap  for available settings and items.

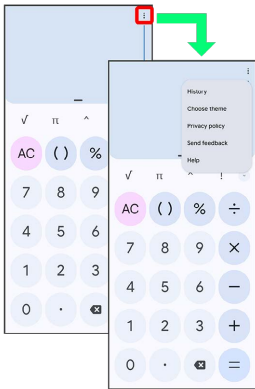

2

Screens may also have settings and items that are available by Touching & Holding Display.

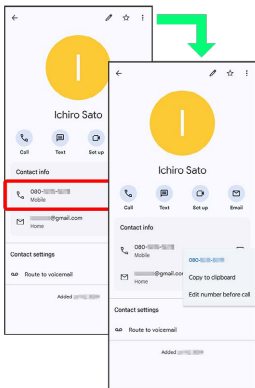

Using Touchscreen

Handset uses a touchscreen-type Display. Operate with your fingers on Display.

Tap

Contact Display lightly and briefly.

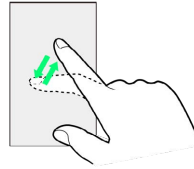

Touch & Hold

Touch screen lightly and hold it for a while. When the screen changes, release finger.

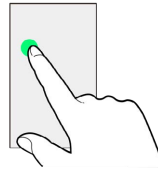

Drag

Touch icon or other item lightly, move it where desired, and release finger.

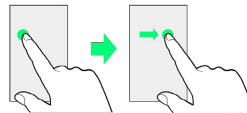

Swipe/Flick

Contact Display lightly, then brush screen up/down or left/right.

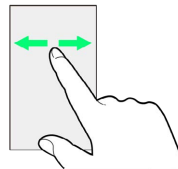

Pinch/Spread

Contact Display lightly, then close/widen fingers.

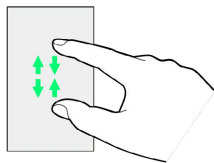

Silent Mode

Mute ringtones and other handset sounds to avoid disturbing others around you.

! Do Not Disturb (Vibration/Mute) Cautions

Camera shutter, video start/stop tones, alarms, media, etc. sound even in Do Not Disturb (vibration/mute).

- Alarms and media can be muted with "Do Not Disturb (Silent mode)" setting. For details, see "[Sound & vibration Settings](#)."

Entering Do Not Disturb (Vibration)

1

Press Volume Key



2

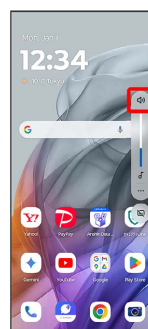

Icon changes to , and handset enters Do Not Disturb (vibration).

Entering Do Not Disturb (Mute)

1

Press Volume Key



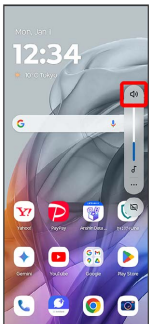

2

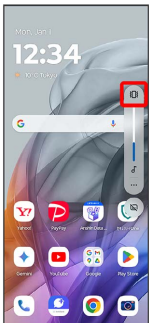

3

While volume adjustment bar is shown, 



 Icon changes to , and handset enters Do Not Disturb (mute).

Airplane Mode

Disable all functions that emit signals. Handset remains powered on.

Using Airplane Mode

1

Flick Status Bar down

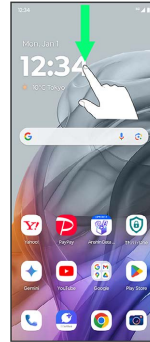

 Notifications Window opens.

2

Flick Notifications Window down

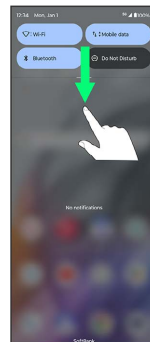

 Quick Settings open.

3

Flick Quick Settings left

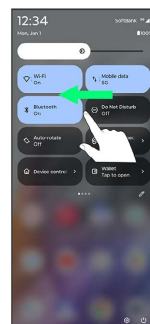

4

Airplane mode (On)

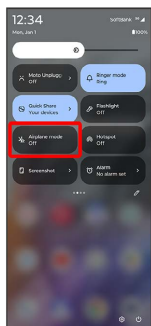

 Handset is in Airplane mode.

- Use same operation again while in Airplane mode to cancel.

Text Entry

Keyboards

Use onscreen keyboards in Display for text entry.

In 12 keys keyboard, multiple characters are assigned to each key. In QWERTY and other keyboards, a single letter is assigned to each key. "Handwriting" for entering handwritten characters is also available.

- To hide keyboard, Tap .

+ Keyboard Operations

Setting Keyboard to Use

In a text entry window,   Languages  English (US)  Select keyboard  Done

- Set several keyboards.

Switching Keyboards

Set several keyboards to switch between.

In a text entry window, 

- Alternatively, Long Press   Tap keyboard to switch to.

QWERTY Keyboard Layout

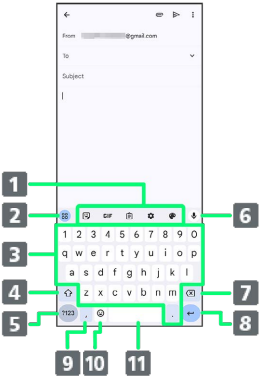

- 1 Show shortcuts for frequently used functions (Toolbar).
- 2 Show icons not displayed on Toolbar.
- 3 Enter characters.
- 4 Switch between all lower case and sentence case. Double-Tap for all upper case.
- 5 Toggle entry modes.
- 6 Use voice input.
- 7 Delete character to left of cursor.
- 8 Insert line break; confirm current characters Touch & Hold to set one-handed mode.
- 9 Enter a comma. Touch & Hold to show character input setting screen or to set one-handed mode.
- 10 Show emoji, emoticons, etc. With several set keyboards, to switch between keyboards.
- 11 Enter a space.

Switching Character Types (Entry Modes)

1

In QWERTY keyboard, Tap



- Entry mode switches.
- To enter more symbols, Tap .
- Tap to back to alphabet mode.

Updating Software

Automatically download the latest software via the Internet. Software is updated when handset restarts at a specified time.

Before Updating Software

Saved data may be lost depending on condition of handset (malfunctioning, damaged, water seepage, etc.). It is recommended that you back up important data regularly. SoftBank Corp. is not responsible for damages from loss of data.

Software Update Cautions

During Update

Never remove USIM Card or power off handset during a software update. Doing so may cause the update to fail. A software update failure may disable handset. If handset becomes disabled, contact [Customer Service](#).

Signal during Update

Operate handset where signal reception is good and without changing location. Also operate with adequate battery charge. Signal becoming weak or Battery becoming low during an update may cause an update failure. An update failure may disable handset.

Enabling Smart Updates

Set handset to automatically download software updates when available.

1

Flick Home Screen up (Settings)

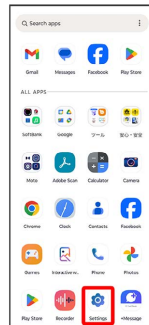

2

System updates → Smart updates

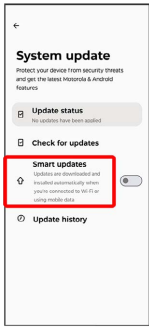

Smart update details open.

3

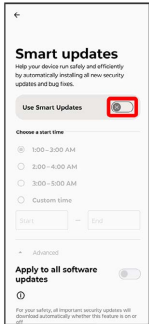

Smart updates are enabled.

+ Setting Time to Restart

Select restart time in smart update details.

• For **Custom time**, set start time → **OK**.

Updating Software Manually

Check for software updates, and update manually as required.

1

Flick Home Screen up, → (Settings) → System updates

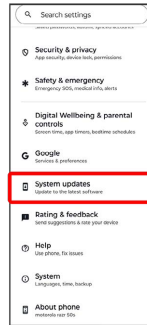

2

Check for updates

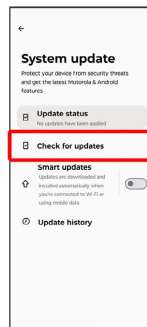

3

Update now



The latest software is installed.

• If confirmation appears, follow onscreen instructions.

Restart now



🚩 Handset restarts, and software is updated.

Handset Interface

Handset Screens.....	32
Status Bar.....	33
Using Notifications Window.....	34
Using Quick Settings.....	34
External Display.....	36

Handset Screens

Home Screen Layout



Item	Description
1 Status Bar	Flick down for Notifications Window. Flick down using two fingers for Quick Settings.
2 Customize Area	Place application shortcuts, folders, widgets freely.
3 Favorites Tray	Place application shortcuts, folders, etc. Appears even when Home Screen sheets toggled.
4 Navigation Button	Tap icons to access functions. For Navigation Button, see " Navigation Button ."

Toggling Home Screen Sheets

When there are several Home Screen sheets, Flick Home Screen left/right to toggle sheets.

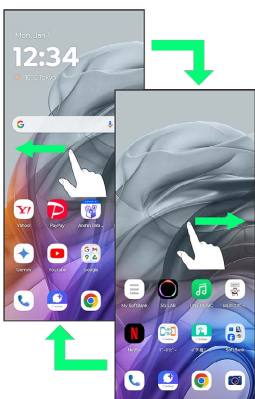

Navigation Button

Tap Navigation Buttons at Display bottom for functions/operations. for functions/operations. Also use gesture action. For details, see "[Gestures Settings](#)."

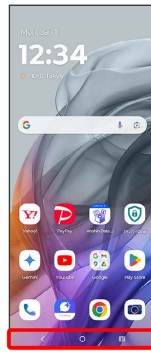

Item	Description
(Back)	Return to previous screen. Appears as <input checked="" type="checkbox"/> for onscreen keyboard; Tap to close keyboard.
(Home)	Return to Home Screen. Touch & Hold for Google Assistant.
(Recent apps)	Show history of used applications to activate /exit them.

Portrait Orientation & Landscape Orientation

appears at Display bottom when handset is rotated horizontally. to change screen to landscape orientation. To change to portrait orientation, rotate handset vertically and Tap .

Set "Auto-rotate screen" to on to change screen to landscape orientation automatically when handset is rotated horizontally. For details on Auto-rotate screen, see "[Display Settings](#)."

· Depending on the current screen, the orientation may not change even by changing handset orientation.



Status Bar

Status Bar appears at the top of Display. Notification Indicators for new mail, etc. and Status Indicators for handset appear here.

Status Bar Layout

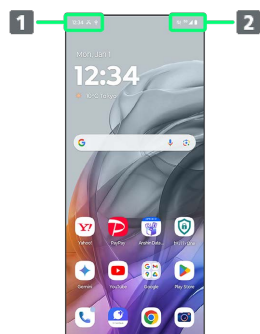

- 1 Notification Indicators
- 2 Status Indicators

Main Notification Indicators

Notification Indicators appearing in Status Bar include the following.

Indicator	Description
	New Gmail
	New Text Message (SMS) / +Message
	Error/Caution
	Wi-Fi Open Network Available
	USB Device Connected
	Call Arriving/Calling/Dialing
	Call on Hold
	Missed Call
	New Message (Voicemail)
	Calendar Event Notification
	Alarm Sounding/Snoozing/Unchecked Alarm/Next Alarm
	Timer Running
	Stopwatch Running
	New Emergency Alerts
	Data Uploading
	Data Downloading
	Application Update Available
	Application Installation Complete
	Sharing File via Bluetooth®
	Low Battery Alert (20% or less)
	Smart Update Notification

Main Status Indicators

Status Indicators appearing in Status Bar include the following.

Indicator	Description
	Bluetooth® Connected
	Do Not Disturb (Silent Mode)
	Do Not Disturb (Vibration)
	Do Not Disturb (Mute)
	Voice Service and Data Communication Available (5G) ^{1, 2}
	Voice Service and Data Communication Available (4G LTE/4G) ^{2, 3}
	Wi-Fi Connected
	Roaming
	Voice Service Unavailable
	Voice Service and Data Communication Unavailable
	Out of Service Area/Searching for Network
	Airplane mode
	Charge Battery
	Battery Low
	Battery Charged
	Charging
	Battery Saver Set
	Obtaining Location
	Alarm Set
	NFC On

- 1 Although "5G" may appear in standby (top of Display), this may change to "4G" with data communication then being by the 4G network.
- 2 If "5G" or "4G" does not appear, data communication is unavailable regardless of if appears.
- 3 Handset supports FDD-LTE (SoftBank 4G LTE) and AXGP (SoftBank 4G); indicator appears when handset is connected to either. Handset connects to SoftBank 4G first.

Using Notifications Window

Flick Status Bar down to open Notifications Window. Open Notification Indicators to check details.

Opening Notifications Window

1

Flick Status Bar down

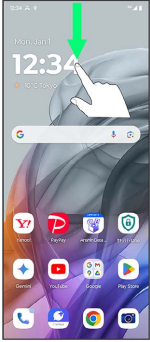

Notifications Window opens.

+ Closing Notifications Window

Flick screen up

Notifications Window Layout

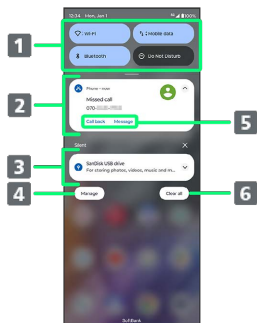

- 1 Show portion of Quick Settings
- 2 Show notifications (incoming calls, etc.) and active functions
- 3 Show silent notifications
- 4 Manage notifications
- 5 Use notification details¹
- 6 Delete all notifications²

- 1 Available applications depend on notification.
- 2 Some notifications may not be deleted.

Using Quick Settings

Flick Notifications Window down to access Quick Settings. Tap icons to toggle functions on/off, etc.

Open Quick Settings

1

Flick Status Bar down

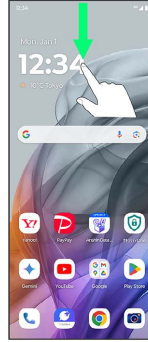

Notifications Window opens.

2

Flick Notifications Window down



Quick Settings open.

- Alternatively, Flick Status Bar down using two fingers.

+ Quick Settings

Closing Quick Settings

Flick screen up

Arranging Quick Settings

Add, delete, and change order of functions in Quick Settings.

In Quick Settings, Follow onscreen instructions and Drag icon

Quick Settings Layout

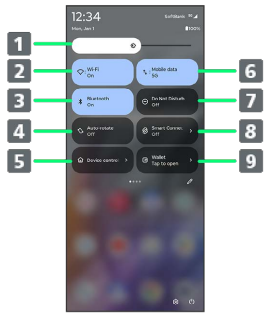

- 1 Adjust brightness
- 2 Wi-Fi on/off
- 3 Bluetooth® on/off
- 4 Auto-rotate on/off
- 5 Open Device controls settings
- 6 Mobile data on/off
- 7 Do Not Disturb (Silent mode) on/off
- 8 Open Smart Connect
- 9 Open Wallet

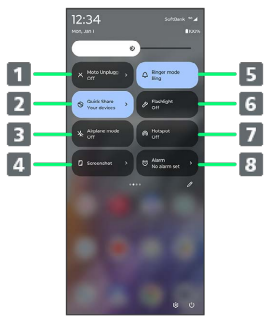

- 1 Open Moto Unplugged
- 2 Quick Share settings
- 3 Airplane mode on/off
- 4 Capture Screenshot
- 5 Ringer mode settings
- 6 Flashlight on/off
- 7 Hotspot on/off
- 8 Alarm settings

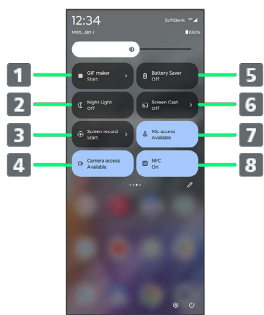

- 1 Open GIF maker
- 2 Night Light on/off
- 3 Screen record start/stop
- 4 Set permission to access Camera
- 5 Battery Saver on/off
- 6 Show cast screen
- 7 Set permission to access Mic
- 8 NFC on/off

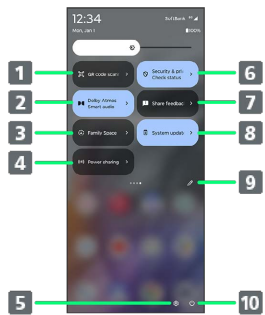



- 1 Open to scan QR code
- 2 Open Dolby Atmos settings
- 3 Open Family Space
- 4 Power sharing on/off
- 5 Show handset settings
- 6 Check security & privacy status
- 7 Send feedback
- 8 Check system updates
- 9 Edit Quick Settings
- 10 Show power menu

External Display

Use External Display when handset is closed. Access apps or widgets quickly by using External Display.

Press Power Key, Tap External Display, or Cover it by hand while Display is off to turn on Display for operation.

Flick Home Screen up,   (Settings)  **External Display** to check how to operate External Display or change what is shown on screen. See "[External display Settings](#)" for details.

Checking Notifications on External Display

How to use a notification for a new call is described as an example.

1

Tap notification on lower left



 List of notifications appears.

2

Tap 

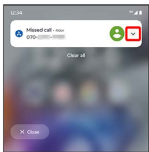



 Notification details open.

· Click a notification to delete left or right, or Tap **Clear all** to delete a notification. Deletion may not be possible depending on notification details.

3

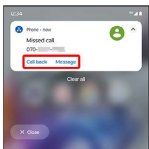
Tap operation



 Tap **Call back** to dial or Tap **Message** to send +Message/SMS to phone number that call was from.

Opening Quick Settings from External Display

1

Flick screen down

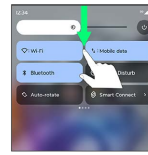



 Quick Settings open.

2

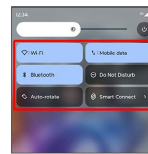
Tap icon of function to set



 Toggle function on/off, etc.

- Flick left/right to toggle screens.
- Tap  to power off or restart handset.

Phone

Placing/Answering Calls.....	38
Optional Services.....	41
Phone Number.....	46
Using Contacts.....	46

Placing/Answering Calls

How to dial directly to make a call and answer a call, as well as options when a call is arriving/during a call are described.

Phone Function

Emergency Location Report

Making emergency calls (110, 119 or 118) automatically reports handset location to corresponding agency (police, etc.). This system is referred to as Emergency Location Report, and notifies location based on positioning from base stations.

- Location Report does not incur registration/transmission fees.
- Location/signal conditions affect positioning accuracy. Always provide location and call purpose.
- Hiding Caller ID (using 184, etc.) cancels Location Report. However, corresponding agency may obtain location information in life threatening situations.
- Location Report is not sent for calls made while outside Japan.

VoLTE/VoLTE (HD+) and HD Voice

Handset supports VoLTE/VoLTE (HD+) and HD Voice for higher voice call quality.

Hints

Q. Difficulty during call

- A. It may not be possible to make a call properly in a noisy location.
- A. When calling using Speaker, check the call volume. Raising the call volume may make calling difficult.

Q. Sound pops momentarily during a call

- A. Are you changing location while calling? Sound pops when signal is weak and handset switches to a different area.

Areas Where Emergency Calls Can Be Made

Emergency calls from handset can be made only in SoftBank service areas.

Placing Calls

1

In Home Screen, (Phone)

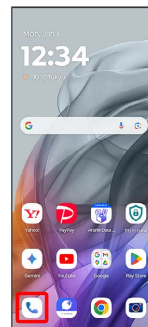

Phone opens.

2

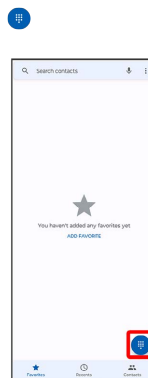

Call window opens.

3

Tap dialpad to enter the other party's number



- Enter area code first for calling landline numbers.

4



Handset dials number. Call begins when other party answers.

5

To end call,



Call ends.

+ Calling the Emergency Number When the Phone's Screen is Locked

Flick Lock Screen up, Emergency call Enter number for emergency service

· This method is available when method for unlocking screen is a setting other than **None** or **Swipe**. For details on unlocking screen, see ["Security & privacy Settings."](#)

? Hints

Q. Call does not connect

A. Was the number dialed using the area code? Dial the number starting with "0."

A. Are signal conditions poor? Call again after moving where signal is good.

Answering Calls

1

Flick up when call is arriving

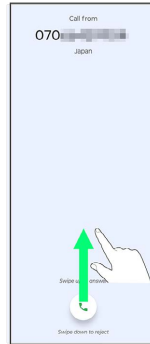

Call begins.

2

To end call,

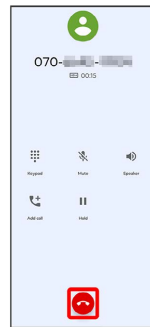

Call ends.

+ Arriving Call Operations

Cancelling Ringtone

Press Volume Key when call is arriving

Rejecting Arriving Calls

Flick down when call is arriving

In-Call Screen Layout/In-Call Operations

During a call, Tap icons to use the following functions.

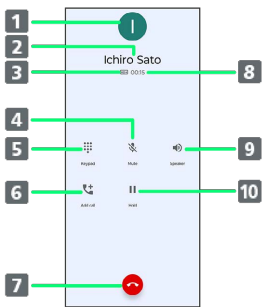

- 1 Show image registered for contact
- 2 Show name/number of other party
- 3 Appears for high-quality sound calls ¹
- 4 Mute your voice to the other party
- 5 Show dialpad
- 6 Call another party
- 7 End call
- 8 Show call time
- 9 Call using Speaker
- 10 Place call on hold

1 Appears for calls with HD Voice, and for calls with VoLTE (HD+).

Placing Calls on External Display

1

Flick Home Screen left twice →

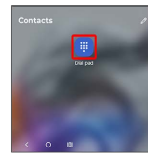

Call window opens.

2

Tap dialpad to enter the other party's number

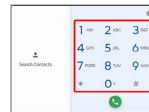

- Enter area code first for calling landline numbers.
- If a phone number is saved on Contacts, Tap **Search** **Contacts** to search a phone number.

3

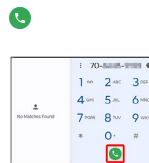

Handset dials number. Call begins when other party answers.

4

To end call,





Call ends.

Answering Calls on External Display (When Display Is Off)

1

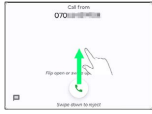
Flick  up when call is arriving



 Call begins.

• Swipe  and tap message to send a message.

2

To end call, 





 Call ends.

Answering Calls on External Display (When Display Is On)

1

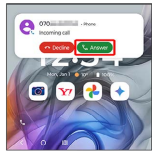
Answer  when a call is coming



 Call begins.

2

To end call, 



 Call ends.

Optional Services

Use the following optional services.

Optional Services

The following optional services are available.

Service	Description
Call forwarding	Divert calls to a preset number when out of service area or unable to answer.
Voicemail	Divert calls to a Voicemail Center to take messages when out of service area or unable to answer.
Call Waiting ¹	Answer calls during a call.
Group Calling ¹	Merge multiple calls.
Notify Caller ID	Send or hide your number when placing calls.
Call Barring	Restrict incoming/outgoing calls by conditions.

¹ Requires separate subscription



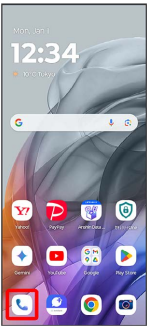

Using Call Forwarding

1

In Home Screen,  (Phone)



2



 Call service settings open.

· If you set 2 SIMs, Tap **Calling accounts** , and then select a SIM.

3

Voice Mail / Call Forwarding



4

Voice Mail / Call Forwarding  Call Forwarding ON

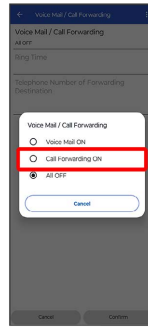

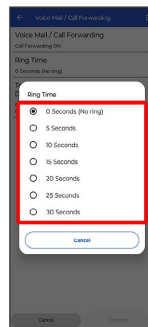

5

Ring Time  Select ring time



6

Telephone Number of Forwarding Destination  Tap phone number field  Enter phone number to forward to  Register

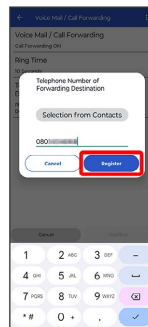

7

Confirm



 Call Forwarding is set.

Using Voicemail

1

In Home Screen, (Phone)

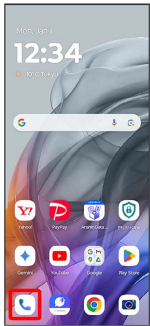

2

Settings → Calling accounts → SoftBank → Call service settings

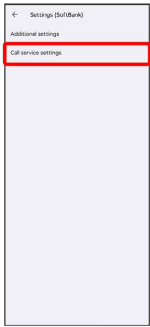

Call service settings open.

· If you set 2 SIMs, Tap **Calling accounts** , and then select a SIM.

3

Voice Mail / Call Forwarding



4

Voice Mail / Call Forwarding → Voice Mail ON

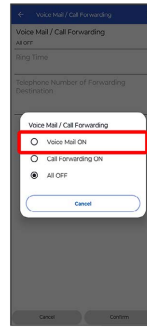

5

Ring Time → Select ring time

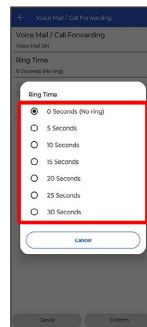

6

Confirm

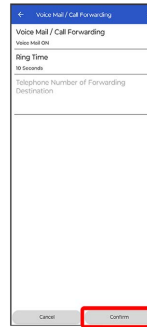

Voicemail is set.

· appears in Status Bar for new message. Dial "1416" then follow voice guidance.

Using Call Waiting



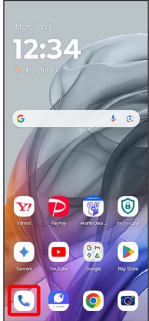

Requires separate subscription.

1

In Home Screen,  (Phone)



2

  Settings  Calling accounts  SoftBank 

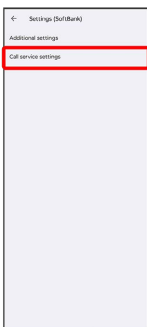

Call service settings





 Call service settings open.

· If you set 2 SIMs, Tap **Calling accounts** , and then select a SIM.

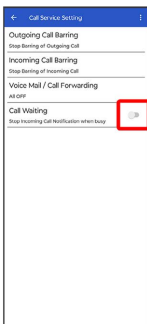

3

 for Call waiting ()

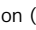

 Call Waiting is set.

· Tap icon to toggle on ()/off ().

· When a second call arrives during a call, Call Waiting tone is heard. To end current call and answer second call, Flick  to upper left. To place current call on hold and answer second call, Flick  up.

Using Group Calling



Requires separate subscription.

1

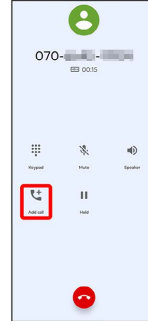
During a call, **Add call**



2

Enter number  



3

When call connects, **Merge**

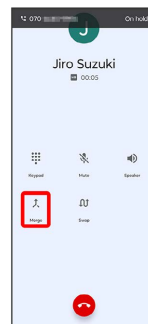

 Group Calling service starts.



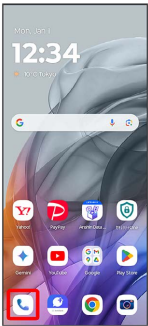

Using Caller ID Notification

1

In Home Screen,  (Phone)



2

Additional settings

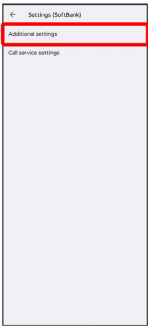

· If you set 2 SIMs, Tap **Calling accounts** , and then select a SIM.

3

Caller ID  **Network default** / **Hide number** / **Show number**



 Caller ID is set.

Using Call Barring

Restrict calls and SMS to/from specific phone numbers.



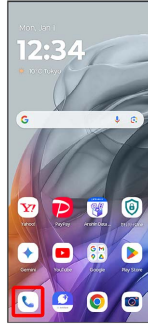

· It may not be possible to restrict outgoing SMS in some areas.

1

In Home Screen,  (Phone)



2

Call service settings



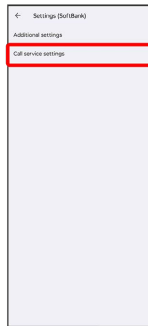

 Call service settings open.

· If you set 2 SIMs, Tap **Calling accounts** , and then select a SIM.

3

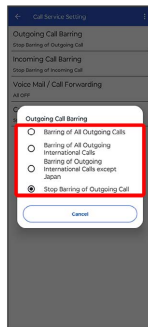
Outgoing Call Barring / **Incoming Call Barring**  Select outgoing/incoming restriction



 Call Barring is set.

Phone Number

Checking Your Phone Number



1

Flick Home Screen up,  (Settings)  About phone

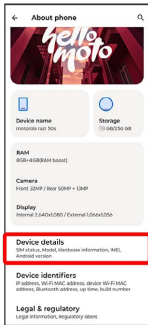
 Device details



 Handset number is shown below "SIM card status"/"eSIM status."

· Tapping  /  also shows handset number.

Using Contacts

Save phone numbers, mail addresses, etc. to Contacts.

! Contacts Cautions

Information saved in Contacts may be lost or changed if Battery is left uncharged for a long period. Accident or malfunction may also cause loss or change to information. It is recommended that you keep a separate copy of contacts and other important information. SoftBank Corp. is not responsible for any damages from lost or changed contacts.

Adding New Contacts

1

In Home Screen,  (Google)

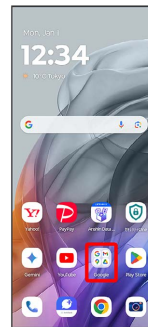

2

 (Contacts)

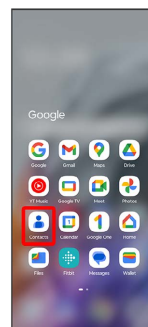

 Contacts appear.

· If confirmation appears, follow onscreen instructions.

3

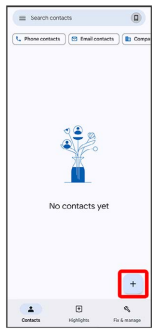

4

Enter items

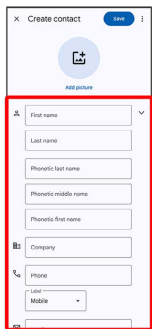

5

Save

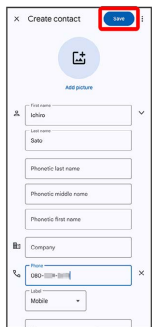

Contact is added.

Saving Contacts from Dialing Screen

Save a number entered in dialing screen directly to Contacts.

In Home Screen, (Phone) Tap dialpad to enter number to save **Create new contact** Enter each item **Save**

Messaging

Sending Messages (+Message).....	50
Using Gmail.....	51

Sending Messages (+Message)

Sending New Messages

1

In Home Screen,  (+Message)

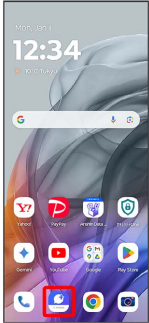

2

Message

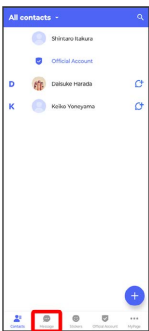

3



4

New message



5

Tap destination

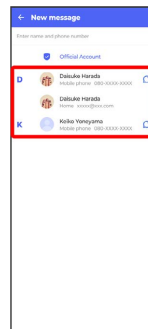

 Message window opens.

- To send to a phone number/email address not saved in contacts, Tap "Enter name and phone number" field at top of Display and enter the phone number/email address  **Add** and create message.

6

Tap message entry field



7

Enter message → →



Message is sent.

Using Gmail

Gmail is Google's webmail service. Use this service to exchange email.

Creating/Sending Mail

1

In Home Screen, (Google)

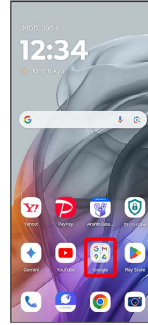

2

(Gmail)

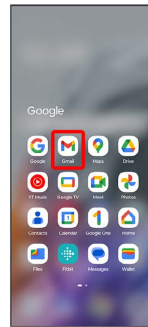

Mail list opens.

· If confirmation appears, follow onscreen instructions.

3

Compose

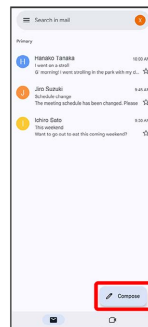

Mail composition window opens.

4

Enter recipient/subject/mail text





5







 Mail is sent.

 Operations when Composing Mail

Adding Cc/Bcc

In mail composition window,  for recipient  Enter recipient

Attaching Files

In mail composition window,    
Select file to attach

Save Mail Being Composed as a Draft (Send Later)

In mail composition window,   

Delete Mail Being Composed

In mail composition window,     

Internet

Using Chrome..... 54

Using Chrome

Use Chrome simply by entering words to search and URLs.

💡 TLS

TLS (Transport Layer Security) is a protocol for encrypting sent/received data. While in a screen connected by TLS, data is encrypted to safely send/receive private information, credit card numbers, corporate secrets, etc., and provide protection against online threats (eavesdropping, falsification, impersonation, etc.).

⚠️ TLS Cautions

When opening a secured page, users must decide as their responsibility whether or not to open the page with use of TLS. SoftBank Corp. and the Certification Authorities Symantec Website Security G.K. and Cybertrust make no guarantees whatsoever to users regarding security of TLS.

Using Chrome

1

In Home Screen,  (Chrome)

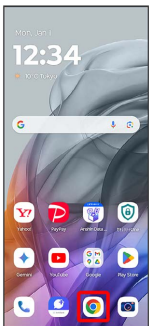

 Chrome opens.

- If confirmation appears, follow onscreen instructions.

2

Tap entry box

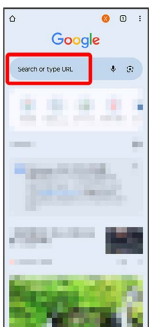

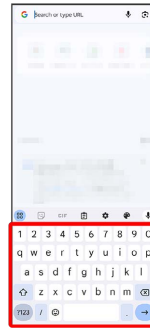

3

Enter search string or URL

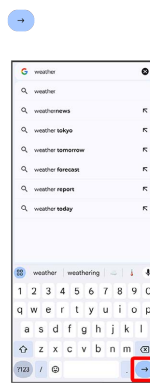

4



 Search results appear or a Website opens.

+ Opening New Tabs

Open several tabs to switch between Websites easily.

In Chrome,   **New tab**

 New tab appears.

- To switch tabs, Tap **2** and then target tab. Number in icon changes with number of open tabs.

Adding Bookmarks

1

In Home Screen,  (Chrome)

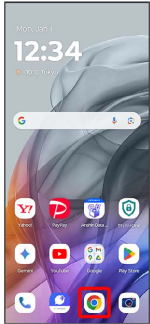

 Chrome opens.

2

Show Website to add



3





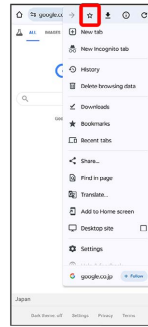





4







 Current Website is added to Bookmarks.

+ Bookmark Operations

Editing Bookmarks

In Chrome,   **Bookmarks**  Touch & Hold target bookmark    Edit items  

Deleting Bookmarks

In Chrome,   **Bookmarks**  Touch & Hold target bookmark  

Camera

Capturing Still Images/Videos.....	58
Viewing Still Images/Videos (Photos).....	60

Capturing Still Images/Videos

File Format for Still Images/Videos

File Format for Still Images

File format for still images is JPEG.

File Format for Videos

File format for videos is MP4.

Camera Cautions

If Lens Becomes Dirty

Fingerprints/smudges on lens prevent capturing of clear still images/videos. Wipe lens with a soft cloth beforehand.

Avoid Exposure to Direct Sunlight

Be careful not to expose lens to direct sunlight for long periods. May discolor color filter and affect color of images.

LED Flash Warning

Do not shine LED Flash close to eyes. Do not look directly at LED Flash when shining. Do not shine Mobile Light at other people's eyes. May affect eyesight, etc.

Capturing Still Images

1

In Home Screen,  (Camera)

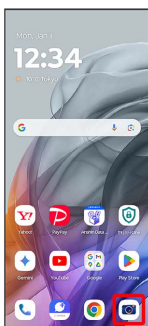

· If confirmation appears, follow onscreen instructions.

2

Photo

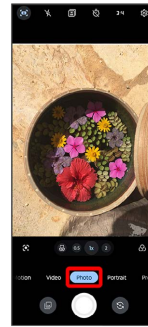



 Photo Viewfinder appears.

· Alternatively, Drag the shooting mode left/right to switch.

3

Aim Camera at subject   /Press Volume Key



 Shutter clicks and still image is saved.

Capturing Videos

1

In Home Screen,  (Camera)

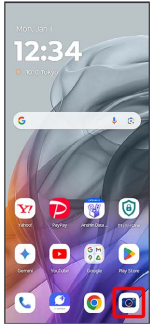

· If confirmation appears, follow onscreen instructions.

2

Video



 Video Viewfinder appears.

· Alternatively, Drag the shooting mode left/right to switch.

3

Aim Camera at subject   /Press Volume Key

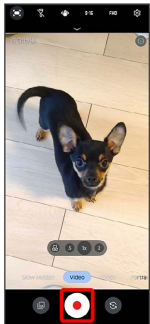

 Video recording starts.

4

To end capture,  /Press Volume Key



 Video recording stops and video is saved.

Viewing Still Images/Videos (Photos)

View still images/videos saved in internal storage or in Google online storage. Viewing after logging in to a Google account is described.

Showing Still Images/Videos

Show captured or downloaded still images and videos.

Supported file formats:

Type	File Format
Still image	bmp, gif, jpg, png, webp, heif
Video	3gp, mp4, mkv, webm

1

In Home Screen,  (Google)

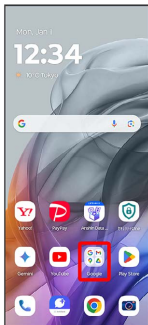

2

 (Photos)

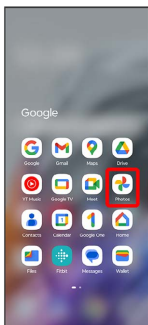

 Still image/video list appears.

- If confirmation appears, follow onscreen instructions.

3

Tap still image/video



 Still image/video window opens.

- Tap video in still image/video list to play back video automatically.
- To select other files, return to still image/video list and select file, or Flick still image/video window left or right and select.

 Zooming In/Out on Still Images/Videos

In still image/video window, Tap Display twice or Pinch.

Application Basics

Applications.....	62
Adding Applications.....	63

Applications

Setting Required Permissions for Applications

Set the operation of Apps when activating for the first time. The type and content of a confirmation differs with the applications. Activating  (Files) for the first time is described as an example.

- An application may not function correctly if permission to use it was not set.

1

In Home Screen,  (Google)

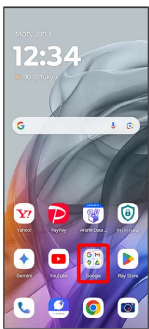

2

 (Files)

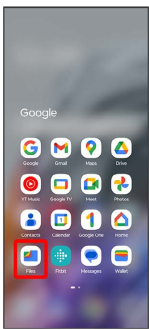

- If confirmation appears, follow onscreen instructions.

3

Allow

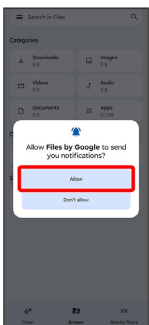







 Settings are complete.





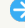

- For several functions, continue in the same way.

+ Other Ways to Set Required Permissions for Applications

Setting Functions to Use for Each Application

Flick Home Screen up,  (Settings)  Apps 
 Tap application  Permissions
 Tap function  Tap required permission

Setting Applications with Permitted Usage for Each Function

Flick Home Screen up,  (Settings)  Security & privacy  Privacy  Permission manager  Tap function  Tap application  Tap required permission

Adding Applications

Download a variety of applications (free/paid) from Google Play™. Change the setting of downloaded applications to enable manual or automatic updates. Log in to your Google account beforehand.

! Installing Applications

Many different kinds of applications can be installed on handset from Google Play (provided by Google). The company is not responsible in any way for user-installed applications (quality, reliability, legality, fitness for a purpose, credibility, accuracy, etc.) or resulting malfunctions (viruses, etc.).

Installing Free Applications

1

In Home Screen,  (Play Store)

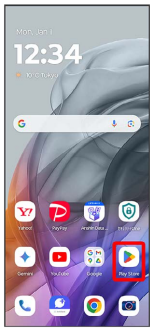

 Google Play appears.

· If confirmation appears, follow onscreen instructions.

2

Tap free application

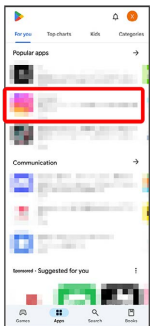

3

Install

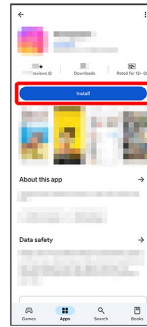

 Application is downloaded and installed.

· If confirmation appears, follow onscreen instructions.

Purchasing Paid Applications

1

In Home Screen,  (Play Store)

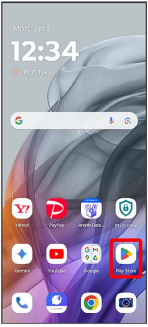

 Google Play appears.

· If confirmation appears, follow onscreen instructions.

2

Tap paid application



3

Tap amount



 Follow onscreen instructions. After following instructions, the application is downloaded and installed.

Purchased Applications

Payment





Pay only once. Redownloads of uninstalled applications are free of charge.

On Other Android™ Devices

Install an application on any Android device under the same Google account for free.

Requesting Refunds

Refund is possible within a limited time. By requesting a refund, the application is deleted and the charge is cancelled. A refund request is valid only once per one application.

In Google Play, Tap account icon at top right  [Manage apps & device](#)  [Manage](#)  [Tap application](#)  [Google Play refund policy](#)  [Request a refund](#)

Purchasing Applications

Purchase applications at your own risk. SoftBank Corp. is not responsible for any disadvantage resulting for user or third parties.

Updating Applications

1

In Home Screen,  (Play Store)

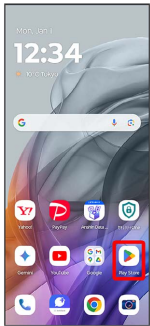

 Google Play appears.



· If confirmation appears, follow onscreen instructions.

2

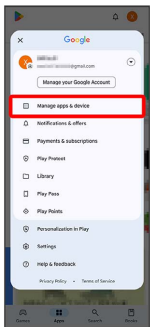
Tap account icon at top right  **Manage apps & device**



3

Manage  Tap application to update  **Update**

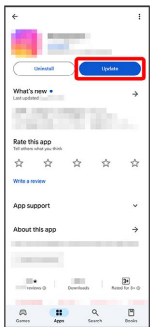



 Application is updated.

· If confirmation appears, follow onscreen instructions.

+ Setting Application Updates

Setting Automatic Updates for Applications

In Google Play, Tap account icon at top right 

Settings  **Network preferences**  **Auto-update**

apps  Set update method

Setting Automatic Updates for Individual Applications

In Google Play, Tap account icon at top right  **Manage**

apps & device  **Manage**  Tap application  **:**

 **Enable auto update** ()

· Automatic updates cannot be enabled for some applications.

Wi-Fi/Bluetooth

Connecting by Wi-Fi.....	68
Using Bluetooth® Function.....	69

Connecting by Wi-Fi

Handset supports Wi-Fi (wireless LAN). Access the Internet via a household Wi-Fi connection environment.

Connecting Selected Access Points

1

Flick Home Screen up

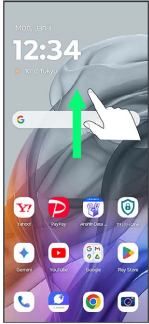

2

(Settings)

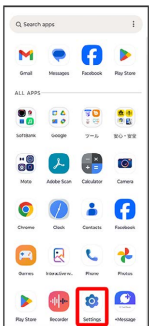

3

Network & internet

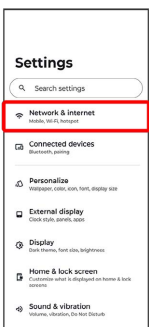

4

Wi-Fi

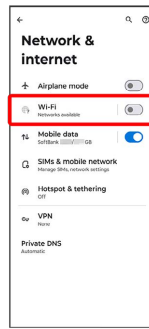

Wi-Fi settings open.

· If confirmation appears, follow onscreen instructions.

5

Wi-Fi ()

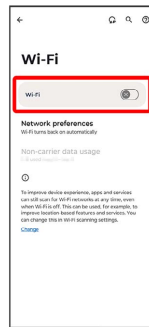

Wi-Fi is enabled.

· Tap **Wi-Fi** to toggle on ()/off ().

6

Tap Wi-Fi network

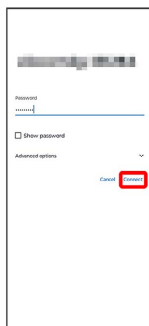

7

Enter password → **Connect**

 Handset is connected.

- The password, for a household wireless LAN router, is sometimes found on a sticker on the router (WEP, WPA, KEY, etc.). Contact the router manufacturer for information. For password for a public wireless LAN, check with user's service provider.
- Entering a password is not required if a Wi-Fi network is not security protected.

Using Bluetooth® Function

Connect to a Bluetooth®-capable wireless phone, etc. for calls or to a hands-free device such as a headset.

? Hints

- Q.** Cannot use Bluetooth®
- A.** Is handset in "Airplane mode"? If in Airplane mode, Bluetooth® function is disabled. Bluetooth® function can be enabled again after placing handset in Airplane mode.

! Bluetooth® Function Cautions

Connection

Bluetooth® connection may not be possible with some Bluetooth® devices. In addition, noise may interfere with wireless or hands-free conversations.

File Transfer

Files may not appear correctly on recipient devices.

Enabling Bluetooth® Function

1

Flick Home Screen up

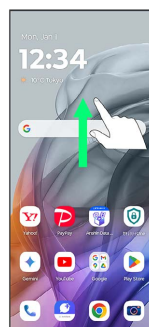

2

 (Settings)

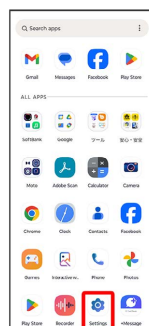

3

Connected devices

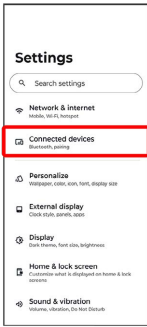

4

Connection preferences

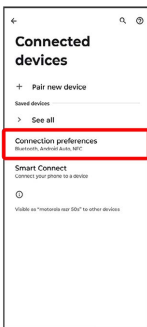

5

Bluetooth

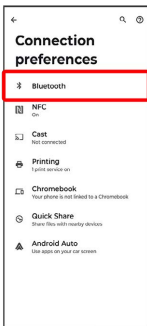

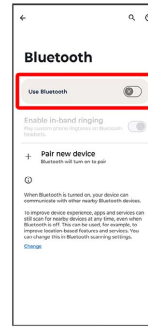

 Bluetooth® settings open.

6

Use Bluetooth ()

 Bluetooth® function is enabled.

· Tap **Use Bluetooth** to toggle on ()/off ().

Handset Settings

Handset Settings.....	72
Data Usage Settings.....	73
Display Settings.....	74
Home & lock screen Settings.....	74
Sound & vibration Settings.....	76
Battery Settings.....	77
Security & privacy Settings.....	77
System Settings.....	80
Other Settings.....	80

Handset Settings

Main setting options are described.

Handset Settings

Customize operation of handset functions. Handset settings include the following items.

Item	Description
Network & internet	Make settings for Wi-Fi, mobile networks, data usage, etc.
Connected devices	Make connection settings to other devices, such as Bluetooth® connection.
Personalize	Customize wallpaper, theme, color, font style, etc.
External display	Make settings for External Display such as clock style and panels.
Display	Set screen brightness, font size, etc.
Home & lock screen	Customize displayed contents on Home and Lock screen.
Sound & vibration	Make ringtone, operation tones, and other sound settings.
Notifications	Set functions for notifications.
Gestures	Make settings for gesture operation.
Battery	Check Battery usage and make settings to save battery power.
Storage	Check internal storage and USB drive, mount USB drive, and delete data on USB drive.
Location	Make Location settings.
Accessibility	Set captions, magnification gestures, and other useful accessibility functions.
Apps	Make application settings.
Passwords & accounts	Create/add accounts, sync accounts, etc.
Security & privacy	Set security functions such as screen lock and fingerprint authentication, and make privacy settings such as the permission manager and password display.
Safety & emergency	Make settings for emergency contacts, emergency alerts, etc.
Digital Wellbeing & parental controls	Manage time that handset is used, and set controls on usage as a parent/guardian.
Google	Make settings for Google services.
System updates	Check for updates, and make settings for smart updates. For details, see " Updating Software ."
Rating & feedback	Send feedback on your handset experience.
Help	View handset help.
System	Make settings for language and input, date and time, backup, reset, etc.

About phone Check handset name, own phone number, etc.

1

Flick Home Screen up   (Settings)

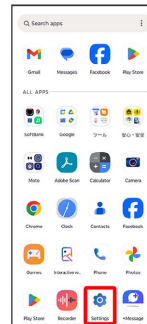

 Handset settings open.

2

Select item to set

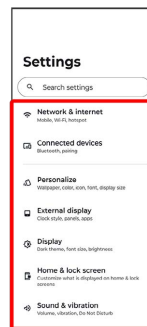

 Settings open.

Data Usage Settings

Check cellular data usage and set limit.

+ Data Usage Operations

Set Data Saver

Flick Home Screen up → (Settings) → Network & internet → Mobile data → Data Saver → Use Data Saver ()

· Tap Use Data Saver to toggle on ()/off ().

Setting Functions Not Subject to Data Saver

Flick Home Screen up → (Settings) → Network & internet → Mobile data → Data Saver → Unrestricted data → Tap application not to be subject ()

· Tap application to toggle on ()/off ().

Enabling Cellular Data

Flick Home Screen up → (Settings) → Network & internet → SIMs & mobile network → SoftBank → Use SIM

- If you set 2 SIMs, Tap SIMs & mobile network , and then select a SIM.
- Tap Use SIM to toggle on ()/off ().
- If confirmation appears, follow onscreen instructions.

Viewing Data Usage with Wi-Fi

Flick Home Screen up → (Settings) → Network & internet → Wi-Fi → Non-carrier data usage

- If confirmation appears, follow onscreen instructions.

Checking Application Data Usage

1

Flick Home Screen up → (Settings) → Network & internet

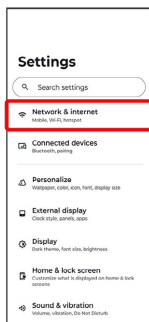

2

Mobile data

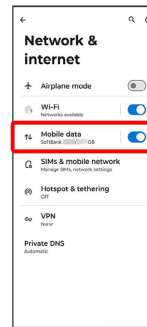

3

XXXX used (XXXX represents data usage amount)

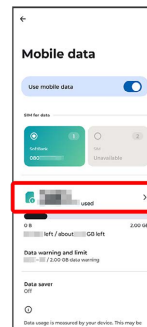

Check usage in the application data usage window.

- If you set 2 SIMs, Tap XXXX used (XXXX represents data usage amount) of the SIM for which you check data usage amount.

Display Settings

Set screen brightness, font size, etc.

Display Settings

Settings can be made for the following items.

Item	Description
Brightness level	Set brightness of Display.
Adaptive brightness	Enable adjustment of brightness for surroundings.
Dark theme	Set functions for Dark theme.
Colors	Set screen color.
Display size and text	Set the size of images, icons, text, etc. in Display.
Display refresh rate	Set the refresh rate.
Full screen	Set the range of display when in full screen for individual applications.
Auto-rotate screen	Set whether to rotate Display with handset orientation automatically.
Night Light	Set whether Display blue light is reduced.
Flicker prevention	Enable handset to prevent screen from flickering in dark conditions.
Screen timeout	Set a period of inactivity after which Display turns off automatically.
Screen saver	Set screen saver.
Screen record	Make settings for recording screen.
Three finger screenshot	Enable screenshots to be captured by placing three fingers on screen.
Swipe to split	Enable screen to be split by Dragging middle of screen left or right.
Smart Connect	Link handset image to a monitor or similar device.

Home & lock screen Settings

Home & lock screen Settings

Settings can be made for the following items.

Item	Description
Home settings	Customize style, icon size, app labels, etc.
Control center	Select the method to access to notifications and Quick settings.
Lock screen	Make settings for notifications shown on Lock screen.

Changing Glance Settings

Use Glance to set recommended Wallpapers to Lock Screen.

1

Flick Home Screen up → (Settings)

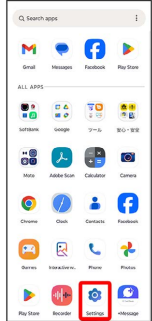

2

Home & lock screen

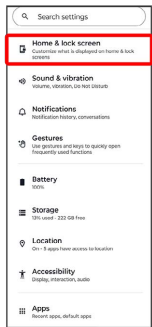

3

Lock screen

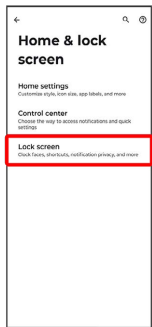

4

Glance

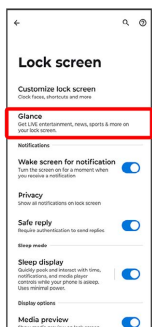

5

Turn on ()



Setting is complete.

- Tap **Turn on** to toggle on ()/off ().
- If confirmation appears, follow onscreen instructions.

+ Using Cellular Data to Update Glance

Flick Home Screen up → (Settings) → Home & lock screen → Lock screen → Glance → Update content over mobile data ()

- Tap **Update content over mobile data** to toggle on ()/off ().

Sound & vibration Settings

Make ringtone, operation tones, and other sound settings.

Sound & vibration Settings

Settings can be made for the following items.

Item	Description
Do Not Disturb	Make settings for Do Not Disturb (Silent mode).
Flip for DND	Enable Do Not Disturb (Silent mode) when handset is placed with its screen face down.
Pick up to silence	Enable ringtone for incoming call to be muted by lifting handset.
Media volume	Set volume for music, videos, etc.
Call volume	Set volume for call.
Ring volume	Set volume for Phone ringtone, etc.
Notification volume	Set volume for notification.
Alarm volume	Set volume for alarm.
Multi-volume	Adjust volume of individual applications by Pressing Volume Key while using an application.
Phone ringtone · SIM card	Set Phone ringtone for USIM Card.
Phone ringtone · eSIM	Set Phone ringtone for eSIM.
Default notification sound	Set notification sound.
Default alarm sound	Set alarm ringtone.
Dial pad tones	Enable confirmation tones when Dialpad Tapped.
Screen locking sound	Set whether to make a sound when handset is locked/unlocked.
Tap & click sounds	Set whether to make a sound for tapping.
Vibration & haptics	Make vibration settings.
Always show icon when in vibrate mode	Enable icon to appear in Status Bar when in Do Not Disturb (vibration).
Charging sounds and vibration	Enable tone and handset to vibrate at start of charging.
Dolby Atmos	Make settings for Dolby Atmos sound.
Calling modes	Enable background noise while in a call or recording audio to be reduced.
Media	Set whether to hide the media player on Quick Settings when a media playback is finished.

Media controls	Enable operation for media with Volume Key while screen is turned off (screen lock).
Live Caption	Set captions to be generated automatically for speech audio.

Battery Settings

Check Battery usage and make settings to save battery power.

Battery Settings

Items that can be checked, set are the following.

Item	Description
XX % Until XX:XX hr ¹	Check battery and remaining time.
Battery saver	Enable Battery Saver function.
Battery usage	Check usage since last full charge.
Adaptive Battery	Enable limiting of battery usage of seldom-used applications.
Manage background apps	Enable battery life to be extended by managing applications running in the background.
Optimized charging	Set handset to learn charging time patterns and optimize charging to extend battery life.
Overcharge protection	Enable limiting of charging if charging has continued for three days in a row.
Power sharing	Set whether to charge another device compatible with wireless charging with handset.
Slow charging notification	Enable notification to appear when handset is not being optimally charged with a wireless charger.
Battery percentage	Set whether to show remaining battery level on Status bar.

1 Screen view may differ depending on usage.

Security & privacy Settings

Set security functions such as screen lock and fingerprint authentication, and make privacy settings such as the permission manager and password display.

+ Setting Screen Not to Lock

Flick Home Screen up, → (Settings) → Security & privacy → Device unlock → Screen lock → None

· If method for unlocking screen is setting other than None or Swipe before changing setting, first Tap Screen lock and unlock screen.

Security & privacy Settings

Settings can be made for the following items.

Item	Description
App security	Scan and check handset for security issues.
Device unlock	<ul style="list-style-type: none"> · Screen lock Set method for unlocking screen. · Fingerprint Set fingerprints. · Face Unlock Make Face Unlock setting.
Account security	Diagnose the security of your Google account.
Device finders	Set location to be shown if handset is misplaced.
System & updates	<p>Security update</p> <p>Check for updates, and make settings for smart updates.</p> <p>For details, see "Updating Software."</p> <ul style="list-style-type: none"> · Google Play system update Update OS and security patches. · Backup Back up data to a Google server.

- Permission manager
- Check application permissions.
- Privacy dashboard
- Check applications that have recently used permissions.

- Ads
- Make settings for your advertising ID.
- Health Connect

Make settings for app permission to access to Health Connect.

- Data sharing updates for location
- Check apps whose methods to share location are updated.

- Camera access
- Allow applications and services to access Camera.

- Microphone access
- Allow applications and services to access Mic.

- Show clipboard access
- Set whether to show notifications when apps access text or image on clipboard.

- Show passwords
- Enable passwords to be visible as passwords are entered.

- Location access
- Set whether to use location, or check apps which have access to it.

- Activity controls
- Set whether to save activities of website or apps.

Make settings for showing notifications in Lock Screen, and enable handset diagnostic and other information to be sent to Google automatically. Also, make settings for SIM card lock, app pinning, etc.

Check ThinkShield setting.

Privacy

More security & privacy

ThinkShield

Enabling USIM PIN

When PIN is enabled, a window for entering PIN appears to allow handset use each time handset is powered on with USIM Card installed/eSIM enabled.

1

Flick Home Screen up,   (Settings)  Security & privacy

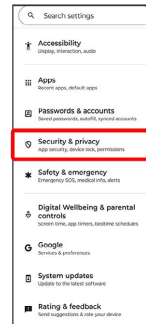

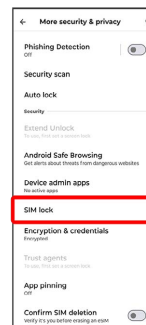

2

More security & privacy  SIM lock



3

Lock SIM  Enter PIN  OK

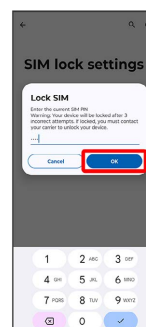

 PIN is enabled.

- If confirmation appears, follow onscreen instructions.
- If you set 2 SIMs, Tap the tab of the SIM for which you make settings.

! PIN Cautions

Entering incorrect PIN three consecutive times activates PIN Lock. To cancel, Personal Unlocking Key (PUK) is required. For PUK, contact [Customer Service](#). Entering incorrect PUK ten consecutive times locks USIM Card/eSIM, disabling handset. For recovery, USIM Card/eSIM must be reissued by SoftBank (fees apply).

Changing USIM PIN

First enable USIM PIN to change PIN.

1

Flick Home Screen up, → (Settings) → Security & privacy

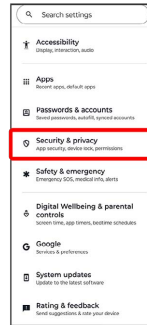

2

More security & privacy → SIM lock

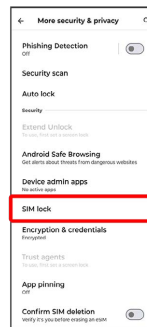

3

Change SIM PIN → Enter current PIN → OK → Enter new PIN → OK → Re-enter new PIN → OK



🏁 PIN is changed.

- If you set 2 SIMs, Tap the tab of the SIM for which you make settings.

System Settings

Make settings for language and input, date and time, backup, reset, etc.

System Settings

Settings can be made for the following items.

Item	Description
Languages	Set functions for displayed language and text-to-speech output.
Keyboard	Set functions for keyboard.
Date & time	Set functions for date and time.
Backup	Back up data to a Google server.
Reset options	Reset settings, initialize data, erase any eSIMs, etc.
Performance	Enable application usage patterns to be learned so they activate quickly, and use of storage to expand RAM.

+ Languages & Input Operations

Set the Display Language

Flick Home Screen up, → (Settings) → System → Languages → System Languages → Add a language → Select a language to add → Drag = to show to top of list → Change

· For some languages, select language and then region.

Set the App Language

Flick Home Screen up, → (Settings) → System → Languages → App languages → Select app → Select language

· For some languages, select language and then region.

Set Keyboard/Voice Input

Flick Home Screen up, → (Settings) → System → Keyboard → On-screen keyboard → Tap keyboard to set/voice input method → Tap item → Follow onscreen instructions

Other Settings

Network & internet Settings

Make settings for Wi-Fi, mobile networks, data usage, etc. Settings can be made for the following items.

Item	Description
Airplane mode	Disable all functions that emit signals. Handset stays powered on. For details, see " Airplane Mode ."
Wi-Fi	Enable Wi-Fi connection. For details, see " Connecting by Wi-Fi ."
Mobile data	Make settings for cellular data usage.
SIMs & mobile network	Make settings for USIM Card, downloaded eSIMs, preferred network type, etc. For details on cellular providers and data roaming, see " Global Roaming ."
Hotspot & tethering	Use handset as a Wi-Fi router to connect a PC or game device to the Internet.
VPN	Set VPN access points.
Private DNS	Set Private DNS.

Connected devices

Make connection settings to other devices, such as Bluetooth® connection. Settings can be made for the following items.

· Names and status of connected devices appear at top of Display.

Item	Description
Pair new device	Search for and pair nearby Bluetooth® devices.
Saved devices	Paired devices appear.
Connection preferences	Make settings for using Bluetooth®, NFC, casting, etc.
Smart Connect	Link handset image to a monitor or similar device.

Personalize Settings

Customize theme, color, font style, etc. Settings can be made for the following items.

Item	Description
Wallpaper	Make Wallpaper settings.
Themes	Change handset theme.
Fonts	Change font.
Colors	Change basic color, Wallpaper color, etc.
Icon shape	Change icon shape.
Lock screen	Customize displayed contents on Lock screen.
External display	Make settings for External Display such as clock style and panels. For details, see " External display Settings ."
Display size and text	Set the size of images, icons, text, etc. in Display.
Layout	Change Home Screen layout.
Sounds	Change ringtone, notification ringtone, and alarm ringtone.
Dark mode	Switch to a light mode, dark mode, etc.

External display Settings

Make settings for External Display such as clock style and panels. Settings can be made for the following items.

Item	Description
Lock screen	Make settings for Lock Screen.
Home screen	Make settings for Home Screen.
Razr Tips	Check handset functions.
Panels	Customize Home Screen sheets.
Display & Font Size	Change display and font size.
Call settings	Make call settings.
App settings	Set apps to start from External Display.
Sleep display	Set whether to use Sleep display.
Desk display	Set whether to show texts, photos, etc. according to handset position.
Music player	Set background for music player.

Notifications Settings

Set functions for notifications. Settable items are the following.

Item	Description
App notifications	Manage notifications for each app.
Notification history	Show recent and snoozed notifications.
Conversations	Show conversations set as high priority.
Bubbles	Enable some chat applications to be shown as floating icons over other applications.
Device & app notifications	Allow devices and applications to access notifications.
Notifications on lock screen	Make settings for showing notifications on Lock screen.
Sensitive notifications ¹	Set whether to show sensitive notifications on Lock screen.
Skip lock screen ²	Enable Lock Screen to be skipped after unlocking with Face Unlock.
Do Not Disturb	Make settings for Do Not Disturb (Silent mode).
Flash notifications	Set whether to blink camera light or Display when a notification is received or when an alarm rings.
Wireless emergency alerts	Make settings for emergency alerts.
Hide silent notifications in status bar	Set whether to silent notification icons on Status bar.
Allow notification snoozing	Set notifications to be snoozable.
Notification dot on app icon	Set whether to show notification dot on app icon.
Enhanced notifications	Set suggested actions and replies to appear.

- 1 Appears when method for unlocking screen is "Pattern" / "PIN" / "Password."
- 2 Available when face is saved with "Face Unlock."

+ Setting Applications that Have Notifications Blocked

Block all notifications from certain applications.

Flick Home Screen up,  (Settings) 

Notifications  App notifications  Most

recent  All apps   for application to have notifications blocked ()

Gestures Settings

Make settings for gesture operation. Settings can be made for the following items.

Item	Description
System navigation	Set the navigation mode.
Sidebar	Enable Sidebar to appear for quick multitasking, and set applications to appear when Flicking Sidebar left.
One-handed mode	Make settings for one-handed mode and use smaller screen easier to operate with one hand.
Swipe to split	Enable screen to be split by Dragging middle of screen left or right.
Three finger screenshot	Enable screenshots to be captured by placing three fingers on screen.
Double press power key	Enable Camera to activate by Pressing Power Key twice.
Slide on power key	Set operation by sliding Power Key.
Press & hold power button	Enable Power Key menu to show or Google Assistant to activate by Pressing and Holding Power Key.
Media controls	Enable operation for media with Volume Key while screen is turned off (screen lock).
Quick Launch	Enable custom action by Double-Tapping background. Set music playback/pause, screenshot capture, etc. as custom actions.
Quick Capture	Enable Camera to open by rolling your wrist quickly twice.
Fast Flashlight	Enable flashlight to turn on/off with two chopping motions of handset.
Lift to unlock	Enable screen to unlock when handset is picked up.
Pick up to silence	Enable ringtone for incoming call to be muted by lifting handset.
Approach to Silence	Set whether to turn off ringtone, alarm, etc. by putting hand close to External Display
Flip for DND	Enable Do Not Disturb (Silent mode) when handset is placed with its screen face down.

+ Setting Power Off by Pressing and Holding Power Key

Flick Home Screen up,  (Settings)  Gestures  Press & hold power button  Power menu

 Google Assistant is disabled from activating, and power menu appears when Power Key is Pressed and Held.

Storage Settings

Check internal storage and USB drive, mount USB drive, and delete data on USB drive. Settings can be made for the following items.

Item	Description
This device / USB drive	Check used space and total space in internal storage/on USB drive.
Storage manager	Enable use of storage manager tool, and make settings for deleting photos/videos.
Free up space	Free up space by deleting temporary files, etc.



Location Settings

Make Location settings. Settings can be made for the following items.

Item	Description
Use location	Enable use of location information.
Recent access	Show apps which requested location.
App location permissions	Make settings for using location for each app.
Location services	Make settings for Google Location services, Wi-Fi and Bluetooth® scanning, etc.

Accessibility Settings

Set captions, magnification gestures, and other useful accessibility functions. Settings can be made for the following items.

Item	Description
Family Space	Enable user accessibility functions with  (Family Space).
セキュリティ One	Enable user accessibility functions with  (セキュリティOne (Security One)).
TalkBack	Set accessibility service (TalkBack) to read out screen information.
Select to Speak	Enable Tapped items on Display to be read out.
Display size and text	Set the size of images, icons, text, etc. in Display.
Color and motion	Make settings for color and animations.
Extra dim	Enable screen to dim more than brightness set in "Brightness level."
Magnification	Set screen to be enlargeable.
Accessibility Menu	Enable use of large menu.
Switch Access	Enable use of an external switch for operating handset.
Timing controls	Set detection time for Touch & Hold on Display.
System controls	Make settings for system navigation, one-handed mode, etc.
Vibration & haptics	Make vibration settings.
Live Caption	Set captions to be generated automatically for media playback.
Caption preferences	Make settings for captions.
Audio description	Enable readout of onscreen explanations for movies, etc.
Flash notifications	Set whether to blink camera light or Display when a notification is received or when an alarm rings.
Hearing devices ¹	Make settings for a hearing aid paired to handset.
Audio adjustment	Enable monaural audio, and set left-right audio balance.
Accessibility shortcuts	Set size of accessibility button, etc.
Text-to-speech output	Set the engine for text readout, as well as change the readout speed and play a sample.

¹ Appears when Bluetooth® function is enabled.

Apps Settings

Make application settings. Settings can be made for the following items.

Item	Description
Recently opened apps	Recently opened applications appear.
See all XX apps	Check and make settings for installed applications.
Default apps	Set applications, etc. that launch as standard applications.
Screen time	Check usage for applications.
Cloud media app	Set access cloud media from.
Unused apps	Check unused applications.
App battery usage	Set battery usage for each app.
Special app access	Make settings for special access.

Passwords & accounts Settings

Create/add accounts, sync accounts, etc. Settings can be made for the following items.

Item	Description
Passwords, passkeys and data services	Make settings for passwords and autofill service.
Accounts for Owner	Show accounts added to handset.
Add account	Create/add accounts.
Automatically sync app data	Set whether to sync app data automatically.

Safety & emergency Settings

Make settings for emergency contacts, emergency alerts, etc. Settings can be made for the following items.

Item	Description
Open Personal Safety	Share emergency and use safety check function.
Medical information	Check and edit your medical information.
Emergency contacts	Check and add emergency contacts.
Emergency SOS	Enable an emergency SOS to be sent by Pressing Power Key five times quickly.
Car Crash Detection	This function is unavailable for handset.
Crisis alerts	Enable notifications to be received for disaster information in the vicinity.
Emergency Location Service	Enable location to be sent when making an emergency call.
Earthquake alerts	Enable an alarm when an earthquake is detected near your current location. Not supported in Japan.
Unknown tracker alerts	Enable alerts to receive notification when an unknown tracker is detected.
Silence notifications while driving	Enable handset to enter Do Not Disturb (Silent mode) automatically when driving.
Wireless emergency alerts	Make settings for emergency alerts.

Digital Wellbeing & parental controls Settings

Manage time that handset is used, and set controls on usage as a parent/guardian. Settings can be made for the following items.

Item	Description
Dashboard	Check usage for applications.
Bedtime mode	Change Display to monochrome or enter Do Not Disturb (Silent mode) at preset time.
Focus mode	Pause distracting apps.
Manage notifications	Manage notifications for each app.
Do Not Disturb	Make settings for Do Not Disturb (Silent mode).
Heads Up	Set whether to enable notification to pay attention when using handset while walking.
Show icon in the app list	Enable icons to be shown in app list.
Set up parental controls	Set controls on smartphone usage as a parent/guardian.

Google Settings

Make settings for Google services. Settings can be made for the following items.

If Google account is set, Tap **All services** to show following items.

Item	Description
Manage your Google Account	Make settings for your Google account.
Ads	Make settings for advertisements that appear.
Autofill	Set whether to autofill information saved to your Google account, or your SMS verification code.
Backup	Make settings for backup.
Devices & sharing	Make settings for casting, Chromebook, Quick Share, etc.
Find My Device	Enable functionality for determining handset location if handset is lost.
Kids and Family	Set controls on smartphone usage as a parent/guardian.
Mobile data & messaging	Check a phone number to use when resetting a Google account.
Personal Safety	Enable handset to enter Do Not Disturb (Silent mode) automatically when driving.
Personalize using shared data	Allow use of shared data.
Set up & restore	Make settings for work profile and nearby devices, and restore contacts from a backup.
Settings for Google apps	Make settings for Google Fit, Google Play Instant, etc.

About Phone

Check handset name, own phone number, etc. Items that can be checked, set are the following.

Item	Description
Device name	Check/change handset name.
Storage	Check storage usage.
RAM	Check total working memory amount.
Camera	Check the number of pixels of Front Camera and Rear Camera.
Display	Check Display size.
Device details	Check information such as Android OS version, phone number of USIM/eSIM, IMEI, etc.
Device identifiers	Check information such as handset IP address, MAC address, etc.
Legal & regulatory	Check legal information and regulatory labeling.

Global Services

Global Roaming.....	88
Making Calls while Abroad.....	89

Global Roaming

Handset supports global travel. Use handset's phone number as it is abroad.

At time of purchase, handset is preset to connect automatically to an appropriate carrier in user's current area. A specific carrier can also be selected manually. Change communication method and data roaming settings.

Setting the Carrier

1

Flick Home Screen up   (Settings)  Network & internet

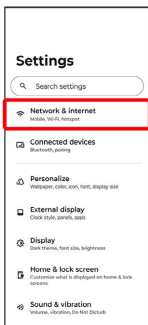

2

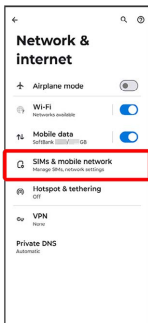

SIMs & mobile network

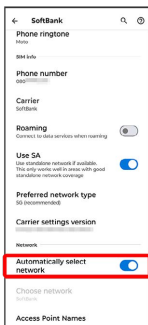

3

SoftBank  Automatically select network ()



 Disable () to search for available networks.

· If you set 2 SIMs, Tap **SIMs & mobile network** , and then select a SIM.

4

Tap network to connect to



 The selected carrier is set.

Changing Data Roaming Setting

1

Flick Home Screen up → (Settings) → Network & internet

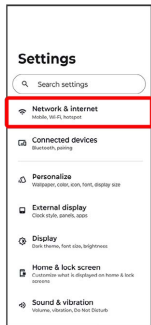

2

SIMs & mobile network

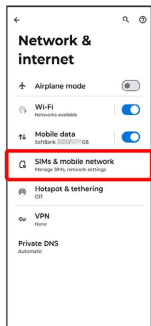

3

SoftBank → Roaming ()

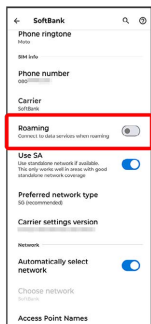

Data roaming is enabled.

- If you set 2 SIMs, Tap **SIMs & mobile network** , and then select a SIM.
- Tap **Roaming** to toggle on ()/off ().
- If confirmation appears, follow onscreen instructions.

Making Calls while Abroad

See SoftBank Website to learn about roaming areas/services, etc.

<https://www.softbank.jp/en/mobile/service/global/>

International Calls to Japan and Other Countries from Abroad

1

In Home Screen, (Phone)

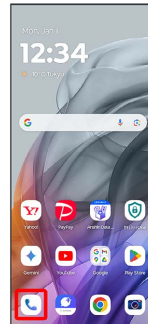

Phone opens.

2

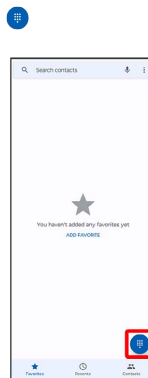

Call window opens.

3

Touch & Hold 0



"+" appears.

4

Enter country code then other party number (omit first 0)



- Do not omit first 0 from phone numbers when dialing Italy (39).

5

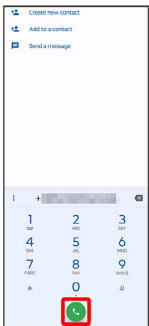

Handset dials number. Call begins when other party answers.

Calls to Landline Phones/Cell Phones in Country of Stay

Place calls the same way you would within Japan.

- Do not enter country code or omit first 0 from phone numbers.

1

In Home Screen,  (Phone)

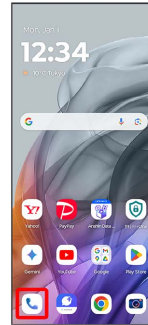

 Phone opens.

2

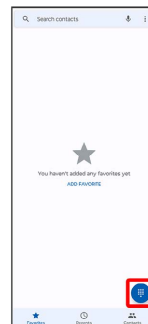

 Call window opens.

3

Tap dialpad to enter the other party's number



4



 Handset dials number. Call begins when other party answers.

Warranty/Specifications/ Customer Service

Warranty & After-Sales Service.....	94
Specifications.....	94
Customer Service.....	95

Warranty & After-Sales Service

Warranty

- The warranty period is 1 year from the date of newly purchase.
- Repairs will be done based on terms of repair service. Terms of repair service is referred to SoftBank website. <https://www.softbank.jp/mobile/support/product/warranty/> (Japanese)
- Warranty covers only handset. Accessories such as cables are not covered by terms of repair service.

! Cautions

Damages

SoftBank Corp. is not responsible for any damages for user or third party resulting from lost opportunities to make a call, etc. due to breakage, malfunction, or trouble of product.

Accidents/Repair

Files and settings may be lost or altered due to accidents or repairs. Keep a copy of important files, etc. SoftBank Corp. is not liable for damages resulting from loss or alteration of files (contacts/images/sound etc.) or settings due to accident or repair.

Disassembly/Modification

Disassembly/modification of handset is prohibited under the Radio Law. Note that handset cannot be accepted for repairs if modified.

After-Sales Service

To request repairs, contact [Customer Service](#) or a nearby SoftBank Shop. Have details of symptoms ready.

- During the warranty period, repairs are made under the terms of repair service.
- After the warranty period, if handset can be repaired, repairs will be made at cost. The functional parts necessary to repair the handset will be available for 4 years generally after the manufacture is discontinued. Repair may not be possible because of a shortage of repair parts even during the warranty period.

💡 Further inquiries

For more information on after-sales service, contact a nearby SoftBank Shop or [Customer Service](#).

Specifications

Handset

Item	Description
Weight	Approx. 188 g
Continuous Talk Time	(FDD-LTE) Approx. 2760 minutes
Continuous Standby Time	4G (AXGP): Approx. 460 hours 4G (FDD-LTE): Approx. 460 hours 5G (SA): Approx. 450 hours ¹
Charging Time	AC Charger (USB Type-C™ rapid charging AC Charger with USB PD-PPS capability [ZSDBAV] (SB-AC22-TCPD)): Approx. 58 minutes
Dimensions	Approx. 74 x 171 x 7.3 mm (handset opened) Approx. 74 x 88 x 15.9 mm (handset closed)

- 1 5G standby time is approximate time in 5G standalone environment.

SIM Removal Pin (Complimentary Sample)

Item	Description
Dimensions	Approx. 36.2 x 7.4 mm

Customer Service

For SoftBank handset or service information, call General Information. For repairs, call Customer Assistance.

SoftBank Customer Support

- From a SoftBank handset, dial toll free at 157
- From a landline, dial toll free at 0800-919-0157
- Business hours : Call 10:00am - 7:00pm / Chat 9:00am - 8:00pm

Smartphone Technical Support Center

- From a SoftBank handset, dial toll free at 151
- From a landline, dial toll free at 0800-1700-151
- Business hours : Mon. - Fri. 9:00am - 7:00pm / Sat., Sun., and Holiday 9:00am - 5:00pm / 9:00am - 8:00pm (for general information)

Safety Precautions



Safety Precautions.....	98
Material List.....	106
Important Product Information.....	107
Bluetooth®/Wi-Fi (WLAN).....	109
Cautions on Water Resistance.....	110
Intellectual Property Rights.....	112
RF Exposure Information of This Product.....	114

Safety Precautions

Read safety precautions before using handset.
Observe precautions to avoid injury to self or others, or damage to property.







Safety Precautions

These labels indicate the degree of risk from improper use. Make sure you thoroughly understand their meanings before reading on.

Mark	Descriptions
 DANGER	Great risk of death or serious injury ¹ from improper use
 WARNING	Risk of death or serious injury ¹ from improper use
 CAUTION	Risk of minor injury ² or damage to property ³ from improper use

- 1 Serious injury includes: Loss of eyesight, physical injury, high temperature burns, low temperature burns, electric shock, fractures, poisoning and other conditions having side effects or requiring hospitalization or long term treatment.
- 2 Minor injury includes: Physical injury, high temperature burns, low temperature burns, electric shock, and other conditions not requiring hospitalization or long-term treatment.
- 3 Damage to property includes: Incidental damage to structures and household property and/or to pets and livestock.

These symbols indicate prohibited or compulsory actions. Make sure you thoroughly understand their meanings before reading on.

Mark	Descriptions
 Prohibited	Prohibited actions
 Do Not Disassemble	Disassembly prohibited
 Avoid Liquids Or Moisture	Exposure to liquids prohibited
 Do Not Use Wet Hands	Use with wet hands prohibited
 Compulsory	Compulsory actions
 Disconnect Power Source	Unplug AC Charger from outlet

Handset, AC Charger (Optional Accessory), Wireless Charger (Commercially Available), USIM Card, SIM Removal Pin (Complimentary Sample), (Common)

DANGER



Do not use, store, leave in a high temperature or heat accumulating place (e.g. near fire or heater appliances, under kotatsu or bedding, in direct sunlight, inside a sun-heated car, etc.)

May cause fire, burns, injury, electric shock, etc.



Do not put in or place nearby cooking appliances such as a microwave oven, or IH cooking heater, or high-pressure container such as pressure cooker.

May cause fire, burns, injury, electric shock, etc.



Do not allow liquids such as water (beverage, sweat, sea water, pet urine, etc.) to enter into External Device Port or do not let it get wet. Do not charge where handset can come in contact with water, such as a bath room or near a humidifier.

May cause fire, burns, injury, electric shock, etc.

For water resistance, see "[Cautions on Water Resistance](#)."



Do not subject handset to excessive force or break it. Especially when carrying it in your pocket, do not hit it or press it between other objects.

Internal Battery breakage may cause fire, burns, injury, etc.

* Take additional care in instances such as the following:

- Sitting or squatting with the product in your pants or skirt pocket
- The product becoming caught in a sliding door or vehicle door when in a jacket pocket
- Stepping on the product when it is on something soft such as a sofa, bed, or futon or on the floor
- Getting the product caught in the seat on a train or bus



Do not disassemble, modify, or solder.

May cause fire, burns, injury, electric shock, etc.



Prohibited

Do not try to remove Internal Battery.

May cause fire, burns, injury, etc.



Prohibited

Back Cover on handset is not removable. Do not try to remove. Also do not try to remove Back Cover or try to press it in if handset is bulging, such as if Internal Battery is swollen.

May cause fire, burns, injury, etc.



Compulsory

Use optional accessories specified by SoftBank.

Using unspecified accessories or those of unknown manufacture, origin, or specification may cause fire, burns, injury, electric shock, etc.

WARNING



Prohibited

Do not drop, stomp, throw, or otherwise subject to strong force, impact, or vibration.

May cause fire, burns, injury, electric shock, etc.



Prohibited

Do not allow anything conductive (metal, pencil lead, etc.) to come in contact with Charging Terminals, USB Type-C Port, or dust or sand to enter equipment.

May cause fire, burns, injury, electric shock, etc.

Avoid Liquids
Or Moisture

When cleaning handset, do not allow water to enter into gaps, Charging Terminals, External Device Port, Mic, or Speaker.

Handset breakage may cause injury, electric shock, etc.



Prohibited

Do not adhere anything metal (stickers containing metal material, strap, clip, etc.) to a wireless charger (commercially available) or handset, or do not put it between a wireless charger (commercially available) and handset.

May cause fire, burns, injury, etc.



Compulsory

Remove any covers from handset before charging with a wireless charger (commercially available).

Cover material/thickness or any dirt lodged between handset and the cover may prevent handset from charging properly, and may result in fire, burns, injury, etc.



Compulsory

Power off handset near electronic devices that use precision control or faint signals.

Radio waves may cause electronic devices to malfunction or may adversely affect the operation.

* Take additional care near these devices:

Hearing aids, implanted pacemakers, implanted defibrillators, other electronic medical equipment, and other automatically controlled devices or equipment. For users of implanted pacemakers, implanted defibrillators, other electronic medical equipment, check with the equipment vendor or distributor for information about the effects of radio waves.



Compulsory

Stop charging if not complete when the prescribed charging time has passed.

Overcharge may occur resulting in fire, burns, injury, etc.



Compulsory

Always turn off handset before entering a place where flammable gas may be present, or a place where dusts are generated. Stop charging handset if charging it.

Ignition of flammable gas may cause explosion, fire, etc.



Compulsory

Follow the instructions of a gas station or other such location before using handset there.

Do not charge handset at a gas station, etc.

Take care not to drop handset at a gas station, etc.; in particular, do not use handset while filling.

Ignition of flammable gas may cause explosion, fire, etc.



Compulsory

Take the following actions, exercising caution, in case of abnormal smell, noise, smoke, heat generation, discoloring or deformation while using, charging, or storing.

-Disconnect the power plug from an outlet

-Power off handset

Continued use may cause fire, burns, injury, electric shock, etc.

CAUTION



Prohibited

Do not use damaged handsets or related accessories.

May cause fire, burns, injury, etc.



Prohibited

Do not place handset on unstable/uneven surfaces. Be extra careful while the vibrator is set.

Handset may drop and cause injury.



Prohibited

Do not use or store handset and related accessories in humid, dusty, or high-temperature places.

May cause fire, burns, electric shock, etc.

For water resistance, see "[Cautions on Water Resistance](#)."



Prohibited

Do not allow children to use handset or related accessories in the wrong way. Guardians should supervise use by children.

May cause accidental swallowing, injury, electric shock, etc.



Prohibited

Do not place handset and related accessories within an infant's reach or where pets have access to them.

In particular, take care with where small parts are stored, such as SIM Card Tray and SIM Removal Pin (complimentary sample).

May cause accidental swallowing, injury, electric shock, etc.



Compulsory

Handset temperature may become high when used continuously or while charging. Avoid continued contact with handset for a long time involuntarily such as by placing handset in clothes pocket, falling asleep, etc.

Handset or AC Charger (optional accessory) may become hot after continued use of applications, call functions, data communication, video viewing functions, etc. or while charging. Continued contact with a high-temperature area may cause redness, itching, rash of skin, or low-temperature burns depending on the user's physical condition.

Handset

⚠ DANGER

Prohibited

Do not throw handset into a fire or apply heat.

May cause fire, burns, injury, etc.



Prohibited

Do not penetrate with a sharp object (nail), hit with a hard objects (hammer), stomp, or otherwise subject handset to strong force.

May cause fire, burns, injury, etc.



Compulsory

If the internal substance of handset gets into your eyes, mouth, etc., immediately rinse with clean water and consult a doctor.

May cause loss of sight, medical problem, etc.

⚠ WARNING

Prohibited

Do not shine LED Flash or photograph with it flashing close to someone's eyes. In particular, keep away from infants.

May harm eyesight. Flash/Photo Light may impair vision or frighten others causing accidents such as injury.



Prohibited

Do not look at a repeatedly blinking screen for a long time.

May cause twitches, loss of consciousness, etc.



Prohibited

Do not allow liquids such as water (drinking water, sweat, sea water, urine of pets, etc.) or foreign objects (anything metal such as cutter blades or staples, anything flammable, etc.) in SIM Card Tray Slot.

Do not insert USIM Card in the wrong position or orientation.

May cause fire, burns, injury, electric shock, etc.



Prohibited

Do not expose the camera lens to direct sunlight, etc. for a long time.

May cause fire, burns, injury, etc. due to light-condensing of lens.



Prohibited

Do not look into Proximity/Environmental Light Sensor.

May affect eyesight or lead to an accident.



Compulsory

Power off handset or set to Airplane mode before boarding an aircraft.

Use of handset on board an airline is restricted. Follow the airline's instructions.

Handset radio waves may affect electronic devices of the aircraft.

Prohibited use aboard an aircraft may be subject to penalty by law.



Compulsory

For use in hospitals, follow the medical facility's instructions.

Power off handset in a place where its use is prohibited. Handset radio waves may affect electronic devices or other electronic medical equipment.



Compulsory

Always keep handset away from your ear when calling hands free, ringing loudly for incoming calls, or during standby.

Adjust the sound volume adequately when playing games or playing back videos or music with an earphone/microphone, etc. connected to handset.

Handset sound is loud when calling hands free. Even in standby, the ringtone or alarm may ring suddenly. Listening to loud sound continuously for a long time may cause hearing impairment or other difficulty. Too loud volume may cause inability to hear ambient sound and may also cause an accident.



Compulsory

Users with heart conditions should adjust vibration and ringtone volume as needed.

Handset suddenly vibrating and ringing for a new call may startle and affect persons with heart conditions.



Compulsory

When using electric medical equipment, etc., check with the equipment vendor or distributor for information about the effects of radio waves.

Handset radio waves may affect electronic medical equipment.



Compulsory

If Display or Camera lens is broken, do not touch the broken components or exposed inside of handset.

Touching the broken or exposed part may cause burns, injury, electric shock, etc.



Compulsory

If Internal Battery leaks or has an unusual smell, immediately stop using, and keep away from fire.

The leaked fluid may catch on fire causing ignition, explosion, etc.



Compulsory

Do not allow a pet, etc. to bite handset.

Internal Battery may ignite, explode, overheat, or leak causing fire, burns, injury, etc.

CAUTION



Prohibited

When using the motion sensor, ensure the safety of the surroundings and hold handset firmly, not swinging around more than necessary.

Failure to do so may cause accidents such as injury.



Prohibited

If Display is broken, do not allow the leaked internal substance to contact the skin of your face or hands, or clothes.

May cause injury to eyes, skin, etc.

If the internal substance gets into your eyes, mouth, etc., or contacts your skin or clothes, immediately rinse with clean water.

Also, in case it gets into your eyes, mouth, etc., immediately consult a doctor after rinsing.



Prohibited

Do not dispose handset together with ordinary trash.

May cause fire, burns, injury, etc. Also, may cause environmental destruction. Bring unnecessary handset into a sales outlet such as a SoftBank Shop or follow the municipality instructions for recycling.



Prohibited

If the internal fluid is leaked from Internal Battery, do not allow it to contact the skin of your face or hands, or clothes.

May cause injury to eyes, skin, etc.

If the internal substance gets into your eyes, mouth, etc., or contacts your skin or clothes, immediately rinse with clean water.

Also, in case it gets into your eyes, mouth, etc., immediately consult a doctor after rinsing.



Compulsory

When removing USIM Card, be careful not to scratch yourself (fingers, etc.) with point of SIM Removal Pin (complimentary sample).

Contact with point of SIM Removal Pin (complimentary sample) may cause injury, etc.



Compulsory

Before using handset in a car, check with the car manufacturer or dealer for information about the effects of radio waves.

Handset radio waves may affect the vehicle's electronic equipment in some car models. In that case, stop using handset immediately.



Compulsory

If skin abnormalities develop during use, immediately stop using handset and consult a doctor.

Continuing its use may cause itching, rashes, eczema, or other symptoms depending on the user's physical condition. For the material of each part, see "[Material List](#)."



Compulsory

Be careful not to pinch yourself (fingers, etc.) when opening or closing handset.

Being pinched in the gap may cause injury, etc.



Compulsory

Earpiece/Speaker, Speaker, and Vibrator use magnetic parts; check that nothing metal (cutter blades, staples, etc.) is adhering.

Adhered objects may cause injury, etc.



Compulsory

Watch Display in a well-lit place with enough distance kept.

Watching in a dark place or getting too close to Display may reduce visual acuity, etc.

AC Charger (Optional Accessory),
Wireless Charger (Commercially
Available)

WARNING



Prohibited

Do not use AC Charger (Optional Accessory) or wireless charger (commercially available) if the cord is damaged.

May cause fire, burns, electric shock, etc.



Prohibited

If thunder is audible, do not touch AC Charger (Optional Accessory) or wireless charger (commercially available).

May cause electric shock, etc.



Prohibited

Do not short circuit Charging Terminals when it is connected to a power outlet. Also, do not allow body parts such as your hands or fingers to contact Charging Terminals.

May cause fire, burns, electric shock, etc.



Prohibited

Do not put heavy objects on AC Charger (Optional Accessory) or wireless charger (commercially available) or pull it strongly.

May cause fire, burns, electric shock, etc.



Prohibited

When plugging or unplugging AC Charger (Optional Accessory) to or from a power outlet, do not allow metals to come in contact.

May cause fire, burns, electric shock, etc.



Prohibited

Do not use a voltage converter (such as a travel converter for overseas use) when charging with AC Charger (Optional Accessory).

May ignite, overheat, cause electric shock, etc.



Prohibited

Do not apply unnecessary force to the connection part when handset and AC Charger (Optional Accessory) are connected.

May cause fire, burns, injury, electric shock, etc.



Prohibited

Do not charge anything that is wet with liquids such as water (drinking water, sweat, sea water, urine of pets, etc.) using a wireless charger (commercially available).

Do not charge where exposed to water (bath room, near a humidifier, etc.).

May cause fire, burns, injury, electric shock, etc.



Do Not Use Wet Hands

Do not touch the cord of AC Charger (Optional Accessory), Charging Terminals, power plug, or wireless charger (commercially available) with wet hands.

May cause fire, burns, electric shock, etc.



Compulsory

Use with specified power supply and voltage.

Also, use AC Charger for overseas use when charging abroad.

Using the incorrect power supply and voltage may cause fire, burns, electric shock, etc.

AC Charger (Optional Accessory): 100 V AC (Household AC power outlet only)

AC Charger for overseas use: 100 V to 240 V AC (household AC power outlet only)



Compulsory

Wipe off dust on the power plug.

Using with dust adhered may cause fire, burns, electric shock, etc.



Compulsory

Insert AC Charger (Optional Accessory) in outlet firmly.

Failure to do so may cause fire, burns, electric shock, etc.



Compulsory

When unplugging from an outlet, grasp AC Charger (Optional Accessory) plug and do not pull cord or otherwise subject to excessive force.

The cord of USB cable (complimentary sample) may be damaged if it is pulled out and it may cause fire, burns, electric shock, etc.



Compulsory

Persons with an implanted pacemaker, defibrillator, or other electronic medical equipment should consult carefully with a doctor before using a wireless charger (commercially available).

Handset radio waves may affect electronic medical equipment.



Compulsory

Insert or remove the plug of AC Charger (Optional Accessory) straight against the port without applying force such as pulling the cord.

Incorrect insertion or removal may cause fire, burns, injury, electric shock, etc.



Compulsory

Stop using handset immediately if Charging Terminals are deformed or bent. Or, do not use AC Charger even with the deformation fixed.

Charging Terminals may short-circuit causing fire, burns, injury, electric shock, etc.



Disconnect Power Source

Unplug power plug of AC Charger (Optional Accessory) when not using it.

Keeping the power plug connected may cause fire, burns, electric shock, etc.



Disconnect Power Source

If liquid such as water (drinking water, sweat, seawater, urine of pets, etc.) gets on equipment, immediately disconnect the power plug from an outlet.

Liquid on equipment may result in short-circuit causing fire, burns, electric shock, etc.



Disconnect Power Source

When cleaning, disconnect the power plug from an outlet.

Failure to do so may cause fire, burns, electric shock, etc.

CAUTION



Prohibited

Do not touch AC Charger (Optional Accessory) that is connected to an outlet continuously.

May cause burns, etc.

USIM Card

CAUTION



Compulsory

When handling USIM Cards, be careful of the cut surface so as not to hurt your body parts such as fingers.

Cut surface may be sharp and may cause injury, etc.

SIM Removal Pin (Complimentary Sample)

WARNING



Prohibited

Tip of SIM Removal Pin (complimentary sample) is pointed. Do not use pointed at yourself or others.

May allow it to strike yourself or others, causing injuries or loss of sight.

CAUTION



Prohibited

Do not place within reach of infants.

They may swallow it or choke, or may cause injury, etc.

Handling near Electronic Medical Equipment

WARNING



Compulsory

If you have an electric medical device such as an implanted pacemaker or implanted cardioverter defibrillator, or if there may be someone with such a device around you, keep handset at least 15 cm away from the device.

Handset radio waves may affect the electric medical device. Switch handset not to emit radio waves (power handset off, etc.) beforehand when people around you may come closer than 15 cm to you where you cannot move freely.



Compulsory

When using electronic medical equipment (other than implanted pacemakers/defibrillators) outside medical facilities, check with the equipment vendor or distributor for information about the effects of radio waves.

Handset radio waves may affect electronic medical equipment.



Compulsory

Observe each medical facility's instruction when using handset.

Handset radio waves may affect electronic medical equipment.

Material List

motorola razr 50s Main Unit

Part	Material/Surface Treatment
Display, Screen Protector	PET/hard coating
External Display	Strengthened glass/AF coating
Cling (Paper Protective Sheet)	Pulp paper/anti-scratch treatment
Middle Frame (Outer Frame), Hinge Cover, SIM Card Tray (Exterior), Volume Key (Up/Down)	Aluminum/sand blasting + anodizing
Front Housing	PC + 9% GF/luster coating
Back Cover (Koala Grey)	GF + silicone leather + elastic polymer/pressing
Back Cover (Sand Cream/Spritz Orange)	GF + silicone leather/pressing
Motorola Logo	PET + PC/matte processing
razr Logo	PC/NCVM
Slit	PBT + 40% GF/-
Silicone belt	TPEE/matte processing
Hinge	Stainless steel/sand blasting + PVD coating
Camera Lens	Strengthened glass/AR coating + AF coating
Camera Ornament	Stainless steel/double layer PVD coating
LED Flash	PMMA/-
Power Key/Fingerprint Sensor	EMC/matte coating
SIM Card Tray (Frame)	Polyamide/-
SIM Card Tray (Seal)	Liquid silicone rubber/-
IMEI Label (on SIM Tray)	PET/laminating

SIM Removal Pin (Complimentary Sample)

Part	Material/Surface Treatment
SIM Removal Pin	Stainless steel/-

Important Product Information

Handset, AC Charger (Optional Accessory), USIM Card, SIM Removal Pin (Complimentary Sample), (Common)

- A screen protector is adhered to Display. Removing this screen protector or adhering an other-brand protective film, etc. will void the warranty.
- Do not expose to water.
AC Charger (Optional Accessory) is not waterproof. Avoid using in humid places such as a bathroom and exposing it to rain. Contact to dampness from sweat by wearing on your body may cause corrosion inside resulting in malfunction. If malfunction is determined to be caused by above water exposures, warranty will not apply to repair. In the case that repair is possible, repair charge is incurred.
- Do not fold handset in reverse. May damage handset.
- Avoid using handset in extremely high or low temperatures or in high humidity. Always use within temperatures of -20°C to 60°C and humidity of 0% to 85%.
- Do not use in these locations.
 - Where there is much humidity, dust, or vibration
 - Near a landline phone, TV, radio, etc.
- Note that handset temperature may become high when used for a long time, especially in high-temperature conditions.
- Discontinue using handset temporarily if its temperature becomes high. Prolonged contact with handset when at a temperature may cause low-temperature burns.
- Avoid touching handset USB Type-C Port. Static electricity may affect internal components.
- Use a soft, dry cloth to clean any oil, splashing, or other hard-to-remove soiling. Do not operate with fingernails to prevent scratching Display. Wiping with alcohol, thinner, benzene, detergent, etc. may remove print or fade colors.
- Occasionally clean terminals with a dry, cotton swab etc. Dirt on terminals may cause power shut-off or insufficient charging. Take care not to damage terminals when cleaning.
- Avoid removing USIM Card when saving or transmitting data with handset. May erase data or affect handset.
- A flashing screen while playing games or watching videos may cause dizziness or convulsions. If you experience these symptoms, consult a doctor.
- Do not place handset near magnetic objects such as magnetic stripe cards. Information saved on memory cards and credit cards may be corrupted by handset's magnetic field.
- Handset uses metal components. A user may experience itching, a rash, skin irritation, or other symptoms depending on their physical condition and health.
- Do not paint handset. Coating may penetrate handset and cause malfunction.

Internal Battery

- Battery is built in and is not removable.
- Internal Battery is capable of charging and discharging at least several hundred times, but will ultimately wear out. Internal Battery needs to be replaced if operating time shortens noticeably. Replace Internal Battery.
- Internal Battery replacement incurs fees and requires handset submission to a SoftBank Shop. Contact a SoftBank Shop or [Customer Service](#). Do not use replace by yourself; may cause fire, explosion, etc.
- Battery is depleted faster when communication functions such as Bluetooth® and Wi-Fi® are enabled. It is recommended that you disable these functions when not in use.
- Battery is depleted faster when Display is at a bright setting. Use "Brightness level" to set a lower brightness and save battery power.

Lithium-Ion Battery

Handset uses a lithium-ion battery. Lithium-ion batteries are recyclable precious resources. Bring them to the nearest shop with the Mobile Recycle Network mark.



Li-ion 00

Charging

- Always use the optional AC Charger (USB Type-C™ rapid charging AC Charger with USB PD-PPS capability [ZSDBAV] (SB-AC22-TCPD)). Using other charging equipment may cause Internal Battery leakage, overheating, or fire. SoftBank Corp. is not responsible for damages whatsoever from accidents or problems arising from use of other charging equipment.
- Do not force handset and AC Charger (Optional Accessory) to connect if it is difficult to connect them.
- When plugging in AC Charger (Optional Accessory), do not allow anything that conducts electricity (anything metal, pencil lead, etc.) to come in contact with plug. May cause electric shock, short-circuiting, fire, etc.
- Connect AC Charger (Optional Accessory) directly into an outlet. Connection to a power bar may cause overheating and cause a fire.
- Do not subject AC Charger (Optional Accessory) to strong impact such as by tripping on it when connected to an outlet. May cause injury or malfunction.
- Do not use AC Charger (Optional Accessory) if plug is damaged or does not plug firmly into an outlet.
- Do not charge in these locations.
 - In direct sunlight
 - Where there is much humidity, dust, or vibration
 - Near a TV, radio, or other electric device

To Ensure Safe Driving

- Using handset while driving risks safety. Follow laws and regulations of countries and regions where using handset. Before using handset, stop vehicle in a safe place.
- Do not store handset or supplied accessories in the same place as liquids or flammable gas. Do not place handset above where an airbag is located. May hinder an airbag when deployed.
- Accuracy of compass can be affected by electromagnetic waves, surroundings, or other magnetic objects. Compass should only be used as a reference.
- If you do not wish location information to be made known, do not use applications that record location information.
- Only viewed map should not be relied on, and should only be used as a reference when searching for places, buildings, directions, and distances. Maps, directions, and places are as provided by service providers and are always subject to change. This type of function is not supported in some locations; map routes and compass may be inaccurate, incomplete, or unsupported.

Operating System

- Power off handset in a place where its use is prohibited or where there may be interference or risk of danger.
- Radio wave interference may cause malfunctioning or other trouble in electronic devices.
- In rare cases, using handset in some vehicles will affect the vehicle's electronic devices. Do not use handset in such cases as a safety precaution.
- Before connecting handset or supplied accessories to any other devices, read instructions included with the devices and ensure safety information is understood.
- Do not connect handset to non-compatible products.
- Using handset while walking risks safety. Avoid walking and using handset.

Emergency Alerts

- When an emergency alert is received, handset notifies user via message, alert, and by vibrating.
 - Emergency alerts are enabled by default (can also be disabled).
 - By default, alert sounds at maximum volume even when Do Not Disturb is set, and vibration is enabled regardless of Do Not Disturb setting (can be changed).
- Emergency alerts are not received during calls, during data transmissions, or when signal is weak.
 - * Can be received during a voice call using VoLTE.
- Depending on usage/situation, handset may receive emergency alerts for other areas or no emergency alerts.
- SoftBank Corp. is not responsible for damages caused by using this service, including accidents resulting from received information, reception timing, or reception/reception failure.

Display (Touchscreen)

- Touchscreen-type display, operate with your fingers on Display.
- Display is designed to be contacted lightly by your fingers. Do not press strongly with your fingers or with anything pointed (fingernails, ballpen, pin, etc.).
- Do not use a stylus pen.
- Display may not respond to touch operation in these situations. Note that malfunction may occur.
 - Operation with gloves on
 - Operation with fingernail
 - Foreign object on Display
 - Operation with water drops or condensation on Display
 - Operation with fingers wet or sweaty
 - Operation under water
- Do not allow a foreign object (card, coin, key, etc.) to become caught when closing handset. May damage Display.
- Do not place excessive pressure on Display where it bends, or pick up handset holding edge of where Display bends. May scratch Display.
- Use both hands to open handset. Using only one hand to open handset may scratch Display.
- Always close handset before carrying it in a bag. Carrying it in a bag while open may allow Display to become scratched or damaged.
- Immediately discontinue using handset if handset Display is broken. Avoid touching or removing broken parts, and immediately contact a SoftBank Shop or [Customer Service](#).
- Immediately wipe away any liquid, metallic dust, or other matter which Display may have come in contact with.

Volume

- Do not listen for a prolonged period at high volume; may hurt ears.



SIM Removal Pin (Complimentary Sample)

- Do not insert SIM Removal Pin (complimentary sample) in hole other than hole in SIM Card Tray. May cause malfunction or damage.
- Do not apply excessive force. May cause malfunction or damage.
- Follow local rules regarding collection when disposing.
- Do not use SIM Removal Pin (complimentary sample) in other mobile terminals. May cause malfunction or damage to mobile terminal.

Personal Information and Data Security

- Use of some handset functions and third-party applications may cause leakage of personal information, loss of data, or allow access by a third party. SoftBank Corp. recommends taking preventative steps to protect personal and confidential information.
- Keep handset in a safe place where it cannot be used inappropriately.
- It is recommended that you set a screen lock on handset that requires a password, Face Unlock, fingerprint authentication, etc.
- Back up personal information to handset, etc. regularly. When changing to a different mobile terminal, always transfer or delete personal information from handset.
- Receiving unfamiliar messages or email may be sources of viruses. Do not open them, and simply delete them.
- When using handset to browse the Internet, do not access websites that are a security risk to prevent personal information from being stolen.
- Set a password for Wi-Fi tethering to prevent inappropriate access. Disable when not in use.
- Handset initiates system updates regularly to enhance security. To maintain handset security, always use the latest software. It is also recommended that you perform a regular virus scan.
- Always obtain third-party applications from official venues. Scan for viruses when downloading applications.
- Some applications request sending of location information, and share location information with the creators of the application. In such instances, handset, searched information, and diagnostic information may be sent to third-party application providers. Third-party vendors use this information to improve products and services.

Technical Conformity

- Handset conforms to technical regulations pursuant to the Radio Law as a wireless radio station facility of a low-power data transmission system, and the mark of technical conformity can be viewed as follows:
 Flick Home Screen up → (Settings) → About phone → Legal & regulatory → Regulatory labels
- Handset conforms to technical regulations, and its disassembly/modification may be punishable under law.

Bluetooth®/Wi-Fi (WLAN)

Connection/operation may not be possible with some Bluetooth®/Wi-Fi (wireless LAN) devices. Handset Bluetooth®/Wi-Fi (wireless LAN) communication is secured in conformity with Bluetooth®/Wi-Fi (wireless LAN) standards, however, security may be insufficient depending on system environment and settings. Be aware of this when using Bluetooth®/Wi-Fi (wireless LAN) communication. SoftBank Corp. is not responsible for damages from leakage of data or information occurring using Bluetooth®/Wi-Fi (wireless LAN) communication.

Frequency Bands (2.4 GHz Band)

Frequency band used by handset Bluetooth®/Wi-Fi (WLAN) functions are as follows:



- 2.4: Frequency band is 2400 MHz
- FH/XX/DS/OF: Modulations are FH-SS, other modulation, DS-SS, OFDM
- 4: Estimated range of radio frequency interference is up to 40 m
- 8: Estimated range of radio frequency interference is up to 80 m
- ■ ■ : Utilizes 2,400 MHz to 2,483.5 MHz band without mobile device bandwidth differentiation

- Available channels may vary by country.
- For use in an airplane, contact your airline.

Frequency Bands (5 GHz Band)

In 5 GHz frequency bandwidth, handset can use 5.2 GHz (W52), 5.3 GHz (W53), and 5.6 GHz (W56) bands.

- 5.2 GHz band (W52/36, 40, 44, 48 ch)
- 5.3 GHz band (W53/52, 56, 60, 64 ch)
- 5.6 GHz band (W56/100, 104, 108, 112, 116, 120, 124, 128, 132, 136, 140, 144 ch)

Using a 5.2/5.3-GHz-band wireless LAN outdoors is prohibited by law (this does not apply to communication with access points/relay stations of high-output data communications systems operating in the 5.2 GHz band).

Frequency Bands (6 GHz Band)

Within the 6 GHz frequency band, handset can use the 5925 to 6425 MHz band. Handset's 6 GHz device power class is LPI (Low Power Indoor). Using a 6-GHz-band (LPI) wireless LAN outdoors is prohibited by law.

Cautions for General Use

The frequency band used by handset Bluetooth®/Wi-Fi (wireless LAN) functions is also used for operation by household appliances (microwave ovens) and industrial/scientific/medical equipment as well as by in-place radio stations (requiring a license) and specific low-power radio stations (not requiring a license) for mobile identification as used in production lines, and by amateur radio stations (requiring a license).

1. Before using Bluetooth®/Wi-Fi (wireless LAN), check that no in-place radio stations for mobile identification, specific low-power radio stations, or amateur radio stations are in operation nearby.
2. If use of handset Bluetooth®/Wi-Fi (wireless LAN) causes interference with regard to an in-place radio stations for mobile identification, immediately change the usage frequency, or discontinue use and take measures to avoid interference (putting a partition in place, etc.).
3. If handset is otherwise a cause of interference with regard to specific low-power radio stations for mobile identification or amateur radio stations and assistance is required, contact [Customer Service](#).

Bluetooth® and Wi-Fi (Wireless LAN)-Compatible Devices and Interference

Bluetooth® and Wi-Fi (IEEE 802.11 b/g/n/ax) use the same frequency band (2.4 GHz). Using Bluetooth® near a Wi-Fi (wireless LAN) access point or device may cause interference and affect communication speed connection. If this occurs, either distance handset and the device connecting by Bluetooth®, or turn off the Wi-Fi (wireless LAN) device so as to prevent interference.

Wi-Fi (Wireless LAN)

Do not use where there are devices with magnetic fields (electrical products, AV/OA equipment, etc.) or where there is an electromagnetic field.

- The effect of magnetism and electrical noise may cause increased noise and prevent communication. Handset may in particular be affected by a microwave oven.
- Proximity to a TV, radio, etc. can block reception and cause a snowy TV screen.
- If multiple Wi-Fi (wireless LAN) access points using the same channel are in proximity, handset may not detect access points correctly.

Cautions on Water Resistance

Handset has IPX8* water protection with SIM Card Tray closed firmly.

* IPX8 indicates that handset functions as a phone after being slowly immersed in still tap water of room temperature to a depth of 1.5 m, and left there for approximately 30 minutes before being removed again.

What You Can Do with Waterproofness of Handset

- Use handset to talk without using an umbrella in the rain (with a rainfall of about 20 mm per hour).
- Wash handset by shaking it gently with tap water in a basin at room temperature (5°C to 35°C).
 - Hold SIM Card Tray so as not to open and wash handset by hand without using a brush, sponge, soap, or detergent, etc.
 - After washing handset, wipe both surfaces with a dry cloth and drain it.
- Use handset at a poolside. However, avoid handset being exposed to water or immerse it in pool water.

To Maintain Water Resistance

Always check the following to maintain water resistance.

- Insert SIM Card Tray securely. Any debris (single hair, grain of sand, minute fiber, etc.) trapped between contacting surfaces may allow ingress of water.
- Avoid poking Mic, Earpiece/Speaker, Speaker, USB Type-C Port, SIM Card Tray, or Vent Hole (for pressure adjustment) with anything pointed.
- Do not let handset fall. Scratches, etc. can deteriorate water resistance.
- SIM and Card Tray gasket is crucial for continued handset water resistance. Do not peel away or damage gasket. Also, prevent dust from adhering onto them.



Parts Replacement

To maintain water resistance, it is recommended to replace parts every 2 years regardless of their condition. Handset can be submitted for parts replacement at a fee. Contact [Customer Service](#) or a nearby SoftBank Shop.

Usage Cautions

- Do not expose or immerse handset to the following types of liquid.
 - Water containing soap, detergent, or bath salt
 - Seawater or pool water
 - Hot spring or hot water, etc.
- Do not immerse handset in hot water, use it in a sauna, or do not subject to hot airflow such as from a hair dryer.
- Do not leave wet. May short-circuit USB Type-C Port. In a cold region, handset may freeze and result in malfunction.
- To prevent condensation, let handset adjust to room temperature before bringing it from a cold location to a warm location.
- Do not use handset underwater.
- Never charge handset while it is wet.
- Do not use a washing machine to wash handset.
- Handset does not float on water.
- Do not place directly on sand, etc.
 - Sand entering hinge may make handset harder to open and close, or cause unusual noise.
 - Sand may enter Mic, Earpiece/Speaker, Speaker, USB Type-C Port, Vent Hole (for pressure adjustment), etc. and affect sound.
 - Sand may enter holes in USB Type-C Port, etc. and affect water resistance.
 - Allowing moisture, sand, etc. to remain may cause sound to crackle.
- Do not allow moisture to remain in Mic, Earpiece/Speaker, Speaker, USB Type-C Port, Vent Hole (for pressure adjustment), etc. May affect call quality.
- Included accessories and optional accessories are not water resistant.
- Operation is not guaranteed for all conditions of actual use. Handset will not be covered by warranty if malfunction is determined to be due to incorrect customer handling.

Draining

If handset is wet with water, unwiped water may leak from handset. Follow the procedures below to drain handset.

1

Hold handset securely, and wipe off water on both surfaces with a dry and clean cloth, etc.

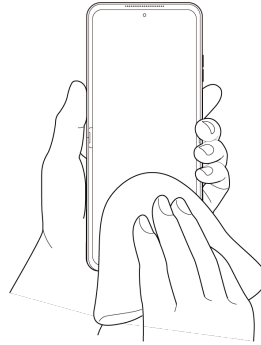

2

Hold handset securely, and shake it about 20 times until there is no more wetting (shake handset with both surfaces facing forward)

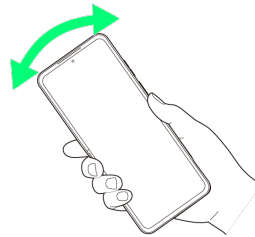

- Visually confirm that there is no waterdrop on handset.

3

Press a dry and clean cloth, etc. on handset by shaking it about 10 times to securely wipe off water remaining in gaps of Mic, Earpiece/Speaker, Speaker, USB Type-C Port, Vent Hole (for pressure adjustment), etc.

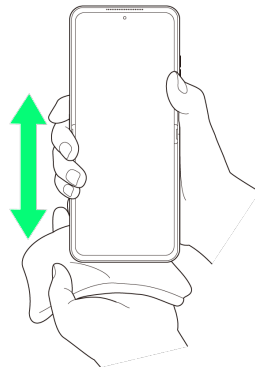

- Do not wipe off water remaining in gaps directly with a cotton swab, etc.

Wipe off water drained from handset with a dry and clean cloth, etc. thoroughly and leave handset at room temperature for a while to dry it

- If any waterdrops remain inside handset, water may be drained.

When Charging

Check the following before and after charging.

- Make sure handset is not wet. Never charge while it is wet. etc.
- Do not touch AC Charger (Optional Accessory) with wet hands. May cause electric shock.
- Do not use AC Charger (Optional Accessory) near water sources (bathroom/shower, sinks/basins, etc.). May cause fire or electric shock.

Intellectual Property Rights

Copyrights and Portrait Rights

Copyrighted contents you recorded or obtained from Websites pages using this product by downloading or other means, such as documents, images, music data, software, are prohibited from reproduction, transformation and transmission over public lines without consent of the copyright holders, unless intended for personal use or any other purpose permitted by law.

Note that some performances, shows, and exhibitions may not permit photography, movie shooting, or sound recording even for personal use.

You should also refrain from taking a picture of other people and disclosing it by such means as posting it on a Website without their consent because of possible infringement of their right of portrait.

Trademarks

The names of the companies and products used in this guide are trademarks or registered trademarks of the respective companies.



The TM and ® marks are sometimes abbreviated in this instruction manual.

- SOFTBANK, SOFTBANK's equivalent in Japanese and the SOFTBANK logo are trademarks or registered trademarks of SOFTBANK GROUP CORP. in Japan and other countries.
- Yahoo!, ヤフー, the Yahoo! JAPAN logo, and the Y! logo are registered trademarks or trademarks of LY Corporation in Japan.
- LINE MUSIC is a trademark or registered trademark of LY Corporation.
- Bluetooth® is a registered trademark of Bluetooth SIG, Inc., and is used under license to Motorola Mobility LLC.



- Wi-Fi® and Wi-Fi Direct® are trademarks or registered trademarks of Wi-Fi Alliance.



- USB Type-C™ is a trademark of USB Implementers Forum.
- "Qi" is a trademark of Wireless Power Consortium.
- FeliCa is a contactless IC card technology developed by Sony Corporation.
- FeliCa is a registered trademark or trademark of Sony Group Corporation or its affiliates.
-  is a registered trademark of FeliCa Networks, Inc.
-  is a trademark or registered trademark of NFC Forum, Inc. in the United States and other countries.
- Fitbit is a trademark of Fitbit, Inc.
- Google, the Google logo, Android, Google Play, the Google Play logo, Gmail, the Gmail logo, Google Maps, the Google Maps logo, Google Calendar, the Google Calendar logo, YouTube, the YouTube logo, YouTube Music, the YouTube Music logo, Google Drive, the Google Drive logo, Google Photos, the Google Photos logo, Google Meet, the Google Meet logo, Google Chrome, the Google Chrome logo, Google Lens, the Google Lens logo, Google Wallet, the Google Wallet logo, Gboard, Google Home, the Google Home logo, Google TV, the Google TV logo, Google One, the Google One logo, Google Gemini, the Google Gemini logo are trademarks or registered trademarks of Google LLC.
- QR code is a registered trademark of DENSO WAVE INCORPORATED.
- Osafu-Keitai is a registered trademark of NTT DOCOMO, INC.
- Facebook and the Facebook logo are registered trademarks of Meta Platforms, Inc.
- Netflix is a registered trademark of Netflix, Inc.
- The Satofull name, logo, and service name are registered trademarks or trademarks of Satofull Co., Ltd. in Japan.
- MOTOROLA, the M logo, MOTO, and the MOTO family of marks are trademarks of Motorola Trademark Holdings, LLC.
- MediaTek and Dimensity are trademarks or registered trademarks of MediaTek Inc.

- Manufactured based on a license from Dolby Laboratories. Dolby, Dolby Atmos, ドルビー, and the double-D symbol are registered trademarks of Dolby Laboratories Licensing Corporation. Confidential unpublished work.
- Rights to all other trademarks belong to the trademark owners.
- ©2024 Motorola Mobility LLC.
- Designed and manufactured by Motorola Mobility LLC, a 100% subsidiary of Lenovo.
- RAZR® is a registered trademark of Razor USA LLC. RAZR and language including RAZR are used under license of Razor USA LLC.

RF Exposure Information of This Product

RF Exposure Information of This Product (for Japan)

This mobile phone [A403MO] complies with the Japanese technical regulations on human exposure to radio frequency (RF) electromagnetic energy.

This mobile phone is designed in observance of the Japanese technical regulations regarding human exposure to radio waves (*1). These technical regulations are consistent with the limits of human exposure to radio waves established by the International Commission on Non-Ionizing Radiation Protection (ICNIRP), which is in collaboration with the World Health Organization (WHO), and the International Committee on Electromagnetic Safety (ICES) in IEEE. The permissive limits include substantial safety margins designed to assure the safety of all persons, regardless of age and health.

The technical regulations set out limits of exposure to radio waves as the SAR (Specific Absorption Rate, for up to 6GHz) and the PD (Power Density, for above 6GHz), and the limits for the SAR and the PD for mobile phones are 2.0W/kg and 2mW/cm², respectively. If a mobile phone supports simultaneous transmission of the frequency bands which should be evaluated in the SAR and PD, the technical regulations require that the Total Exposure Ratio (TER) should be used to indicate its compliance. The TER of less than or equal to 1 indicates the mobile phone satisfies the limits.

The TER for this mobile phone when tested for use near head is 0.99, and that when worn on the body is 0.99 (*2, *3). There may be slight differences of the SAR and PD values in individual product, but they all satisfy the limits. The actual SAR and PD of this mobile phone while operating can be well below the indicated above. This is due to automatic changes in the power level of the device to ensure it only uses the minimum required to access the mobile network(s).

This mobile phone can be used at positions other than against your head. By using accessories such as a belt clip holster that maintains a 0.5 cm separation with no metal (parts) between it and the body, this mobile phone is certified the compliance with the Japanese technical regulations.

The World Health Organization has stated that "A large number of studies have been performed over the last two decades to assess whether mobile phones pose a potential health risk. To date, no adverse health effects have been established as being caused by mobile phone use."

For more information about RF exposure information, see the following websites:

Ministry of Internal Affairs and Communications (MIC)
<https://www.tele.soumu.go.jp/e/sys/ele/body/index.htm>

Association of Radio Industries and Businesses (ARIB)

<https://www.arib-emf.org/01denpa/denpa02-02.html>
 (Japanese)

World Health Organization
<https://www.who.int/news-room/fact-sheets/detail/electromagnetic-fields-and-public-health-mobile-phones>

List of Specific Absorption Rates (SAR) for radio waves
<https://www.softbank.jp/mobile/support/sar/> (Japanese)

- *1 The technical regulations are provided in the Article 14-2 of the Ministry Ordinance Regulating Radio Equipment.
- *2 Including other radio systems that can be simultaneously used with 5G/LTE.
- *3 The values of SAR and PD that the TER values are calculated are as follows: For temporal region (near ear), SAR: 1.80 W/kg, PD: 0.426 mW/cm²; For body-worn, SAR: 1.99 W/kg, PD: 0.736 mW/cm².

European RF Exposure Information

This mobile phone [A403MO] is a radio transmitter and receiver. It is designed not to exceed the limits for exposure to radio waves recommended by the international guidelines. The guidelines were developed by the International Commission on Non-Ionizing Radiation Protection (ICNIRP) and include safety margins designed to assure the protection of all persons, regardless of age and health conditions. The guidelines use a unit of measurement known as the Specific Absorption Rate, or SAR. The SAR limit for mobile phones is 2.0 W/kg. The highest SAR value for this mobile phone when tested for use near head is 1.97 W/kg, and that when worn on the body at the separation distance of 0.5 cm from the body is 1.98 W/kg (*1). For electronic safety, maintain the separation distance with accessories containing no metal, that position handset a minimum of the above distance. Use of other accessories may not ensure compliance with the guidelines.

- *1 The tests are carried out in accordance with the international guidelines for testing.

Simplified Declaration of Conformity for [A403MO]
 Hereby, Motorola Mobility LLC declares that the radio equipment type [A403MO] is in compliance with Directive 2014/53/EU. The full text of the EU declaration of conformity is available at the following internet address:
<https://www.motorola.com/red>.

FCC RF Exposure Information

This mobile phone [A403MO] is a radio transmitter and receiver. It is designed and manufactured not to exceed the emission limit for exposure to radio frequency (RF) energy required by the Federal Communications Commission (FCC). The limit is based on standards that were developed by independent scientific organizations through periodic and thorough evaluation of scientific studies. The standards include a substantial safety margin designed to assure the safety of all persons, regardless of age and health conditions. The exposure standard for mobile phones employs a unit of measurement known as the Specific Absorption Rate (SAR). The SAR limit set by the FCC is 1.6 W/kg. The tests are performed in positions and locations as required by the FCC. The highest SAR value for this handset when tested for use near the head is 1.25 W/kg, and that when worn on the body as shown below is 1.32 W/kg.

Body-worn Operation: This mobile phone was tested for typical body-worn operations with the separation distance of 0.5 cm from the body. To maintain compliance with FCC RF exposure requirements, use accessories that maintain the above separation distance between the user's body and the mobile phone. The use of belt clips, holsters and similar accessories should not contain metallic components in its assembly. The use of accessories that do not satisfy these requirements may not comply with the FCC RF exposure requirements and should be avoided.

The FCC has granted an equipment authorization for this mobile phone with all reported SAR levels evaluated as in compliance with the FCC RF exposure requirements. Filed SAR information of this mobile phone can be found by searching FCC ID IHDT56AQ8 in the FCC ID Search webpage: <https://www.fcc.gov/oet/ea/fccid>.

Additional information on SAR can be found on the FCC website at <https://www.fcc.gov/general/radio-frequency-safety-0>.

motorola razr 50s User Guide Index

A

About the User Guide.....	3
Adding Applications.....	63
Airplane Mode.....	26
Applications.....	62

B

Basic Operation.....	24
Battery Settings.....	77
Bluetooth®/Wi-Fi (WLAN).....	109

C

Capturing Still Images/Videos.....	58
Cautions on Water Resistance.....	110
Charging Battery.....	12
Connecting by Wi-Fi.....	68
Customer Service.....	95

D

Data Usage Settings.....	73
Display Settings.....	74

E

eSIM.....	7
External Display.....	36

G

Global Roaming.....	88
---------------------	----

H

Handset Screens.....	32
Handset Settings.....	72
Home & lock screen Settings.....	74

I

Important Product Information.....	107
Intellectual Property Rights.....	112

M

Making Calls while Abroad.....	89
Making Initial Settings.....	13
Material List.....	106

O

Optional Services.....	41
------------------------	----

Other Settings..... 80

P

Parts & Functions..... 6
 Phone Number..... 46
 Placing/Answering Calls..... 38
 Power On/Off..... 13

R

RF Exposure Information of This Product..... 114

S

Safety Precautions..... 98
 Security & privacy Settings..... 77
 Sending Messages (+Message)..... 50
 Setting a Google Account..... 16
 Silent Mode..... 25
 Sound & vibration Settings..... 76
 Specifications..... 94
 Status Bar..... 33
 System Settings..... 80

T

Text Entry..... 27

U

Unlocking Screen..... 20
 Updating Software..... 28
 USIM Card..... 11
 Using Bluetooth® Function..... 69
 Using Chrome..... 54
 Using Contacts..... 46
 Using Gmail..... 51
 Using Notifications Window..... 34
 Using Quick Settings..... 34
 Using Touchscreen..... 24

V

Viewing Still Images/Videos (Photos)..... 60

W

Warranty & After-Sales Service..... 94

motorola razr 50s User Guide

October 2024, First Edition

SoftBank Corp.

Visit [SoftBank Shop](#) for assistance

Model : motorola razr 50s

Importer : Motorola Mobility Japan LLC

Manufacturer : Motorola Mobility LLC